

LOCATION MAP

NOT TO SCALE

BULK TABLE		
	PROPOSED	REQUIRED
ZONING/USE - PRINCIPAL	GROUP-U: UTILITY AND MISCELLANEOUS (PRIVATE GARAGES)	I-INDUSTRIAL
PRINCIPAL BUILDING SQUARE FOOTAGE	3840SF	NA
FRONT SETBACK	75'	60'
SIDE SETBACK	51.1'	25'
REAR SETBACK	58.6'	50'
BUILDING HEIGHT	28'	48'
LOT COVERAGE	14.08%	30%

SITE NOTES:

- THE CONSTRUCTION SITE IS NOT WITHIN 100' OF A WETLAND AS DELINEATED BY NYS DEC. THERE ARE NO NYS DEC DELINEATED OR APPARENT WETLANDS ON THE PROPERTY AS SHOWN.
- THE CONSTRUCTION SITE IS NOT WITHIN A 500 YEAR FLOODPLAIN AS DELINEATED BY FEMA MAP 360598 0015C DATED MARCH 3, 1997.
- BOUNDARY LINES ARE BASED OFF SURVEY BY YEARS BOUNDARY (SEE MAP REFERENCE)
- TOTAL PROPERTY AREA: 2.13+/- ACRES. PROPERTY ZONED AS INDUSTRIAL
- NYS SPDES PERMIT IS NOT REQUIRED FOR THESE CONSTRUCTION ACTIVITIES. DISTURBANCE SHALL BE LESS THAN ONE ACRE. IF THE CONTRACTOR OR OWNER AT ANY TIME PLAN DISTURB GREATER THAN AN ACRE THE ENGINEER SHALL BE NOTIFIED.
- CONTACT HIGHWAY SUPERVISOR PRIOR TO START OF CONSTRUCTION.
- ALL EXTERIOR LIGHTING SHALL BE CUT OFF AND DARK SKY COMPLIANT.
- ELEVATION DATUM - NAVD 88, RE-SURVEYED 09/13/2017

MAP REFERENCE:

- MAP OF SURVEY PREPARED FOR JOANNE M. ALLEN SHOWING, CERTIFIED TO KEVIN MOTTLE FOR PROPERTY TRANSFER AND PROJECT PLANNING PURPOSES, SHOWING LAND AT 2580 BRICKYARD ROAD TOWN OF CANANDAIGUA, COUNTY OF ONTARIO, STATE OF NEW YORK. FILE #YB4560. OCT. 21 2015 BY YEARS BOUNDARY. JEREMY E. YEARS L.S.

LANDSCAPE NOTES:

- PLANT W/ LOW NATIVE SHRUBS LIKE CREEPING JUNIPER AND BAY BERRY AT 24" CENTERS WITH INFILL PERENNIAL FLOWERING PLANTS LIKE IRIS DAYLILIES AND TULIPS.
- APPLY LANDSCAPE FABRIC AND MAINTAIN 4" OF HARDWOOD MULCH.

LEGEND

Iron pin or pipe found	EXISTING	PROPOSED	Utility Lines
Benchmark	elec	E/T	R.O.W. line
Utility pole			Property line
Hydrant			Easement line
Light pole			Centerline
PERC TEST			Drainage
DEEP HOLE			Fence Line
			Contour Line
	99		

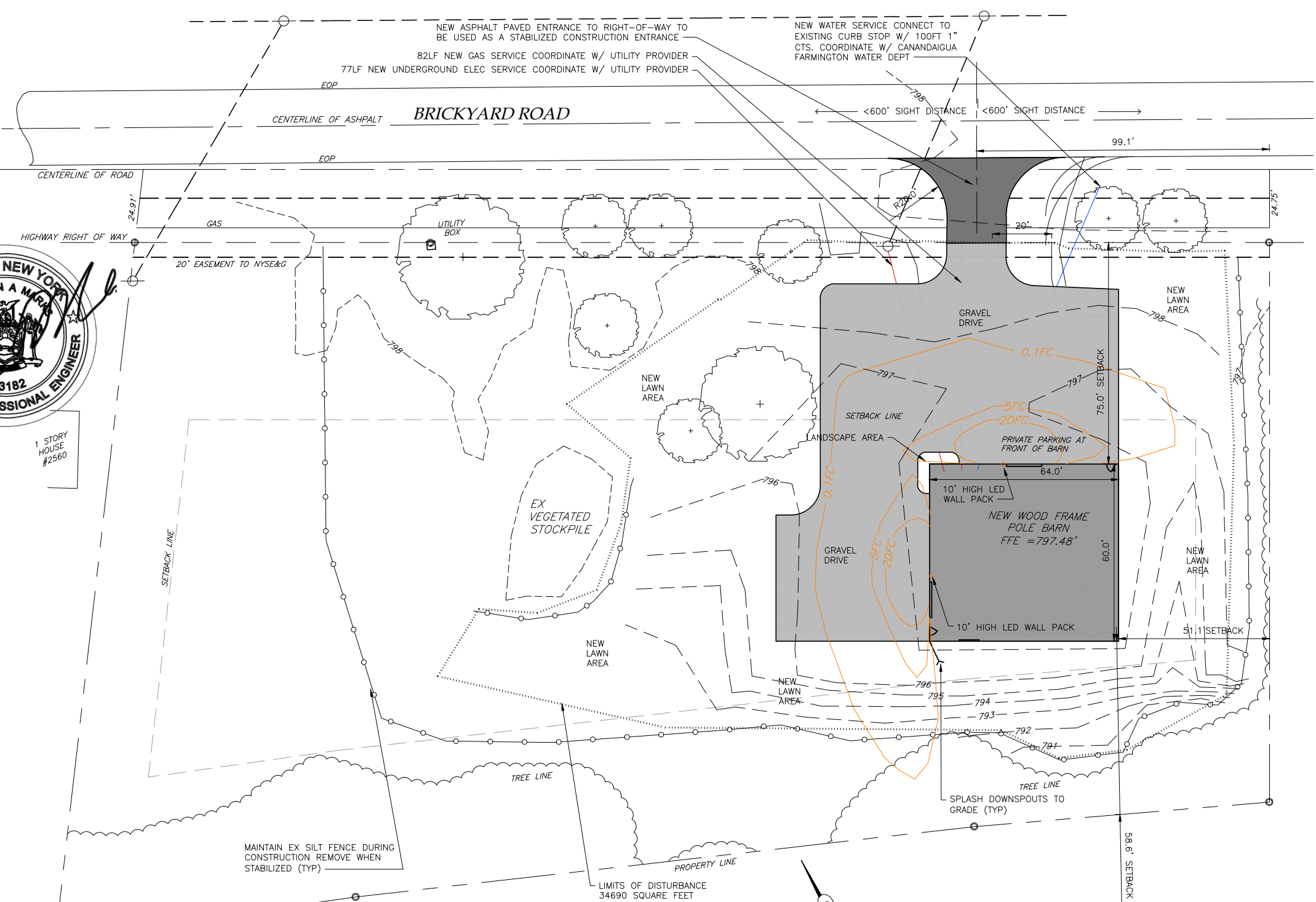

UTILITY NOTES:

- CONTRACTOR SHALL COORDINATE ALL WORK W/ UTILITY PROVIDERS
- COORDINATE GAS LINE DEPTH AT DRIVEWAY CROSSING
- WATER LINE SHALL BE BURIED AT MIN 5 FEET W/ TRACER WIRE
- ELEC SERVICE AND COMMUNICATION SHALL MEET CURRENT NATIONAL ELECTRIC CODE.
- GAS SERVICE SHALL BE INSTALLED PER CURRENT INTERNATIONAL FUEL GAS CODE.

LOT COVERAGE CALCS:
GRAVEL PARKING AND DRIVEWAYS - 9229SF
BUILDING AREA - 3840SF
TOTAL IMPERVIOUS - 13069SF
TOTAL LOT AREA - 92782SF
TOTAL PROPOSED IMPERVIOUS - 14.08%

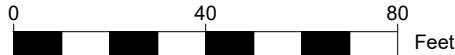

PLANNING BOARD CHAIRMAN	DATE
TOWN ENGINEER	DATE
HIGHWAY SUPERINTENDENT	DATE
CANANDAIGUA FARMINGTON WATER DISTRICT SUPERINTENDENT	DATE

DRAWN BY:	KRB
CHECKED BY:	BMARKS
SCALE:	1"=40'
JOB NO.:	17-046
DATE:	06/22/2017
TAX MAP#:	70.00-1-44

PREPARED FOR:
KEVIN MOTTLE
NEW POLE BARN
2580 BRICKYARD ROAD
TOWN OF CANANDAIGUA
COUNTY OF ONTARIO
STATE OF NEW YORK

SITE PLAN

REVISIONS AND APPROVALS

NO.	DATE	DESCRIPTION OF REVISION OR APPROVAL	BY
1	06/23/2017	PER TOWN COMMENTS	BAM
2	07/25/2017	PER TOWN ENGINEER COMMENTS	BAM
3	09/18/2017	PER TOWN BLDG. DEPARTMENT	BAM



MarksEngineering
Design-it. Build-it

42 BEEMAN ST
CANANDAIGUA, NY 14424
www.marksengineering.com

Phone 585-905-0360
Fax: 585-485-6205
bmarks@marksengineering.com

C100

GENERAL NOTES:

1. THE CONTRACTOR SHALL MAINTAIN ALL UTILITIES AND PROPERTY MARKERS. IT IS THE NYS LAW TO CALL NYS DIG SAFE FOR UFPO (811) PRIOR TO ANY EXCAVATION.
2. THE ROADWAY SHALL BE KEPT FREE OF DEBRIS DURING CONSTRUCTION.
3. THE CONTRACTOR IS RESPONSIBLE FOR SAFETY CONTROL DEVICES. SUCH DEVICES (BARRICADES, FENCING, ETC.) SHALL BE IMPLEMENTED TO MINIMIZE RISK OF INJURY TO PEDESTRIANS AND WORKERS. CONSTRUCTION ACTIVITY SHALL BE CONDUCTED WITHIN COMPLIANCE WITH OSHA GUIDELINES.
4. PLANS ARE GRAPHIC REPRESENTATIONS OF WORK TO BE PERFORMED. THESE PLANS ARE TO INTENDED TO CONVEY ENGINEERING INFORMATION ONLY.
5. CONTRACTOR TO VERIFY ALL LOCATIONS, GRADES AND INVERTS AND NOTIFY ENGINEER OF ANY DISCREPANCIES PRIOR TO THE START OF WORK.
6. ALL SPECIFIED MATERIALS ARE TO BE INSTALLED AS PER MANUFACTURES RECOMMENDATIONS OR INDUSTRY STANDARD.
7. ENGINEER DOES NOT HOLD ANY LIABILITY FOR SYSTEM FAILURE. ANY SYSTEM MODIFICATIONS OR DEVIATIONS FROM THE APPROVED PLANS, NYS BUILDING CODES, AND/OR LOCAL REGULATIONS REQUIRED BY SITE CONSTRAINTS, UNFORESEEN CONDITIONS OR GOVERNING AUTHORITIES WILL BE DONE AT THE RISK OF THE CLIENT.
8. ALL CONSTRUCTION SHALL COMPLY WITH CURRENT NYS AND LOCAL BUILDING CODES AS WELL AS NATIONAL ELECTRIC CODE.

EROSION AND SEDIMENT CONTROL NOTES:

1. THE CONTRACTOR IS RESPONSIBLE FOR THE CONTROL OF EROSION AND SEDIMENTATION DURING CONSTRUCTION. SILT FENCE SHALL BE INSTALLED AND MAINTAINED AS NEEDED.
2. SOIL DISTURBANCES SHALL BE STABILIZED IMMEDIATELY. DISTURBED SOIL THAT WILL REMAIN LONGER THAN 14 DAYS SHALL BE TEMPORARILY STABILIZED WITHIN 7 DAYS. SOIL SHALL BE STABILIZED WITH NORTHERN GRASS SEED MIXTURE OR APPROPRIATE SEED MIXTURE FOR CONDITIONS. GRASS SEED SHALL BE INSTALLED PER MANUFACTURES SPECIFICATIONS. MULCH STRAW APPLIED AT A RATE OF 2 BALES / 1000 SQFT OR SEED MIXTURE TO PROTECT SITE UNTIL SEED GERMINATES. HYDRO-SEED MAY BE INSTALLED AS AN ALTERNATE.
3. CONTRACTOR SHALL INSPECT THE SITE DAILY FOR SIGNS OF EROSION. IF ANY EROSION OR SEDIMENTATION OCCUR CONTRACTOR SHALL IMMEDIATELY PROVIDE PROPER CONTROLS TO STABILIZE THE SITE. ENGINEER WILL RECOMMEND CONTROLS IF REQUIRED.
4. SLOPE GREATER THAN 4 ON 1 SHALL BE STABILIZED WITH JUTE FABRIC INSTALLED AS PER MANUFACTURES SPECIFICATIONS AS REQUIRED.
5. ALL EROSION AND SEDIMENTATION CONTROL MEASURES SHALL BE IN STALLED IN ACCORDANCE WITH NYS STANDARDS AND SPECIFICATIONS FOR EROSION AND SEDIMENTATION CONTROLS.
6. INSTALL AND MAINTAIN TEMPORARY DIVERSION SWALES AS NEEDED TO CONTROL RUNOFF DURING CONSTRUCTION.
7. THE SITE SHALL BE COMPLETELY STABILIZED FOLLOWING CONSTRUCTION ACTIVITIES AND ALL TEMPORARY EROSION CONTROL DEVICES SHALL BE REMOVED AND DISPOSED OF PROPERLY.
8. CONCRETE TRUCKS SHALL NOT BE ALLOWED TO WASH-OUT ON SITE.
9. CONSTRUCTION STAGING AND PARKING AREAS SHALL BE LIMITED TO PAVED OR STONE AREAS OUTSIDE OF THE HIGHWAY RIGHT-OF-WAY.
10. ANY UNUSED SPOIL SHALL BE HAULED OFFSITE IMMEDIATELY.
11. TOPSOIL HAS BEN PREVIOUSLY REMOVED FROM SITE.

GRADING NOTES:

1. CUT AND FILL SLOPES SHALL NOT EXCEED 3 ON 1.
2. CONSTRUCTION SHALL CONFORM TO THE TOWN OF CANANDAIGUA AND NYS CODES AND STANDARDS
3. SITE SHALL BE GRADED SUCH THAT THERE IS POSITIVE DRAINAGE AT A MINIMUM OF 2% AWAY FROM ANY BUILDINGS, STRUCTURES, DRIVEWAYS, AND SEPTIC SYSTEM.
4. TOPSOIL SHALL BE STRIPED OF AREAS PLANNED FOR CONSTRUCTION AND REAPPLIED AFTER GRADING IS FINISHED. ANY UNUSED TOPSOIL SHALL BE HAULED OFF SITE.

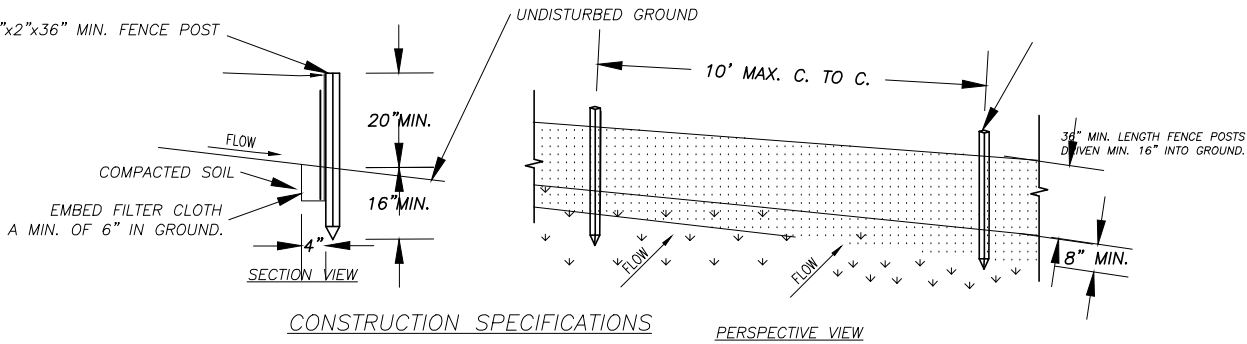

1. WOVEN WIRE FENCE TO BE FASTENED SECURELY TO FENCE POSTS WITH WIRE TIES OR STAPLES. POSTS SHALL BE STEEL EITHER "I" OR "U" TYPE OR HARDWOOD.
2. FILTER CLOTH TO BE TO BE FASTENED SECURELY TO POSTS WITH STAPLES.
3. WHEN TWO SECTIONS OF FILTER CLOTH ADJOIN EACH OTHER THEY SHALL BE OVER-LAPPED BY SIX INCHES AND FOLDED. FILTER CLOTH SHALL BE EITHER FILTER X, MIRAFI 100X, STABILINKA T140N, OR APPROVED EQUIVALENT.
4. PREFABRICATED UNITS SHALL BE GEOFAB, ENVIRONMENT, OR APPROVED EQUIVALENT.
5. MAINTENANCE SHALL BE PERFORMED AS NEEDED AND MATERIAL REMOVED WHEN "BULGES" DEVELOP IN THE SILT FENCE.

1 TYPICAL SILT FENCE DETAIL
NTS

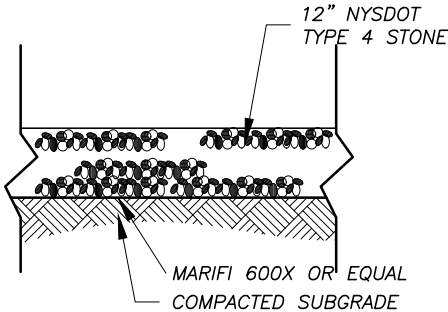

2 TYPICAL GRAVEL DRIVE SECTION
NTS

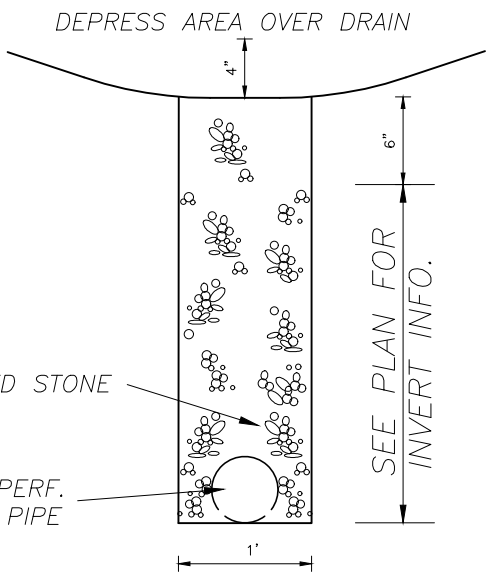

3 CURTAIN DRAIN DETAIL
NTS

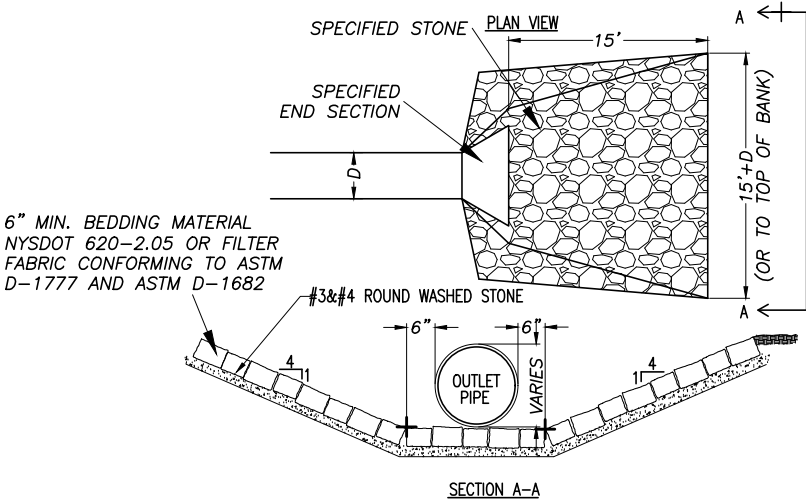

4 TYPICAL STONE OUTLET PROTECTION
NTS

Engineer's Opinion of Probable Cost

	Quantity	Unit	Unit Cost	Sub Total
Silt Fence Material	600	ft	\$ 0.50	\$ 300.00
Silt Fence Labor	10	hr	\$ 30.00	\$ 300.00
Temporary Seed 25#	4	Bag	\$ 25.00	\$ 100.00
Temporary Seed Labor	2	hr	\$ 15.00	\$ 30.00
Straw Mulch Material	15	bale	\$ 2.00	\$ 30.00
Straw Mulch Labor	5	hr	\$ 15.00	\$ 75.00
Stone Outlet Protection Material	0.5	cy	\$ 20.00	\$ 10.00
Stone Outlet Protection Labor	2	hr	\$ 20.00	\$ 40.00
Total			\$	885.00

DRAWN BY:	KRB
CHECKED BY:	BMARKS
SCALE:	1"=40'
JOB NO.:	17-046
DATE:	06/22/2017
TAX MAP#:	70.00-1-44

PREPARED FOR:
KEVIN MOTTLER
NEW POLE BARN
2580 BRICKYARD ROAD
TOWN OF CANANDAIGUA
COUNTY OF ONTARIO STATE OF NEW YORK

DETAILS			
REVISIONS AND APPROVALS			
NO.	DATE	DESCRIPTION OF REVISION OR APPROVAL	BY
1	06/23/2017	PER TOWN COMMENTS	BAM
2	07/25/2017	PER TOWN ENGINEER COMMENTS	BAM
3	09/18/2017	PER TOWN BLDG DEPARTENT	BAM



42 BEEMAN ST
CANANDAIGUA, NY 14424
www.marksengineering.com

Phone 585-905-0360
Fax: 585-485-6205
bmarks@marksengineering.com



C500

TOWN OF CANANDAIGUA STANDARD NOTES

1. ALL IMPROVEMENTS SHALL BE IN ACCORDANCE WITH THE MOST RECENT STANDARDS AND SPECIFICATIONS OF THE TOWN OF CANANDAIGUA AND THE APPROPRIATE WATER/SEWER AGENCIES, UNLESS OTHERWISE NOTED.
2. DEVELOPMENT IN THE CANANDAIGUA LAKE WATERSHED THAT REQUIRES POST CONSTRUCTION WATER QUALITY MEASURES SUCH AS SMF'S, THE DEVELOPER IS REQUIRED TO PROVIDE DAILY ONSITE OBSERVATION BY A LICENSE PROFESSIONAL OR A CERTIFIED PERSONS IN EROSION AND SEDIMENT CONTROL (CPESC) UNTIL SUCH TIME THAT THE MASS GRADING IS COMPLETED.
3. DEVELOPMENT IN THE CANANDAIGUA LAKE WATERSHED DISTURBING MORE THAN 5--ACRES AT ONE TIME, SHALL BE REQUIRED TO COORDINATE THE REGULAR SWPPP OBSERVATIONS REQUIRED BY THE GENERAL PERMIT (GP0-08-001) WITH THE CANANDAIGUA LAKE WATERSHED INSPECTOR AND THE WATERSHED PROGRAM MANAGER.
4. SEQUENCE -- THE CONTRACTOR SHALL INSTALL EROSION CONTROL MEASURES IN THE FOLLOWING SEQUENCE UNLESS AUTHORIZED OTHERWISE AT THE PRE --CONSTRUCTION MEETING:
- INSTALL PERIMETER SEDIMENT CONTROLS, (I.E. EROSION FENCING).
 - INSTALL STABILIZED CONSTRUCTION ENTRANCE.
 - PROTECT VEGETATION TO REMAIN.
 - CLEAR GRUB AND CONSTRUCT DIVERSIONARY SWALES AND SEDIMENT BASINS.
 - COMPLETE CLEARING AND GRUBBING OPERATION.
 - PLACE EROSION CONTROL MEASURES AROUND TOPSOIL STOCKPILES AND STRIP TOPSOIL LOCATIONS.
 - CONSTRUCT SWALES AND SILTATION DEVICES AS EARTHWORK OPERATIONS PROGRESS.
 - MAINTAIN EROSION CONTROL MEASURES AND PLACE ADDITIONAL MEASURES AS EARTHWORK AND UNDERGROUND UTILITIES ARE CONSTRUCTED.
 - RESTORE AREAS AS DEFINED BY CONTRACT DOCUMENTS.
 - REMOVE EROSION CONTROL MEASURES AS AREAS ARE REESTABLISHED WITH GROUND COVER.
 - IF SITE PREPARATIONS OCCUR BETWEEN SEPTEMBER 1 AND MARCH 31, ADDITIONAL EROSION CONTROLS MUST BE TAKEN INCLUDING REDUCING THE SIZE OF DISTURBED AREAS AND PLACING HEAVY STRAW MULCH WHERE PRACTICAL.
5. PLANS SHOULD INCLUDE RE--SEEDING INSTRUCTIONS INCLUDING MATERIALS AND A TIMETABLE FOR VARIOUS SEEDING
- SEED ALL CUT AND FILL, TOPSOIL PILES AND PONDS WITHIN FOURTEEN (7) DAYS AFTER COMPLETION.
 - TEMPORARY SEEDING OF DISTURBED AREAS SHALL BE PROVIDED AS FOLLOWS:

THE SURFACE TWO INCHES OF SOIL SHOULD BE LOOSENEED BY DISKING, RAKING, OR BACK--BLADING WITH A BULLDOZER. IMMEDIATELY FERTILIZE WITH 300 POUNDS PER ACRE (OR 7 POUNDS PER 1,000 SQUARE FEET) OF 10-10-10 FERTILIZER. IMMEDIATELY SEED WITH THE FOLLOWING MIX:

	LBS/ACRE	LBS/1,000 SQ. ACRE
SPRING/SUMMER/EARLY FALL		
ANNUAL RYEGRASS	30	0.7
PERENNIAL RYEGRASS	30	0.7
LATE FALL/EARLY WINTER		
CEREAL RYE	100	2.5

SEED SHOULD HAVE A GERMINATION RATE OF AT LEAST 85 PERCENT AND MINIMAL INERT MATERIAL.

DISTURBED AREAS SHALL BE STABILIZED USING PERMANENT LAWN SEEDING MIX UPON COMPLETION OF GRADING AND CONSTRUCTION:

	LBS/ACRE	LBS/1,000 SQ. ACRE
BIRDSFOOT TREFOIL OR COMMON WHITE CLOVER	8 OR 8	0.20 OR 0.20
TALL FESCUE	20	0.45
REDTOP OR RYEGRASS (PERENNIAL)	2 OR 5	0.05 OR 0.10

SEEDING RATE: 6.0 POUNDS PER 1,000 SQUARE FEET
MULCH: STRAW OR WOOD FIBER MULCH USED WITH HYRDO SEEDING METHOD AT TWO TONS PER ACRE WITH TRACKIFIER.
STARTING FERTILIZER: 5:10:10 AT 20 POUNDS PER 1,000 SQUARE FEET.

- FOR FALL OR EARLY WINTER, SEED WITH CERTIFIED "AROOSTOCK" WINTER RYE (CEREAL RYE) AT 100 POUNDS PER ACRE.
- PERMANENT STABILIZATION FOR STEEP SLOPES GREATER THAN 3:1 SHALL INCLUDE JUTE MESH BLANKET AND CROWN VETCH SEED WITH PERENNIAL RYEGRASS.

4. THE CONTRACTOR SHALL LOCATE, MARK, SAFEGUARD AND PRESERVE ALL SURVEY CONTROL MONUMENTS AND RIGHT--OF--WAY MONUMENTS IN THE AREAS OF CONSTRUCTION.
5. EXISTING UNDERGROUND UTILITIES SHOWN HEREIN WERE PLOTTED FROM FIELD LOCATIONS AND/OR UTILITY COMPANY RECORD PLANS. PRIOR TO ANY CONSTRUCTION, THE CONTRACTOR SHALL CALL THE DIG SAFELY NEW YORK (UFPO) HOTLINE AT 1-800-962-7962 FOR STAKEOUT OF EXISTING UTILITIES. THE CONTRACTOR SHALL DETERMINE EXACT LOCATION AND ELEVATION OF UNDERGROUND UTILITIES BEFORE COMMENCING CONSTRUCTION. CONTRACTOR SHALL MAKE EXPLORATION EXCAVATIONS TO LOCATE EXISTING UNDERGROUND FACILITIES SUFFICIENTLY AHEAD OF CONSTRUCTION TO PERMIT REVISIONS AS REQUIRED TO MEET THE EXISTING CONDITIONS.
6. DUST SHALL BE CONTROLLED DURING CONSTRUCTION BY THE CONTRACTOR TO MINIMIZE EFFECT ON THE ADJACENT PROPERTIES. THE CONTRACTOR SHALL IMPLEMENT DUST CONTROL MEASURES AS NEEDED AND/OR AS DIRECTED BY THE TOWN OF CANANDAIGUA.
7. THE OWNER'S CONTRACTOR SHALL BE RESPONSIBLE FOR THE ESTABLISHMENT, MAINTENANCE, CLEANING, REPAIR AND REPLACEMENT OF EROSION CONTROL MEASURES DURING SITE CONSTRUCTION.
8. ROOF LEADERS SHALL BE CONNECTED TO STORM SEWERS.
9. NO SITE PREPARATION SHALL COMMENCE UNTIL A VISUAL INSPECTION BY THE TOWN OF CANANDAIGUA, CONFIRMS THE INSTALLATION OF PERIMETER SEDIMENT CONTROLS.
10. UPON COMPLETION OF CONSTRUCTION AND ESTABLISHMENT OF VEGETATION, THE SILT SINK IN THE STORMWATER MANAGEMENT AREA SHALL BE CLEANED OF ACCUMULATED SILT AND SEEDED WITH WETLAND TYPE VEGETATION TO PROVIDE PERMANENT FILTRATION OF STORMWATER.
11. THE HOMEBUILDER WILL BE RESPONSIBLE FOR PROVIDING AND MAINTAINING INDIVIDUAL LOT EROSION & SEDIMENT CONTROL MEASURES, DURING HOUSE CONSTRUCTION. MEASURES TO BE MAINTAINED UNTIL FINAL LOT LAWN GRADING AND SEED IS COMPLETE.
12. ANY ADDITIONAL EROSION OR SEDIMENT CONTROL DEEMED NECESSARY BY THE TOWN OR A REPRESENTATIVE THEREOF SHALL BE PROVIDED BY THE OWNER.
13. SEDIMENT CONTROL MEASURES ARE TO BE ESTABLISHED PRIOR TO COMMENCING EARTHWORK. SEDIMENT CONTROL MEASURES ARE TO BE MAINTAINED BY THE CONTRACTOR UNTIL UPSTREAM GROUND COVER HAS BEEN ESTABLISHED AND REMOVAL IS APPROVED BY THE TOWN OF CANANDAIGUA.
14. THE CONTRACTOR IS RESPONSIBLE FOR MAINTAINING, REPLACING AND SUBSEQUENTLY REMOVING TEMPORARY EROSION & SEDIMENT CONTROL DEVICES.
15. THE CONTRACTOR SHALL BE RESPONSIBLE FOR CLEANING ADJOINING PROPERTIES, ROADWAYS, DRAINAGE WAYS AND SINKS OF SILT ACCUMULATION AS NEEDED AND AS DETERMINED/REQUESTED BY THE TOWN OF CANANDAIGUA.
16. ANY FINAL GRADE DEVIATIONS OF HOUSE PAD ELEVATIONS MORE THAN 12 INCHES SHALL BE APPROVED BY THE PLANNING BOARD.

MAINTENANCE SCHEDULE

1. CONTRACTOR SHALL GUARANTEE ALL PLANT MATERIALS FOR A PERIOD OF 3 YEARS FROM THE DATE OF INITIAL PLANTING.
2. FLOOD PLANTS TWICE WITHIN THE FIRST 24 HOURS.
3. PRUNING MAY BE DONE OVER A PERIOD OF TIME (3-4 YEARS) AND THEN REPEAT THE CYCLE. SOME COMPANIES OFFER REDUCED RATES FOR TREE PRUNING DURING THE WINTER MONTHS.
4. FERTILIZATION MAY ALSO BE DONE OVER A PERIOD OF TIME WITH REPEATING CYCLES.
5. SPRAY PROGRAMS SHOULD BE DONE YEARLY. PESTICIDES USED IN PROGRAMS TODAY ONLY HAVE A TEN DAY EFFECTIVE LIFE.



DRAWN BY:	KRB
CHECKED BY:	BMARKS
SCALE:	1"=40'
JOB NO.:	17-046
DATE:	06/22/2017
TAX MAP#:	70.00-1-44

PREPARED FOR: KEVIN MOTTLE NEW POLE BARN 2580 BRICKYARD ROAD TOWN OF CANANDAIGUA COUNTY OF ONTARIO	STATE OF NEW YORK
--	-------------------

WASTEWATER DETAILS			
REVISIONS AND APPROVALS			
NO.	DATE	DESCRIPTION OF REVISION OR APPROVAL	BY
1	06/23/2017	PER TOWN COMMENTS	BAM
2	07/25/2017	PER TOWN ENGINEER COMMENTS	BAM
3	09/18/2017	PER TOWN BLDG DEPARTMENT	BAM

 MarksEngineering Design-it. Build-it	42 BEEMAN ST CANANDAIGUA, NY 14424 www.marksengineering.com	Phone 585-905-0360 Fax: 585-485-6205 bmarks@marksengineering.com
--	---	--

C501

WPLED2T360N/D10/WS10



Ultra high output, high efficiency 360 Watt LED wallpacks with multi-level motion sensor. Patent Pending airflow technology ensures long LED and driver lifespan. 5 Year Warranty.

Color: Bronze

Weight: 79.4 lbs

Project:

Type:

Prepared By:

Date:

Driver Info

Type: Constant Current
120V: 3.0A
208V: 1.8A
240V: 1.5A
277V: 1.3A
Input Watts: 359W
Efficiency: N/A

LED Info

Watts: 360W
Color Temp: 4000K
Color Accuracy: 70 CRI
L70 Lifespan: 100000
Lumens: 35818
Efficacy: 100 LPW

Technical Specifications

Listings

UL Listing:

Suitable for wet locations.

DLC Listed:

This product is on the Design Lights Consortium (DLC) Qualified Products List and is eligible for rebates from DLC Member Utilities.
DLC Product Code: PWS3E5B5

IESNA LM-79 & IESNA LM-80 Testing:

RAB LED luminaires have been tested by an independent laboratory in accordance with IESNA LM-79 and 80, and have received the Department of Energy "Lighting Facts" label.

Dark Sky Approved:

The International Dark Sky Association has approved this product as a full cutoff, fully shielded luminaire.

Construction

IP Rating:

Ingress Protection rating of IP66 for dust and water

IES Classification:

The Type II distribution is ideal for wide walkways, on ramps and entrance roadways, bike paths and other long and narrow lighting applications. This type is meant for lighting larger areas and usually is located near the roadside. This type of lighting is commonly found on smaller side streets or jogging paths.

Maximum Ambient Temperature:

Suitable for use in 104° F (40°C) ambient temperatures

Cold Weather Starting:

Minimum starting temperature is -40° F (-40° C)

Thermal Management:

Superior heat sinking with external Air-Flow fins.

Housing:

Die cast aluminum with airflow fins for cooling.

Lens:

Tempered glass

Reflector:

Vacuum-metalized polycarbonate

Gaskets:

High temperature silicone gaskets.

Finish:

Formulated for high-durability and long lasting color.

Green Technology:

Mercury and UV free. RoHS compliant components. Polyester powder coat finish formulated without the use of VOC or toxic heavy metals.

For use on LEED Buildings:

IDA Dark Sky Approval means that this fixture can be used to achieve LEED Credits for Light Pollution Reduction.

LED Characteristics

LEDs:

Multi-chip, high-output, long-life LEDs

Color Consistency:

3-step MacAdam Ellipse binning to achieve consistent fixture-to-fixture color.

Color Stability:

LED color temperature is warrantied to shift no more than 200K in CCT over a 5 year period.

Color Uniformity:

RAB's range of CCT (Correlated Color Temperature) follows the guidelines of the American National Standard for Specifications for the Chromaticity of Solid State Lighting (SSL) Products, ANSI C78.377-2015.

Electrical

Dimming Driver:

Driver includes dimming control wiring for 0-10V dimming systems. Requires separate 0-10V DC dimming circuit. Dims as low as 10%.

Drivers:

Constant Current, Class 1, 1560mA, 100-277V, 50-60Hz, 120V: 3.0A, 208V: 1.8A, 240V: 1.5A, 277V: 1.3A

Surge Protection:

6kV

Other

Country of Origin:

Designed by RAB in New Jersey and assembled in the USA by RAB's IBEW Local 3 workers.

Buy American Act Compliant:

This product is a COTS item manufactured in the United States, and is compliant with the Buy American Act.

Recovery Act (ARRA) Compliant:

This product complies with the 52.225-21 "Required Use of American Iron, Steel, and Manufactured Goods-- Buy American Act-- Construction Materials (October 2010).

WPLED2T360N/D10/WS10



Technical Specifications (continued)

Other

GSA Schedule:

Suitable in accordance with FAR Subpart 25.4.

Warranty:

RAB warrants that our LED products will be free from defects in materials and workmanship for a period of five (5) years from the date of delivery to the end user, including coverage of light output, color stability, driver performance and fixture finish.

Patents:

The WPLED design is protected by patents pending in the U.S., Canada, China, Taiwan and Mexico.

Dimensions

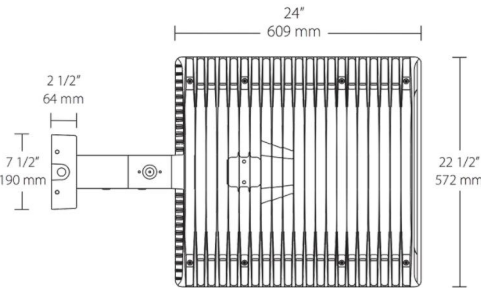
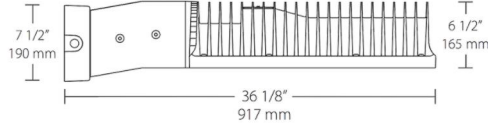

Features

Includes integrated motion sensor/photocell for multi-level control

High output, high efficiency LED

Maintains 70% of initial lumens at 100,000 hours

Weatherproof high temperature silicone gaskets

Superior heat sinking with die cast aluminum housing and external fins

5-year warranty



Need help? Tech help line: (888) RAB-1000 Email: sales@rabweb.com Website: www.rabweb.com
Copyright © 2014 RAB Lighting Inc. All Rights Reserved Note: Specifications are subject to change at any time without notice

Page 1 of 2

Need help? Tech help line: (888) RAB-1000 Email: sales@rabweb.com Website: www.rabweb.com
Copyright © 2014 RAB Lighting Inc. All Rights Reserved Note: Specifications are subject to change at any time without notice

Page 2 of 2

DRAWN BY:	KRB
CHECKED BY:	BMARKS
SCALE:	1"=40'
JOB NO.:	17-046
DATE:	06/22/2017
TAX MAP#:	70.00-1-44

PREPARED FOR:
KEVIN MOTTLE
NEW POLE BARN
2580 BRICKYARD ROAD
TOWN OF CANANDAIGUA
COUNTY OF ONTARIO STATE OF NEW YORK

WASTEWATER DETAILS			
REVISIONS AND APPROVALS			
NO.	DATE	DESCRIPTION OF REVISION OR APPROVAL	BY
1	06/23/2017	PER TOWN COMMENTS	BAM
2	07/25/2017	PER TOWN ENGINEER COMMENTS	BAM
3	09/18/2017	PER TOWN BLDG DEPARTMENT	BAM



MarksEngineering
Design-it. Build-it

42 BEEMAN ST
CANANDAIGUA, NY 14424
www.marksengineering.com

Phone 585-905-0360
Fax: 585-485-6205
bmarks@marksengineering.com

C502

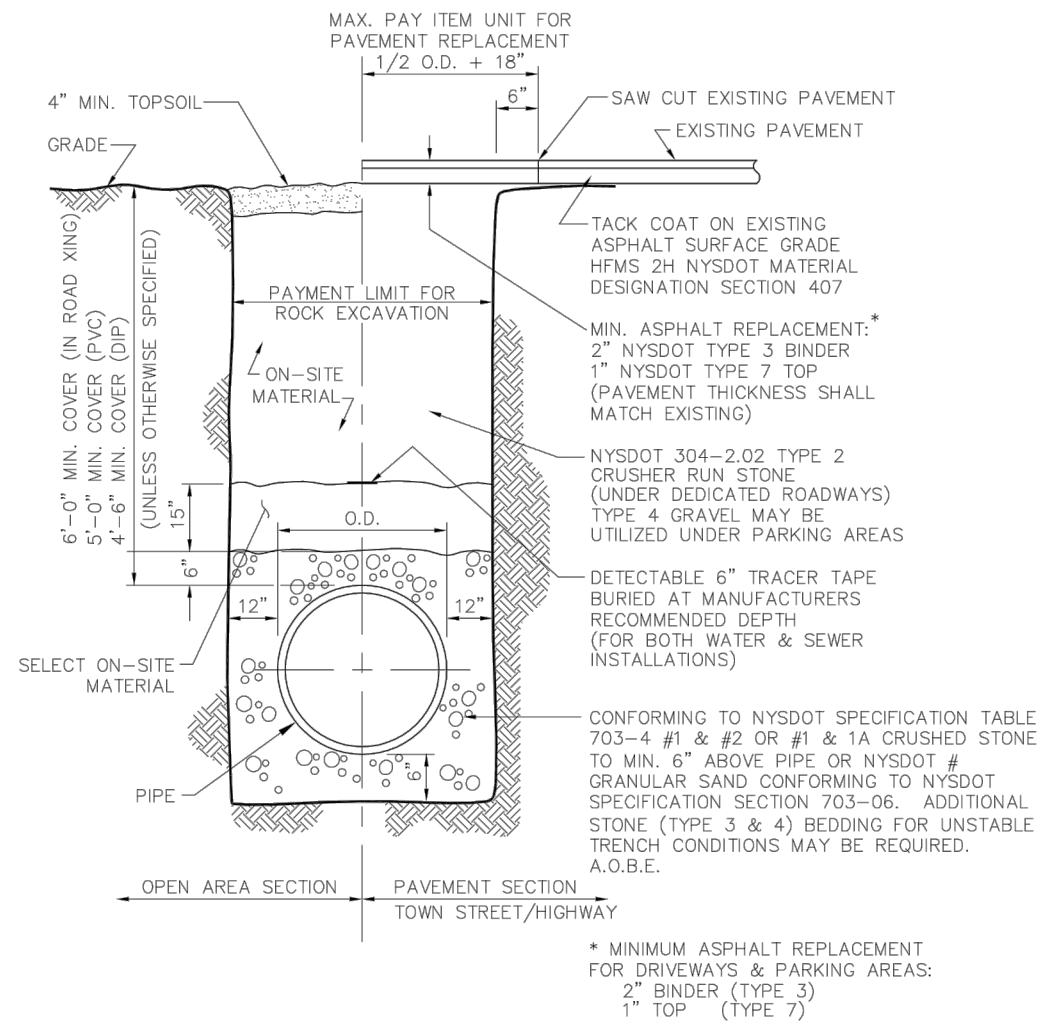
**PIPE BEDDING/ TRENCH DETAIL**

(OUTSIDE OF N.Y.S. HIGHWAYS)

(N.T.S.)

W-1

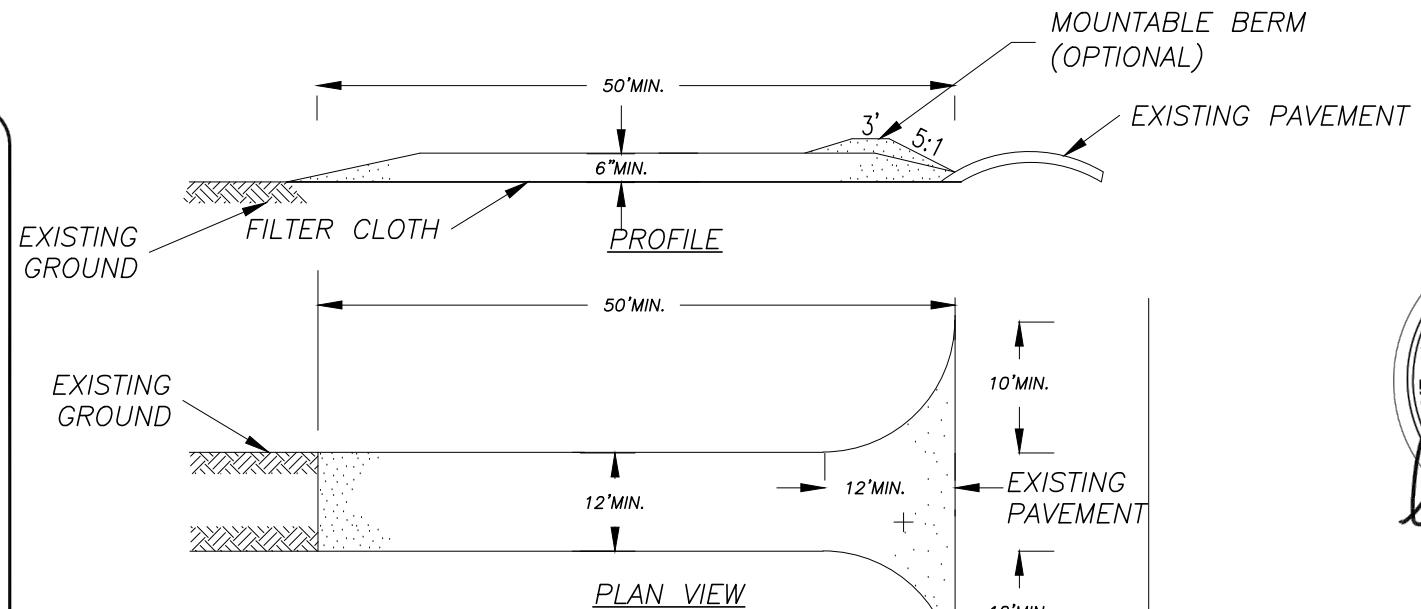
**CONSTRUCTION SPECIFICATIONS**

1. STONE SIZE – USE 2" STONE, OR RECLAIMED OR RECYCLED CONCRETE EQUIVALENT.
2. LENGTH – NOT LESS THAN 50 FEET (EXCEPT ON A SINGLE RESIDENCE LOT WHERE A 30 FOOT MINIMUM LENGTH WOULD APPLY).
3. THICKNESS – NOT LESS THAN SIX (6) INCHES.
4. WIDTH – TWELVE (12) FOOT MINIMUM, BUT NOT LESS THAN THE FULL WIDTH AT POINTS WHERE INGRESS OR EGRESS OCCURS. TWENTY-FOUR (24) FOOT IF SINGLE ENTRANCE TO SITE.
5. FILTER CLOTH – WILL BE PLACED OVER THE ENTIRE AREA PRIOR TO PLACING OF STONE.
6. SURFACE WATER – ALL SURFACE WATER FLOWING OR DIVERTED TOWARD CONSTRUCTION ENTRANCES SHALL BE PIPED ACROSS THE ENTRANCE. IF PIPING IS IMPRACTICAL, A MOUNTABLE BERM WITH 5:1 SLOPES WILL BE PERMITTED.
7. MAINTENANCE – THE ENTRANCE SHALL BE MAINTAINED IN A CONDITION WHICH WILL PREVENT TRACKING OR FLOWING OF SEDIMENT ONTO PUBLIC RIGHTS-OF-WAY, ALL SEDIMENT SPILLED, DROPPED, WASHED OR TRACTED ONTO PUBLIC RIGHTS-OF-WAY MUST BE REMOVED IMMEDIATELY.
8. WHEN WASHING IS REQUIRED, IT SHALL BE DONE ON A AREA STABILIZED WITH STONE AND WHICH DRAINS INTO AN APPROVED SEDIMENT TRAPPING DEVICE.
9. PERIODIC INSPECTION AND NEEDED MAINTENANCE SHALL BE PROVIDED AFTER EACH RAIN.

2

STABILIZED CONSTRUCTION ENTRANCE
NTS

DRAWN BY:	KRB
CHECKED BY:	BMARKS
SCALE:	1"=40'
JOB NO.:	17-046
DATE:	06/22/2017
TAX MAP#:	70.00-1-44

PREPARED FOR:
KEVIN MOTTLE
 NEW POLE BARN
 2580 BRICKYARD ROAD
 TOWN OF CANANDAIGUA
 COUNTY OF ONTARIO STATE OF NEW YORK

WASTEWATER DETAILS**REVISIONS AND APPROVALS**

NO.	DATE	DESCRIPTION OF REVISION OR APPROVAL	BY
1	06/23/2017	PER TOWN COMMENTS	BAM
2	07/25/2017	PER TOWN ENGINEER COMMENTS	BAM
3	09/18/2017	PER TOWN BLDG DEPARTMENT	BAM



MarksEngineering
 Design-it. Build-it

42 BEEMAN ST
 CANANDAIGUA, NY 14424
 Phone 585-905-0360
 Fax: 585-485-6205
 www.marksengineering.com bmarks@marksengineering.com

C503

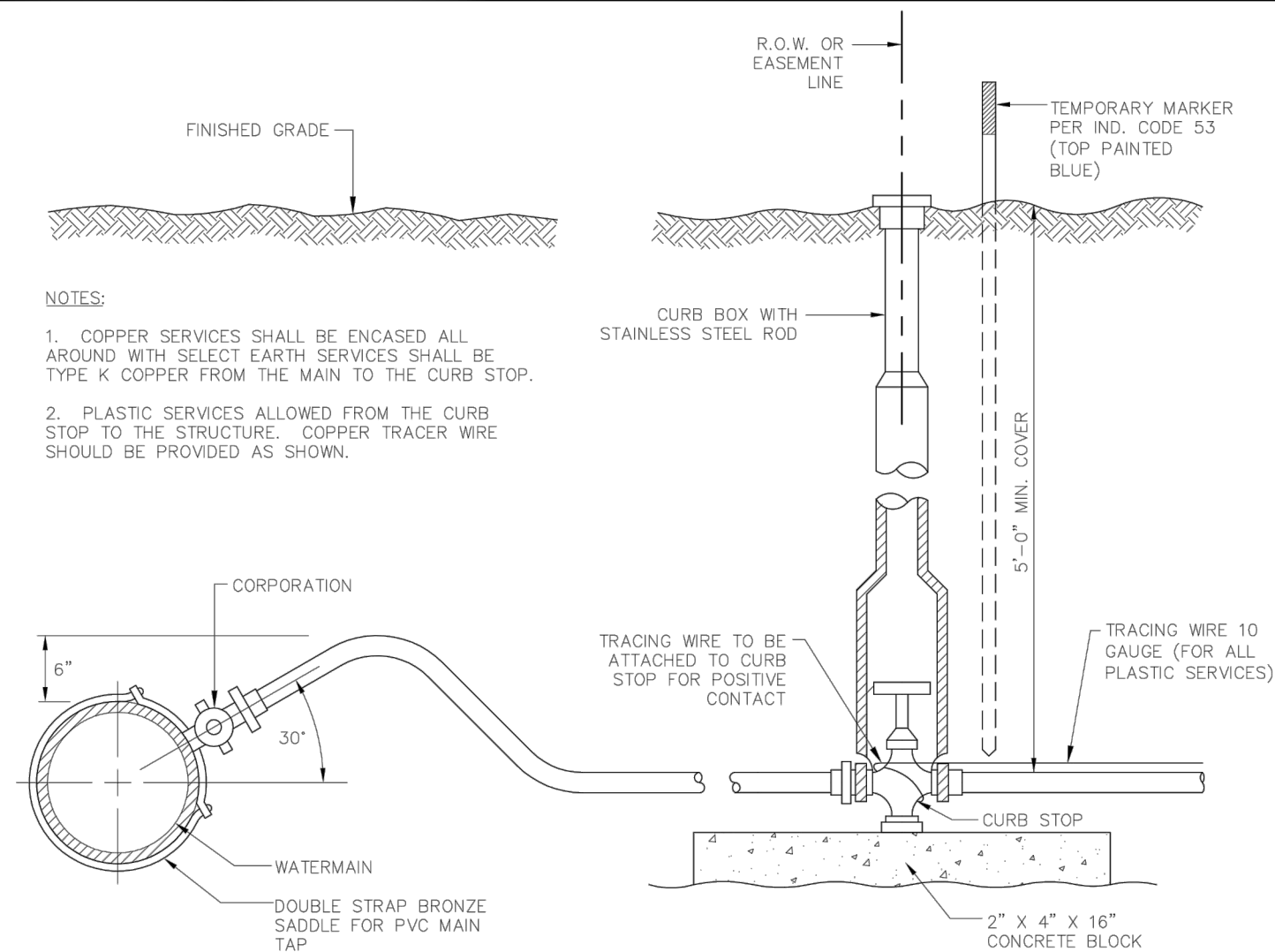

NOTES:

1. COPPER SERVICES SHALL BE ENCASED ALL AROUND WITH SELECT EARTH SERVICES SHALL BE TYPE K COPPER FROM THE MAIN TO THE CURB STOP.
2. PLASTIC SERVICES ALLOWED FROM THE CURB STOP TO THE STRUCTURE. COPPER TRACER WIRE SHOULD BE PROVIDED AS SHOWN.

TYPICAL WATER SERVICE

(N.T.S.)



TOWN OF CANANDAIGUA

DRAWN BY:	KRB
CHECKED BY:	BMARKS
SCALE:	1"=40'
JOB NO.:	17-046
DATE:	06/22/2017
TAX MAP#:	70.00-1-44

PREPARED FOR:
KEVIN MOTTLE
NEW POLE BARN
2580 BRICKYARD ROAD
TOWN OF CANANDAIGUA
COUNTY OF ONTARIO STATE OF NEW YORK

WASTEWATER DETAILS

REVISIONS AND APPROVALS			
NO.	DATE	DESCRIPTION OF REVISION OR APPROVAL	BY
1	06/23/2017	PER TOWN COMMENTS	BAM
2	07/25/2017	PER TOWN ENGINEER COMMENTS	BAM



MarksEngineering
Design-it. Build-it

42 BEEMAN ST
CANANDAIGUA, NY 14424
www.marksengineering.com bmarks@marksengineering.com
Phone 585-905-0360
Fax: 585-485-6205

C503