

## Development Clerk

---

**From:** Director of Development <dod@townofcanandaigua.org>  
**Sent:** Friday, July 29, 2016 2:35 PM  
**To:** 'Development Clerk'  
**Subject:** FW: 4788 Co Rd 16  
**Attachments:** DOC072916.pdf

**Doug Finch**, Director of Development  
Town of Canandaigua  
5440 Route 5 & 20 West  
Canandaigua, NY 14424  
P: (585)394-1120 x2234  
F: (585)394-9476

---

**From:** Chris Lyon Town of Cdga Assessor [mailto:assessor@townofcanandaigua.org]  
**Sent:** Friday, July 29, 2016 10:46 AM  
**To:** dod@townofcanandaigua.org  
**Subject:** 4788 Co Rd 16

On 7/27/2016 I performed a physical interior and exterior inspection of 140.14-1-14.211 4788 Co Rd 16. As a result of that inspection, overall room count, bedroom count, and square footage have been revised. Current inventory reflects these changes: 8 rooms, 5 bedrooms, 3 full baths, 1 half bath, and 2448 sq/ft of living area. Attached is a sketch of the building including room layout.

*Christopher Lyon, IAO*  
*Town of Canandaigua Assessor*  
*585-394-1120 x 2237*

*Christopher Lyon, IAO*  
*Town of Canandaigua Assessor*  
*585-394-1120 x 2237*

# Sketch

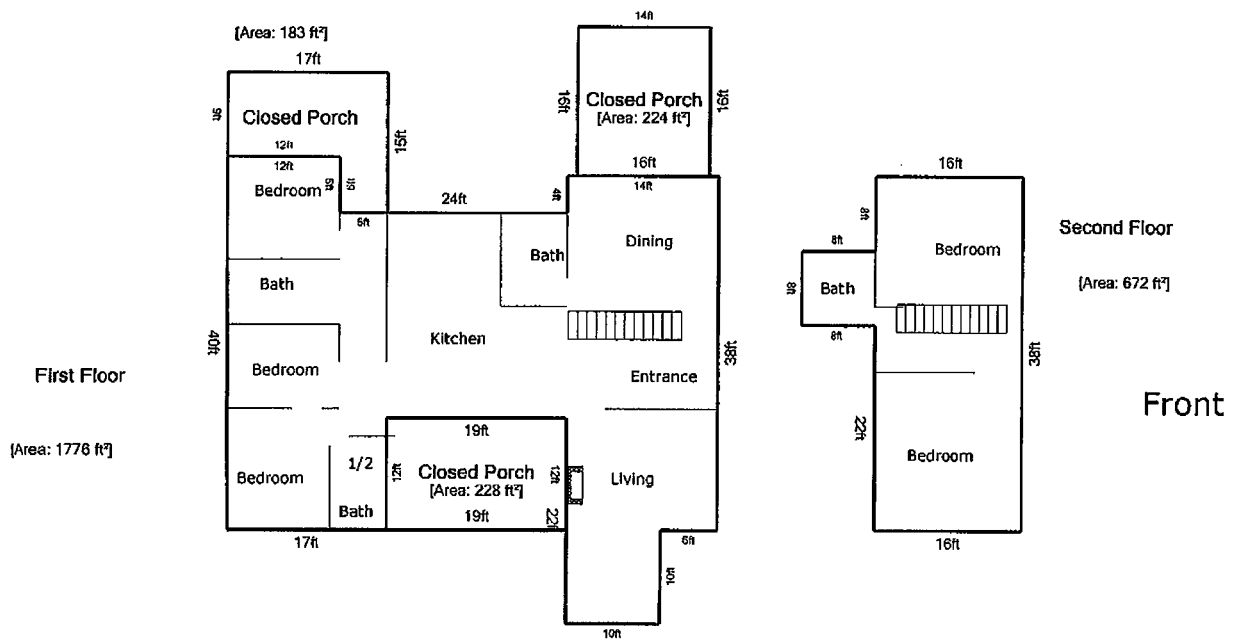

20 ft

Living Area		Area Calculation			
First Floor	1776 ft <sup>2</sup>	First Floor			
Second Floor	672 ft <sup>2</sup>	x 1.00 = 1776 ft <sup>2</sup>			
Nonliving Area					
Closed Porch	183 ft <sup>2</sup>	6ft x 12ft	12ft x 10ft	1.00 =	72 ft <sup>2</sup>
Closed Porch	224 ft <sup>2</sup>	38ft x 16ft	10ft x 10ft	1.00 =	100 ft <sup>2</sup>
Closed Porch	228 ft <sup>2</sup>	19ft x 22ft	16ft x 10ft	1.00 =	608 ft <sup>2</sup>
		17ft x 34ft	22ft x 10ft	1.00 =	418 ft <sup>2</sup>
				1.00 =	578 ft <sup>2</sup>
		Second Floor			
		x 1.00 = 672 ft <sup>2</sup>			
		8ft x 8ft	8ft x 8ft	1.00 =	64 ft <sup>2</sup>
Total Living Area (rounded):	2448 ft <sup>2</sup>	38ft x 16ft	16ft x 10ft	1.00 =	608 ft <sup>2</sup>