

LEGEND

✕ Iron pin or pipe found

✕ Iron pin set

● Drill hole

↔ Utility pole

— E/T

— E/T

— Property lines

— Centerline

— Contour

▲ P.K. nail found

▲ P.K. nail set

□ Concrete Monument

⊕ Benchmark

Utility lines

E/T R.O.W. line

Property lines

Centerline

Contour

◯ TREE

◯ SHRUB / PERENNIAL

GROUND COVER

LANDSCAPE MOW STRIP, MATERIAL AS SELECTED BY OWNER

LAWN, SEE NOTE 11

PLANT SCHEDULE

NOTE: PLANTING PLAN SHALL BE REVIEWED PRIOR TO CONSTRUCTION TO CONFIRM PLANT AVAILABILITY AT TIME OF CONSTRUCTION.

DECIDUOUS TREES			
KEY BOTANICAL NAME	COMMON NAME	COND.	NOTES
BP Betula Papyrifera	Paper Birch	B&B	10-12' Ht.
AC Amelanchier canadensis	ServiceBerry	B&B, CLUMP	8' Ht.
CK Cornus kousa	Kousa Dogwood	B&B, Treeform	8' Ht.

DECIDUOUS SHRUBS			
KEY BOTANICAL NAME	COMMON NAME	COND.	NOTES
DL Diervilla lonicera 'Copper'	Dwarf Bush Honeysuckle	No 3 Cont.	
HP Hydrangea paniculata	Panicle Hydrangea 'Bobo'	No 3 Cont.	
PS Philadelphus 'Snowbelle'	Moonorange	No 5 Cont.	

PERENNIALS AND GROUNDCOVERS			
KEY BOTANICAL NAME	COMMON NAME	COND.	NOTES
GR Geranium x 'Rozanne'	Rozanne Cranesbill	No 2 Cont.	18" oc.
NF Nepeta x faassenii 'Walker's Low'	Walker's Low Catmint	No 2 Cont.	
VM Vinca minor 'Ms. Jekyll'	Periwinkle	4" Cont./Flat	
HS Hosta spp.	Hosta 'Fire Island'	No 2 Cont.	

GENERAL NOTES

- EXISTING CONDITIONS INFORMATION IS TAKEN FROM THE PROPERTY SURVEY PREPARED BY VENEZIA & ASSOCIATES. EXISTING CONDITIONS PLAT PREPARED FOR THE VIOLA FAMILY TRUST AT 3320 FALLBROOK PARK, TOWN OF CANANDAIGUA DATED FEBRUARY 5, 2019.
- CONTOURS DERIVED FROM NAVD88 DATUM
- SURVEY REFERENCE GPS

PLANTING NOTES

- CONTRACTOR SHALL VERIFY ACTUAL GRADE ELEVATIONS, SERVICE AND UTILITY LOCATIONS, AND DIMENSIONS OF PLANTINGS AND CONSTRUCTION CONTIGUOUS WITH NEW PLANTINGS BY FIELD MEASUREMENTS BEFORE PROCEEDING WITH PLANTING WORK.
- ALL PLANTING BEDS SHALL BE PREPARED TO A DEPTH OF 18" AS FOLLOWS:
  - 12" DEPTH SHALL BE A PLANTING MEDIUM CONSISTING OF A MIX OF THREE PARTS EXISTING TOPSOIL AND ONE PART APPROVED ORGANIC COMPOST. THE PLANTING SOIL MIX SHALL HAVE A PH RANGE OF 5.0 TO 7.0.
  - THE SUBSOIL SHALL BE SCARIFIED TO A DEPTH OF 6" BENEATH PLANTING MEDIUM. PLANT TREES, SHRUBS, AND OTHER PLANTS AFTER FINISH GRADES ARE ESTABLISHED AND BEFORE PLANTING LAWN AREAS.
- TOPSOIL AND ORGANIC MATERIAL SOURCES MUST BE APPROVED BY THE OWNER'S REPRESENTATIVE.
- PHOSPHOROUS SHALL NOT BE USED UNLESS SOIL TESTS INDICATE A PHOSPHOROUS DEFICIENCY THAT WILL PREVENT PROPER PLANT AND LAWN ESTABLISHMENT. IF DEEMED NECESSARY, PHOSPHOROUS APPLICATION SHALL BE LIMITED TO THE MINIMUM RECOMMENDED RATES AND IN ACCORDANCE WITH ALL NYS DEC REGULATIONS
- ALL PLANTS MUST MEET OR EXCEED THE STANDARDS OUTLINED IN THE CURRENT EDITION OF ANSI Z260.1, THE AMERICAN STANDARD FOR NURSERY STOCK.
- ALL PLANTS MUST BE APPROVED BY THE OWNER'S REPRESENTATIVE PRIOR TO DELIVERY TO THE SITE.
- PROTECT PLANTS FROM DAMAGE DUE TO TRANSPORTATION, LANDSCAPE OPERATIONS AND OPERATIONS OF OTHER CONTRACTORS AND TRADES. MAINTAIN PROTECTION DURING INSTALLATION PERIODS. TREAT, REPAIR, OR REPLACE DAMAGED PLANTINGS.
- CONTRACTOR SHALL LAY OUT INDIVIDUAL TREE AND SHRUB LOCATIONS AND PLANTING AREAS. ALL PLANT LOCATIONS MUST BE APPROVED BY THE OWNER'S REPRESENTATIVE BEFORE EXCAVATING OR PLANTING. CONTRACTOR SHALL ADJUST THE PLANT LOCATIONS IF DEEMED NECESSARY BY THE OWNER'S REPRESENTATIVE. ALL PLANTING BEDS SHALL RECEIVE 3" OF DOUBLE GROUND SHREDDED HARDWOOD BARK MULCH.
- ALL PLANTS SHALL BE GUARANTEED FOR A PERIOD OF ONE YEAR FROM THE DATE OF ACCEPTANCE BY THE OWNER.
- ALL EXISTING LAWN AREAS DISTURBED BY THIS CONSTRUCTION PROJECT SHALL RECEIVE 4" TOPSOIL MINIMUM AND SHALL BE FINE GRADED AND SEEDED WITH PREFERRED SEEDS "TRIO SUPREME MIX" OR APPROVED EQUAL AT A MINIMUM RATE OF 5 LBS / 1000 SF.
- SEEDING TO BE DONE AT COMPLETION OF SITE GRADING. SEEDING AREAS TO BE MAINTAINED THROUGH FULL ESTABLISHMENT OF HEALTHY GRASS THAT IS FREE OF WEEDS.

Sue Steele Landscape Architecture PLLC

9 Summit Street, Fairport, New York 14450  
(565) 747-9996  
steele.la

**WARNING**  
IT IS VIOLATION OF THE LAW (NEW YORK STATE EDUCATION LAW TITLE 8, ARTICLE 148 AND SUBPART 79-1 OF THE REGULATIONS OF THE COMMISSIONER OF EDUCATION) FOR ANY PERSON, UNLESS ACTING UNDER THE DIRECTION OF A LICENSED LANDSCAPE ARCHITECT TO ALTER ANY ITEM ON A PLAN, SPECIFICATION, OR REPORT TO WHICH THE SEAL OF THE LANDSCAPE ARCHITECT HAS BEEN APPLIED. IF AN ITEM BEARING THE SEAL OF THE LANDSCAPE ARCHITECT IS ALTERED, THE ALTERING LANDSCAPE ARCHITECT SHALL AFFIX TO THIS ITEM THE SEAL AND THE NOTATION "ALTERED BY" FOLLOWING BY HIS SIGNATURE AND THE DATE OF SUCH ALTERATION, AND A SPECIFIC DESCRIPTION OF THE ALTERATION.

Project Name and Address

Violas Family Trust

3320 Fallbrook Park  
Town of Canandaigua, New York

Issue Date

June 14, 2019

No.	Date	Revision
-----	------	----------

Drawing Title

APPROVAL PLANS  
LANDSCAPE PLAN

L-1

Planning Board Chairperson

Date

LANDSCAPE PLAN

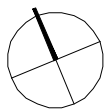
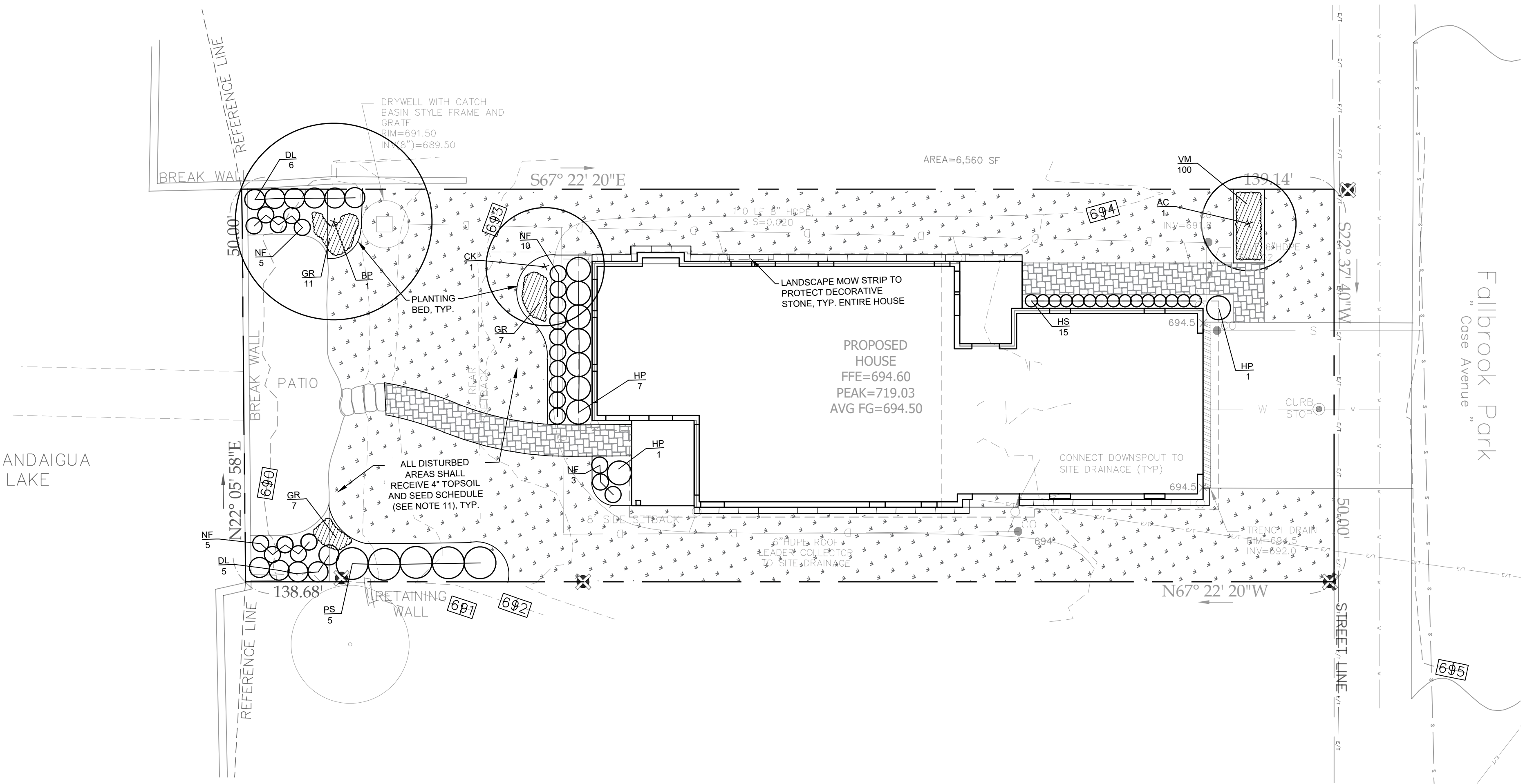

10 5 0 10  
(24x36 Sheet) SCALE 1" = 10'