

NEW GARAGE SITE PLAN PREPARED FOR:

MARC LAJEUNESSE

*MIDDLE CHESHIRE ROAD
TOWN OF CANANDAIGUA
COUNTY OF ONTARIO
STATE OF NEW YORK
AUGUST 8, 2019*

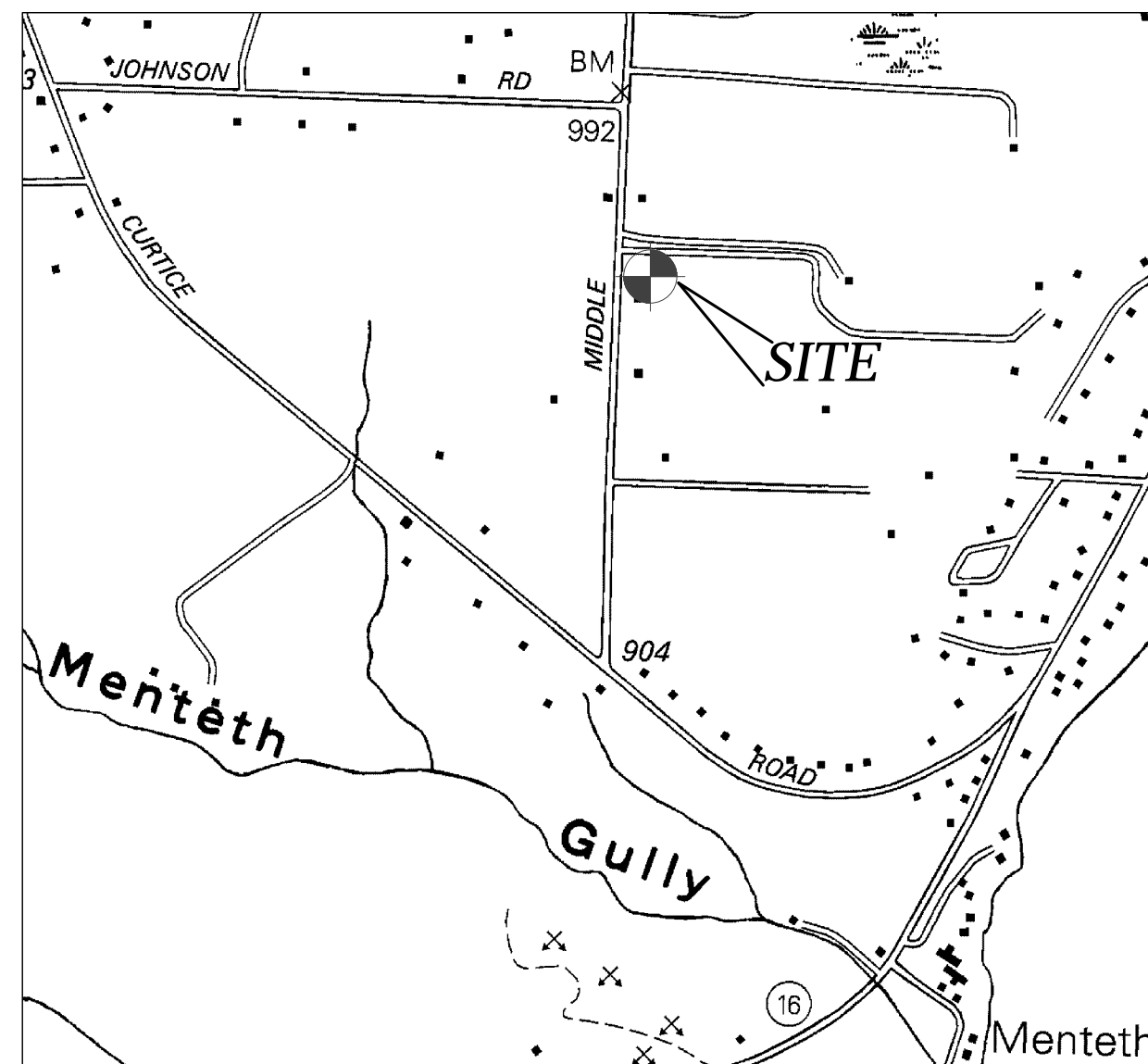

LOCATION MAP
NTS



AERIAL MAP (ONCOR) — FOR REFERENCE ONLY
NTS

*INDEX-
COVER
G001 - GENERAL NOTES
C100 - RESIDENTIAL SITE PLAN
C500 - GENERAL DETAILS*

PREPARED FOR:

MARC LAJEUNESSE

PROPERTY OWNER:

*PAUL J. & TERESA M. BARRY
4531 MIDDLE CHESHIRE ROAD
CANANDAIGUA, NEW YORK*



NOT FOR CONSTRUCTION

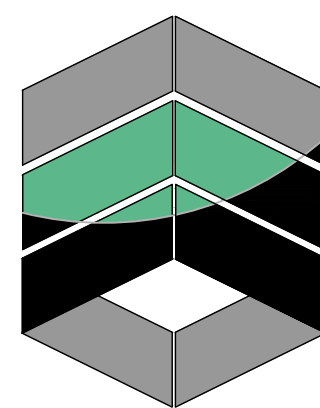

MarksEngineering

*MARKS ENGINEERING, P.C.
42 BEEMAN STREET
CANANDAIGUA, NY 14424
(585)905-0360
WWW.MARKSENGINEERING.COM*

*BRENNAN MARKS, P.E.
BMARKS@MARKSENGINEERING.COM*

SITE NOTES:

1. THE CONSTRUCTION SITE IS NOT WITHIN 100' OF A WETLAND AS DELINEATED BY NYS DEC. THERE ARE NOT NYS DEC DELINEATED OR APPARENT WETLANDS ON THE PROPERTY AS SHOWN.
2. THE CONSTRUCTION SITE IS NOT WITHIN A 100 YEAR FLOODPLAIN AS DELINEATED BY FEMA MAP#3613000 DATED FEBRUARY 27, 1984.
3. WATER SUPPLY: PUBLIC WATER – TOWN OF CANANDAIGUA
4. NYS SPODES PERMIT IS NOT REQUIRED FOR THESE CONSTRUCTION ACTIVITIES. DISTURBANCE SHALL BE LESS THAN ONE ACRE. IF THE CONTRACTOR OR OWNER AT ANY TIME PLAN DISTURB GREATER THAN AN ACRE THE ENGINEER SHALL BE NOTIFIED
5. ALL NEW OUTDOOR LIGHTING ON SHALL HAVE APPROPRIATE SHIELDS AND CUT-OFF TO LIMIT ILLUMINATION OF OTHER PROPERTIES. ALL LIGHTS SHALL BE DARK SKY COMPLIANT.
6. ELEVATION DATUM: NAVD 88 GEOID 128

DRIVEWAY AND GRADING NOTES:

1. DRIVEWAY SHALL NOT EXCEED 12% TRAVERSING SLOPE AND 2% CROSS SLOPE.
2. DRIVEWAY SHALL BE MINIMUM 12 FEET IN WIDTH.
3. DRAINAGE SWALES SHALL HAVE A MINIMUM DEPTH OF 12" AND MINIMUM WIDTH OF 4'. SWALES SHALL HAVE A LINEAR SLOPE OF MINIMUM 2% (1' RISE PER 50' RUN) AND MAXIMUM SIDE SLOPE OF 1' RISE PER 3' RUN.
4. ALL WORK WITHIN RIGHT-OF-WAY SHALL BE PERMITTED BY NYS DOT AND COORDINATE W/ INSPECTOR.

EROSION AND SEDIMENT CONTROL NOTES:

1. THE CONTRACTOR IS RESPONSIBLE FOR THE CONTROL OF EROSION AND SEDIMENTATION DURING CONSTRUCTION. SILT FENCE SHALL BE INSTALLED AND MAINTAINED AS NEEDED.
2. SOIL DISTURBANCES SHALL BE STABILIZED IMMEDIATELY. DISTURBED SOIL THAT WILL REMAIN LONGER THAN 14 DAYS SHALL BE TEMPORARILY STABILIZED WITHIN 7 DAYS. SOIL SHALL BE STABILIZED WITH NORTHERN GRASS SEED MIXTURE OR APPROPRIATE SEED MIXTURE FOR CONDITIONS. GRASS SEED SHALL BE INSTALLED PER MANUFACTURES SPECIFICATIONS. MULCH STRAW APPLIED AT A RATE OF 2 BALES / 1000 SQFT OR SEED MIXTURE TO PROTECT SITE UNTIL SEED GERMINATES. HYDRO-SEED MAY BE INSTALLED AS AN ALTERNATE.
3. CONTRACTOR SHALL INSPECT THE SITE DAILY FOR SIGNS OF EROSION. IF ANY EROSION OR SEDIMENTATION OCCUR CONTRACTOR SHALL IMMEDIATELY PROVIDE PROPER CONTROLS TO STABILIZE THE SITE. ENGINEER WILL RECOMMEND CONTROLS IF REQUIRED.
4. SLOPE GREATER THAN 4 ON 1 SHALL BE STABILIZED WITH LUTE FABRIC INSTALLED AS PER MANUFACTURES SPECIFICATIONS AS REQUIRED.
5. ALL EROSION AND SEDIMENTATION CONTROL MEASURES SHALL BE IN STALLED IN ACCORDANCE WITH NYS STANDARDS AND SPECIFICATIONS FOR EROSION AND SEDIMENTATION CONTROLS.
6. INSTALL AND MAINTAIN TEMPORARY DIVERSION SWALES AS NEEDED TO CONTROL RUNOFF DURING CONSTRUCTION.
7. THE SITE SHALL BE COMPLETELY STABILIZED FOLLOWING CONSTRUCTION ACTIVITIES AND ALL TEMPORARY EROSION CONTROL DEVICES SHALL BE REMOVED AND DISPOSED OF PROPERLY.

GENERAL NOTES:

1. THE CONTRACTOR SHALL MAINTAIN ALL UTILITIES AND PROPERTY MARKERS. IT IS THE NYS LAW TO CALL NYS DIG SAFE FOR UFOPO (811) PRIOR TO ANY EXCAVATION.
2. THE ROADWAY SHALL BE KEPT FREE OF DEBRIS DURING CONSTRUCTION.
3. THE CONTRACTOR IS RESPONSIBLE FOR SAFETY CONTROL DEVICES. SUCH DEVICES (BARRICADES, FENCING, ETC.) SHALL BE IMPLEMENTED TO MINIMIZE RISK OF INJURY TO PEDESTRIANS AND WORKERS. CONSTRUCTION ACTIVITY SHALL BE CONDUCTED WITHIN COMPLIANCE WITH OSHA GUIDELINES.
4. PLANS ARE GRAPHIC REPRESENTATIONS OF WORK TO BE PERFORMED. THESE PLANS ARE TO INTENDED TO CONVEY ENGINEERING INFORMATION ONLY.
5. CONTRACTOR TO VERIFY ALL LOCATIONS, GRADES AND INVERTS AND NOTIFY ENGINEER OF ANY DISCREPANCIES PRIOR TO THE START OF WORK.
6. ALL SPECIFIED MATERIALS ARE TO BE INSTALLED AS PER MANUFACTURES RECOMMENDATIONS OR INDUSTRY STANDARD.
7. ANY SYSTEM MODIFICATIONS OR DEVIATIONS FROM THE APPROVED PLANS, NYS BUILDING CODES, AND/OR LOCAL REGULATIONS REQUIRED BY SITE CONSTRAINTS, UNFORESEEN CONDITIONS OR GOVERNING AUTHORITIES WILL BE DONE AT THE RISK OF THE CLIENT.

LANDSCAPING PLAN NOTES:

- 1.ONE YEAR GUARANTEE TO BE PROVIDED BY THE CONTRACTOR ON ALL PLANT MATERIAL FROM DATE OF FINAL ACCEPTANCE.
2. ALL EXISTING PAVEMENT, BASE STONE AND UNSUITABLE SUBGRADE MATERIAL IN NEW PLANTING BEDS TO BE REMOVED TO PROVIDE DEPTH FOR SUITABLE PLANTING BACKFILL MATERIAL AS DIRECTED AND APPROVED BY THE ENGINEER.
3. ALL PLANTS SHALL MEET OR EXCEED THE REQUIREMENTS SET FORTH IN THE LATEST EDITION OF THE AMERICAN STANDARD FOR NURSERY STOCK BY THE AMERICAN ASSOCIATION OF NURSERYMEN, ANSI Z60.1.
4. PLANTING BACKFILL MIXTURE TO CONSIST OF 4 PARTS TOPSOIL AND 1 PART PEAT MOSS. PROVIDE 10 LBS. OF 5-10-5 FERTILIZER PER 1 CUBIC YARD OF PLANTING BACKFILL TO A MINIMUM DEPTH OF 2'-0".
5. LANDSCAPING CONTRACTOR IS RESPONSIBLE FOR OBTAINING ALL NECESSARY PERMITS AND BONDS FOR ALL LANDSCAPING WORK IF REQUIRED BY THE TOWN OF CANANDAIGUA.
6. LANDSCAPING CONTRACTOR WILL INFORM THE ENGINEER/LANDSCAPE ARCHITECT ABOUT ENCOUNTERING ANY UNDERGROUND UTILITIES OR STRUCTURES NOT PREVIOUSLY IDENTIFIED OR FIELD LOCATED.
7. ALL SHRUB PLANTING BEDS TO RECEIVE 2" LAYER OF CLEAN, WASHED PEA GRAVEL MULCH ON PERMEABLE WEED BARRIER.
8. ALL PERMANENT LAWN AREAS ARE TO RECEIVE 6" OF TOPSOIL AND THE FOLLOWING LAWN SEED MIX:
65% KENTUCKY BLUEGRASS AT 2.5 LBS PER 1,000 S.F.
20% PERENNIAL RYEGRASS AT 1.0 LBS PER 1,000 S.F.
15% FINE FESCUE AT 0.6 LBS PER 1,000 S.F.

SEPTIC TANK NOTES:

1. A NEW 1250 GAL 2 COMPARTMENT CONCRETE AS MANUFACTURED BY KISTNER OR EQUAL SHALL BE INSTALLED ON MIN 12" OF COMPACTED CLEAN SAND OR 5" WASHED AGGREGATE 3/4-1 1/2". TANK SHALL BE INSTALLED PER MANUFACTURES RECOMMENDATIONS.
2. PROVIDE PRECAST 7-HOLE DISTRIBUTION BOX SET ON MIN 12" COMPACTED SAND.
3. PROVIDE RISER ON TANKS IF BURIED AT A DEPTH MORE THAN 12".
4. MAINTENANCE: SEPTIC TANK SHALL BE INSPECTED ANNUALLY TO DETERMINE SCUM AND SOLIDS ACCUMULATION. MOST TANKS SHOULD BE PUMPED OUT EVERY 2-3 YEARS. SEPTIC TANKS MUST BE PUMPED OUT WHENEVER THE BOTTOM OF THE SCUM LAYER IS WITHIN 3" OF THE BOTTOM OF THE OUTLET BAFFLE OR THE TOP OF THE SLUDGE IS WITHIN 10" OF THE BOTTOM OF THE OUTLET BAFFLE.

WASTEWATER TREATMENT SYSTEM NOTES:

1. THESE PLANS ARE PREPARED IN COMPLIANCE WITH THE PUBLIC HEALTH LAW, APPENDIX 75-A, OF PART 75, OF THE ADMINISTRATIVE RULES AND REGULATIONS CONTAINED IN CHAPTER 10, OF TITLE 10 (HEALTH) OF THE OFFICIAL COMPIATION OF CODES, RULES, AND REGULATIONS OF THE STATE OF NEW YORK.
2. ABSORPTION TRENCHES SHALL BE INSTALLED PARALLEL TO CONTOURS. CONTOURS SHOWN ARE GRAPHIC REPRESENTATIONS OF SITE. CONTRACTOR IS TO VERIFY GRADE AND LAYOUT OF ABSORPTION TRENCH PRIOR TO CONSTRUCTION.
3. AT NO TIME SHALL ANY MACHINERY OR VEHICLE DRIVE OVER TRENCHES. TRACKED EQUIPMENT CAN BE DRIVEN PERPENDICULAR TO TRENCHES AS REQUIRED TO BACKFILL BUT NOT IN EXCESS.
4. THE CONTRACTOR IS TO NOTIFY ENGINEER AFTER COMPLETION OF WORK, WHILE SYSTEM IS OPEN AND SCHEDULE FINAL INSPECTION. AFTER FINAL INSPECTION BY THE ENGINEER, THE SYSTEM MAY BE CLOSED.
5. THE SYSTEM SITE IS TO BE SEEDED, MULCHED, AND RETURNED TO THE VEGETATIVE STATE AS SOON AS POSSIBLE.
6. THE SYSTEM IS TO BE KEPT MOWED AT ALL TIMES, FREE OF TRAFFIC OR HEAVY WHEELED VEHICLES, AND FREE OF SHRUB OR TREE CANOPY FOR THE DURATION OF ITS USE.
7. DO NOT ATTEMPT TO INSTALL SYSTEM ON FROZEN GROUND, WET CONDITIONS OR LEAVE SYSTEM UNCOVERED FOR EXTENDED PERIODS OF TIME.
8. NO HOT TUBS, SAUNAS, ROOF DRAINS, WATER CONDITIONING BACKWASH SYSTEMS, SUMP CROCKS ETC. SHALL BE INCORPORATED INTO THIS SYSTEM UNLESS OTHERWISE SPECIFIED.
9. EXPANSION AREA SHALL REMAIN CLEAR OF ALL LANDSCAPING, SHRUBS, TREES, AND STRUCTURES. THE EXPANSION AREA SHALL BE MAINTAINED AS LAWN. FUTURE ACCESS TO THIS AREAS SHALL NOT BE LIMITED.
10. SOIL PIPE AND HOUSE SHALL BE VENTED THROUGH THE ROOF OF THE NEW DWELLING W/ AT LEAST ONE 3" VENT MAXIMUM OF 4' HORIZONTALLY AWAY FROM INSIDE OF FOUNDATION WALL. A 4" CLEAN-OUT SHALL BE PROVIDED AT A POINT JUST INSIDE THE FOUNDATION WALL.
11. A SYSTEM SHALL NOT BE BUILT IN UNSTABILIZED FILL MATERIAL. THE FILL MATERIAL SHALL BE ALLOWED TO SETTLE NATURALLY FOR A PERIOD OF AT LEAST SIX MONTHS TO INCLUDE ONE FREEZE-THAW CYCLE OR MAY BE STABILIZED BY MECHANICAL COMPACTION IN SHALLOW LIFTS IF A FILL MATERIAL CONSISTING OF ONLY A GRANULAR SAND OR SANDY LOAM IS USED.
12. THE ABSORPTION TRENCHES SHALL BE CONSTRUCTED IN THE FILL MATERIAL.
13. THE ENTIRE SURFACE OF THE SYSTEM INCLUDING THE TAPERS SHALL BE COVERED WITH A MINIMUM OF SIX INCHES OF TOPSOIL, MOUNDING TO ENHANCE THE RUNOFF OF RAINWATER FROM THE SYSTEM AND SEEDED TO GRASS.
14. PERCOLATION TESTS SHALL BE CONDUCTED IN THE FILL MATERIAL AT THE BORROW PIT AND AFTER PLACEMENT AND SETTLING AT THE CONSTRUCTION SITE. THE SLOWER PERCOLATION RATE OF THESE TESTS SHALL BE USED FOR DESIGN PURPOSES.

UTILITY NOTES:

- 1) CONTRACTOR SHALL VERIFY LOCATION OF EXISTING SERVICE AND COORDINATE ALL WORK W/ UTILITY PROVIDERS. RELOCATE WATER AND SANITARY PIPING AS REQUIRED.
- 2) ELEC SERVICE AND COMMUNICATION SHALL MEET CURRENT NATIONAL ELECTRIC CODE.

GRADING NOTES:

1. CUT AND FILL SLOPES SHALL NOT EXCEED 3 ON 1.
2. CONSTRUCTION SHALL CONFORM TO THE TOWN OF CANANDAIGUA AND NYS CODES AND STANDARDS
3. SITE SHALL BE GRADED SUCH THAT THERE IS POSITIVE DRAINAGE AT A MINIMUM OF 2% AWAY FROM ANY BUILDINGS, STRUCTURES, DRIVEWAYS, AND SEPTIC SYSTEM.
4. TOPSOIL SHALL BE STRIPPED OF AREAS PLANNED FOR CONSTRUCTION AND REAPPLIED AFTER GRADING IS FINISHED. ANY UNUSED TOPSOIL SHALL BE HAULED OFF SITE.

CONSTRUCTION SEQUENCE:

1. INSTALL TEMPORARY EROSION CONTROL MEASURES INCLUDING BUT NOT LIMITED TO: SILT FENCE, STABILIZED ENTRANCES, ETC.
2. THE CONTRACTOR SHALL SELECTIVELY REMOVE VEGETATION AND ROOTS AS REQUIRED.
3. PLACE SILT FENCE FOR STOCKPILE AREA
4. STRIP TOPSOIL.
5. CONSTRUCT BUILDING AND INSTALL UTILITIES
6. MAINTAIN EROSION CONTROL PRACTICES AS NECESSARY. IF ADDITIONAL MEASURE ARE REQUIRED THESE SHALL BE PROVIDED AT THE EXPENSE OF THE OWNER OR CONTRACTOR.
7. IN THE EVENT THERE IS A SEDIMENT DISCHARGE OR FAILURE THE CONTRACTOR OR OWNER SHALL BE RESPONSIBLE FOR RESTORATION.
8. FINAL GRADE SEED AND MULCH DISTURBED AREAS AS SOON AS POSSIBLE.
9. REMOVE TEMPORARY EROSION CONTROLS AFTER AREAS ARE STABILIZED WITH VEGETATION, STONE OR ASPHALT.

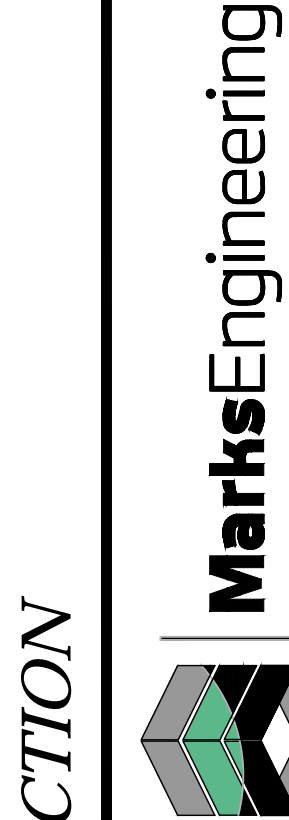
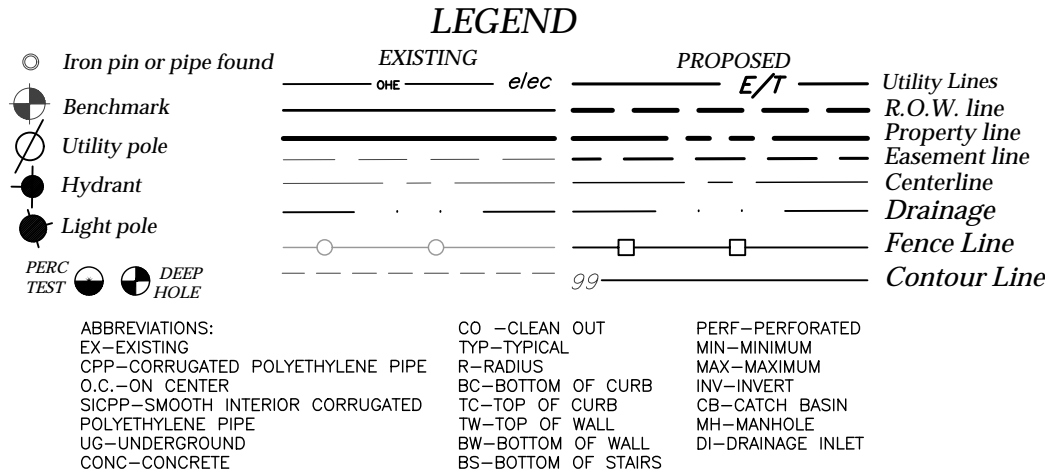

MarksEngineering

42 BREMAN ST.
CANANDAIGUA, NY 14424
Phone: 585-905-0880
Fax: 585-485-6805
www.marksengineering.com
marks@marksengineering.com



STAMP

REVISIONS AND APPROVALS

NO.	DATE	DESCRIPTION OF REVISION OR APPROVAL	BY
1	8/18/19	TOWN OF CANANDAIGUA	KRB

NEW GARAGE SITE PLAN
MARC LAJEUNESSE
SHOWING LAND IN:
MIDDLE CHESHIRE ROAD
TOWN OF CANANDAIGUA

STATE OF NEW YORK

COUNTY OF ONTARIO

DRAWING TITLE:
GENERAL NOTES

DRAWN BY:	KRB
DESIGNED BY:	
CHECKED BY:	BAM
SCALE:	1"=80'
JOB NO.:	19-126
DATE:	08/09/2019
TAX MAP#:	126.00-1-23.112

G001

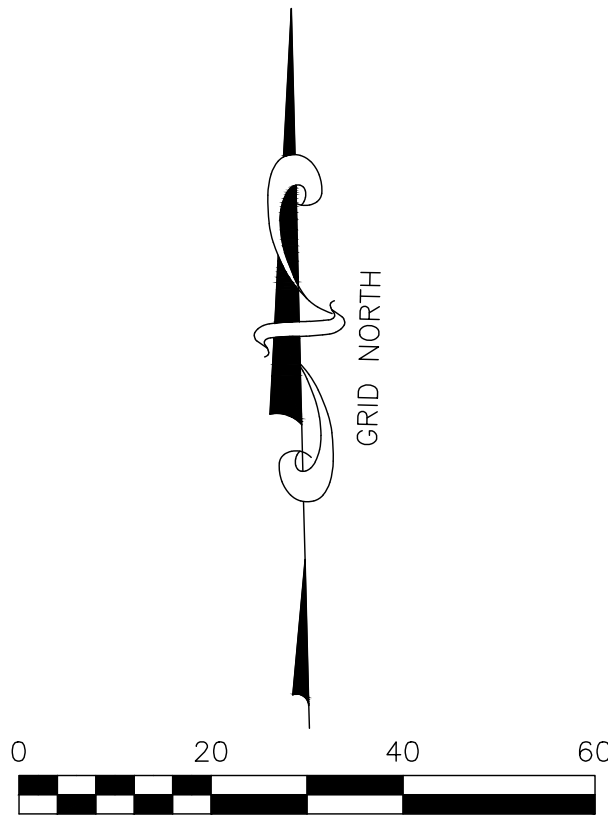

WASTEWATER TREATMENT BASIS OF DESIGN (PER NYS APPENDIX 75-A):
NUMBER OF BED ROOMS DESIGNED FOR..... 3 BR
TABLE 1 DESIGN FLOW RATE..... 390 GPD
TABLE 2-SEPARATION DISTANCES ALL MINIMUMS MET
TABLE 3-SEPTIC TANK1250GAL 2 COMPARTMENT
TABLE 4A-REQUIRED ABSORPTION TRENCH 244 FEET

PROPOSED TREATMENT METHOD:
SHALLOW ABSORPTION TRENCH SYSTEM USING LOW PROFILE GRAVELLESS
ABSORPTION CHAMBERS. ABSORPTION TRENCH LENGTH 280 FEET PROVIDED.
EXPANSION AREA PROVIDED.

SOILS ANALYSIS DATA:
SOIL ANALYSIS DATA WAS COLLECTED IN THE SUMMER DURING DRY WEATHER.
SITE SOILS ARE CLAY LOAM. THE SOIL APPEARED TO BE WELL DRAINED
BELOW TOPSOIL.

DEEP HOLE & PERC TEST DATA GATHERED BY BMARKS DATED 8/8/19

DEEP HOLE #1
HORIZON A 0"-12" ROOTED TOP SOIL
HORIZON B 12"-24" LIGHT BROWN CLAY LOAM
HORIZON C 24"-48" LIGHT GRAY CLAY

HIGH SEASONAL GROUND WATER OBSERVED AT 27" DEPTH

PERC TEST

PT#1 - STABILIZED AT 13 MINS
PT#2 - STABILIZED AT 13 MINS

AGRICULTURAL NOTE:

THIS PROPERTY IS LOCATED WITHIN AN ESTABLISHED
AGRICULTURAL DISTRICT CONTAINING A FARM OPERATION.
RESIDENTS SHOULD BE AWARE THAT SUCH FARM
OPERATIONS MAY GENERATE DUST, ODOR, SMOKE, NOISE
VIBRATION AND OTHER ACTIVITIES WHICH MAY BE
COMPATIBLE WITH RESIDENTIAL USE OF THIS PROPERTY.

PIPE INVERTS & ELEVATION TABLE
SOIL PIPE @ FOUNDATION = 966.01
SEPTIC TANK INLET = 965.81
SEPTIC TANK OUTLET = 965.56
D-BOX INLET = 965.12
D-BOX OUTLET = 964.94
INLET TO LEACH LINES = 964.78
BOTTOM OF CHAMBERS = 964.50
FINISHED GRADE AT TOP OF CHAMBER = 965.67
HIGH GROUND WATER = 962.25

TOWN OF CANANDAIGUA ZONING		
ZONING/USE - PRINCIPAL	PROPOSED SINGLE FAMILY RESIDENCE	REQUIRED AR-2 AGRICULTURAL
FRONT SETBACK	90.00'	60'
SIDE SETBACK	52.00'	25'
REAR SETBACK	176.99	40'
MAX. BUILDING HEIGHT	30'	35'
MAXIMUM LOT COVERAGE	0.5%	20%

MAP REFERENCE

1. MAP NO. 35455 FILED AT THE ONTARIO COUNTY CLERKS OFFICE
2. ELEVATION DATUM OF NAVD 88 GEOID 12B
3. HORIZONTAL DATUM OF NAD83 NEW YORK CENTRAL

PLANNING BOARD
CHAIRMAN

DATE

WATER SUPERINTENDENT

DATE

LEGEND

○ Iron pin or pipe found
● Benchmark
○ Utility pole
● Hydrant
● Light pole
PERC TEST
DEEP HOLE

EXISTING
ok

PROPOSED
elec
E/I

Utility Lines
R.O.W. line
Property line
Easement line
Centerline
Drainage
Fence Line
Contour Line

ABBREVIATIONS:
EX-EXISTING
CYP-CORRUGATED POLYETHYLENE PIPE
C.C.-ON CENTER
SICPP-SMOOTH INTERIOR CORRUGATED
POLYETHYLENE PIPE
UG-UNDERGROUND
CONC-CONCRETE

CO - CLEAN OUT
TYP-TYPICAL
R-RADIUS
BC-BOTTOM OF CURB
TC-TOP OF CURB
TW-TOP OF WALL
BW-BOTTOM OF WALL
BS-BOTTOM OF STAIRS

PERF-PERFORATED
MIN-MINIMUM
MAX-MAXIMUM
INV-INVERT
CB-CATCH BASIN
MH-MANHOLE
DI-DRAINAGE INLET

(66' ROW)
MIDDLE CHESHIRE ROAD

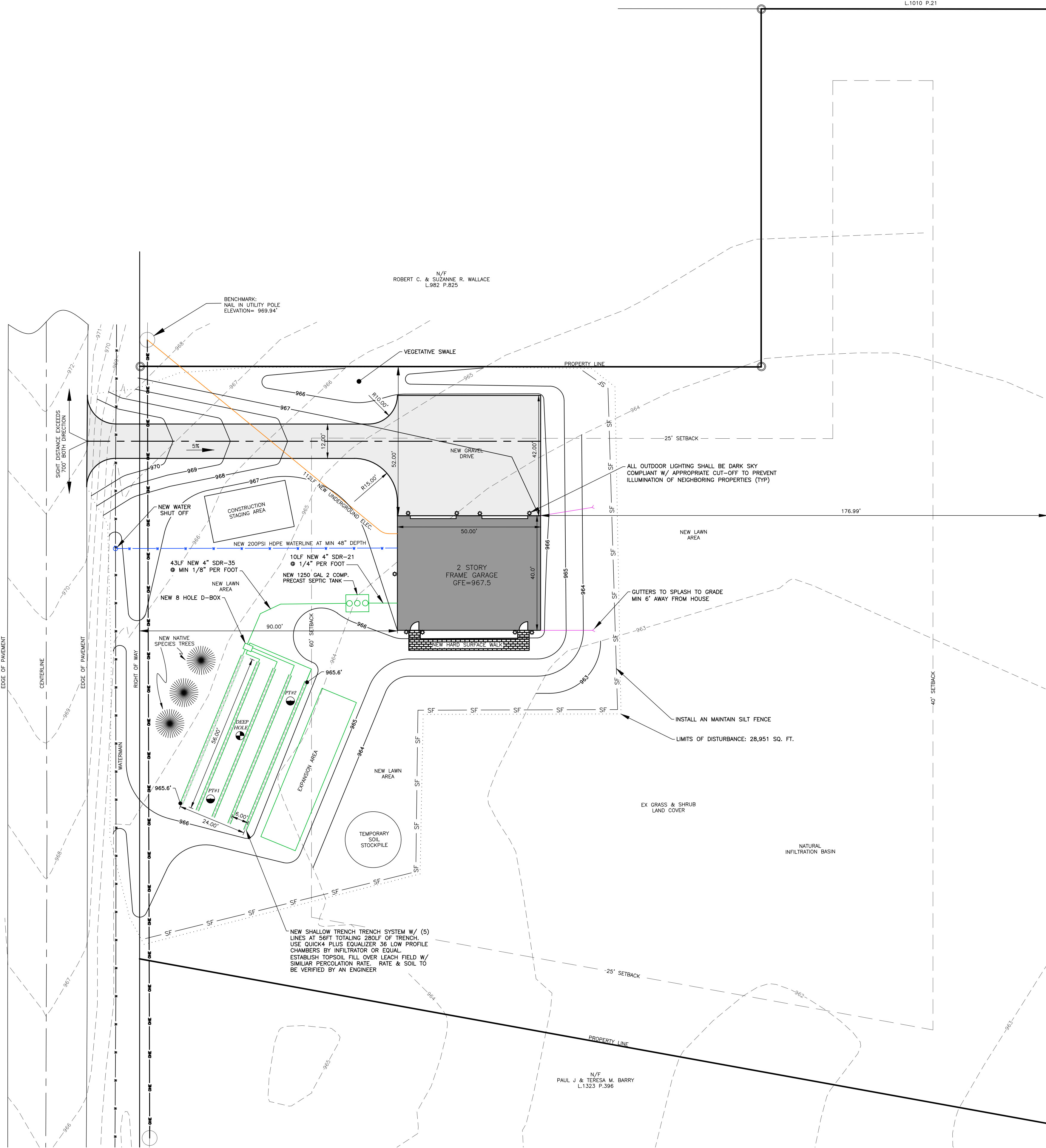

1 NEW GARAGE SITEPLAN
1"=20'

MarksEngineering

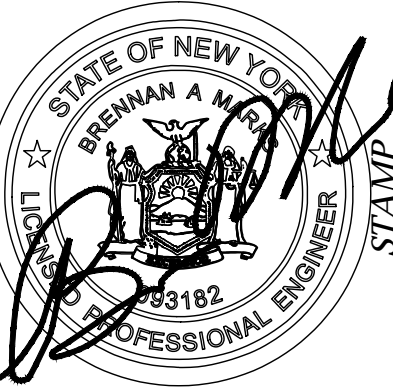
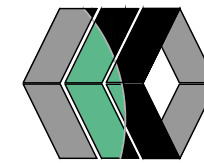

STAMP

REVISIONS AND APPROVALS

NO	DATE	DESCRIPTION OF REVISION OR APPROVAL	BY
1	8/8/19	TOWN OF CANANDAIGUA	KRB

NEW GARAGE SITE PLAN
MARC LAJEUNESSE
SHOWING LAND IN:
MIDDLE CHESHIRE ROAD
TOWN OF CANANDAIGUA

STATE OF NEW YORK

COUNTY OF ONTARIO

DRAWING TITLE:
SITE PLAN

DRAWN BY:	KRB
DESIGNED BY:	KRB
CHECKED BY:	BAM
SCALE:	NOTED
JOB NO.:	19-126
DATE:	08/09/2019
TAX MAP#:	126.00-1-23.112

C100

COPYRIGHTS RESERVED. THIS SHALL NOT BE COPIED OR ALTERED IN ANY MANNER WITHOUT WRITTEN PERMISSION FROM MARKS ENGINEERING P.C. ALL PLANS ARE PART OF AN AGREEMENT THAT IS SUBJECT TO TERMS AND CONDITIONS SET FORTH IN THE MARKS ENGINEERING P.C. www.marksengineering.com

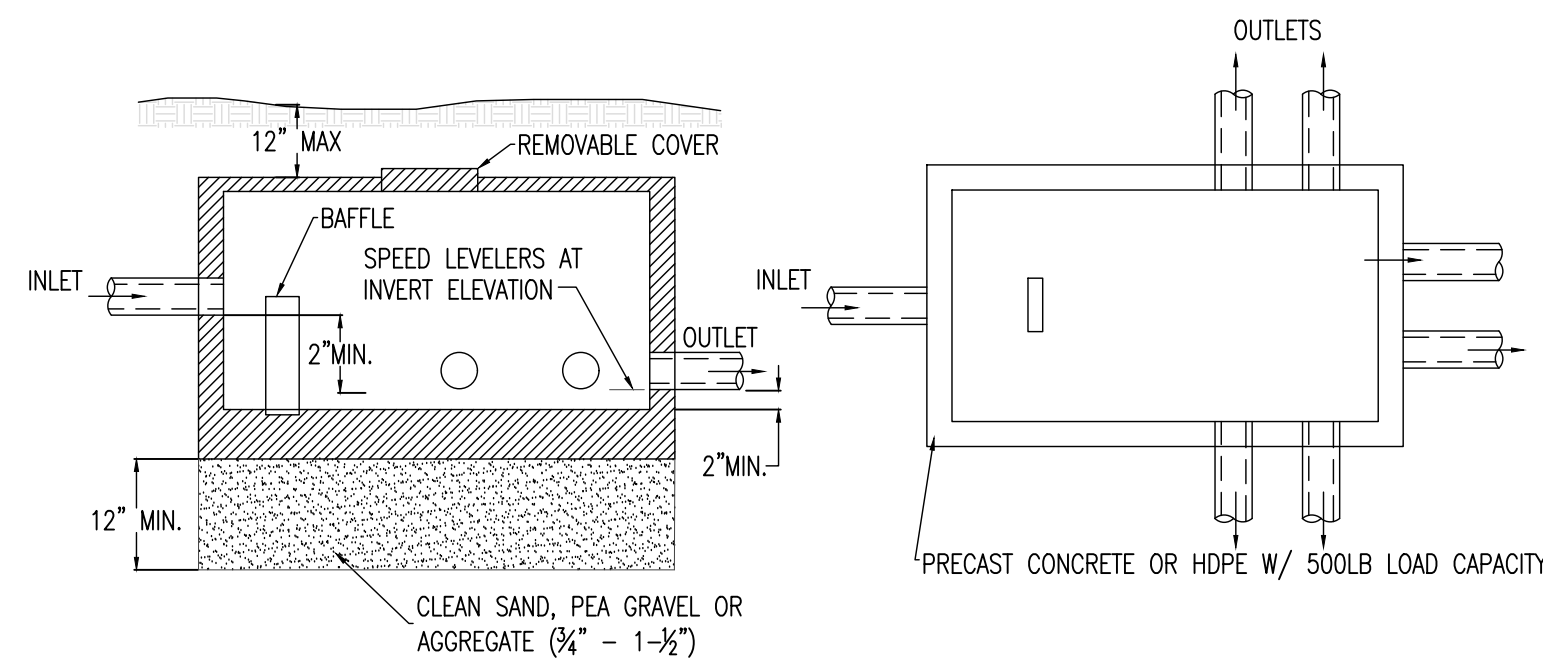

1 TYPICAL D-BOX
NTS

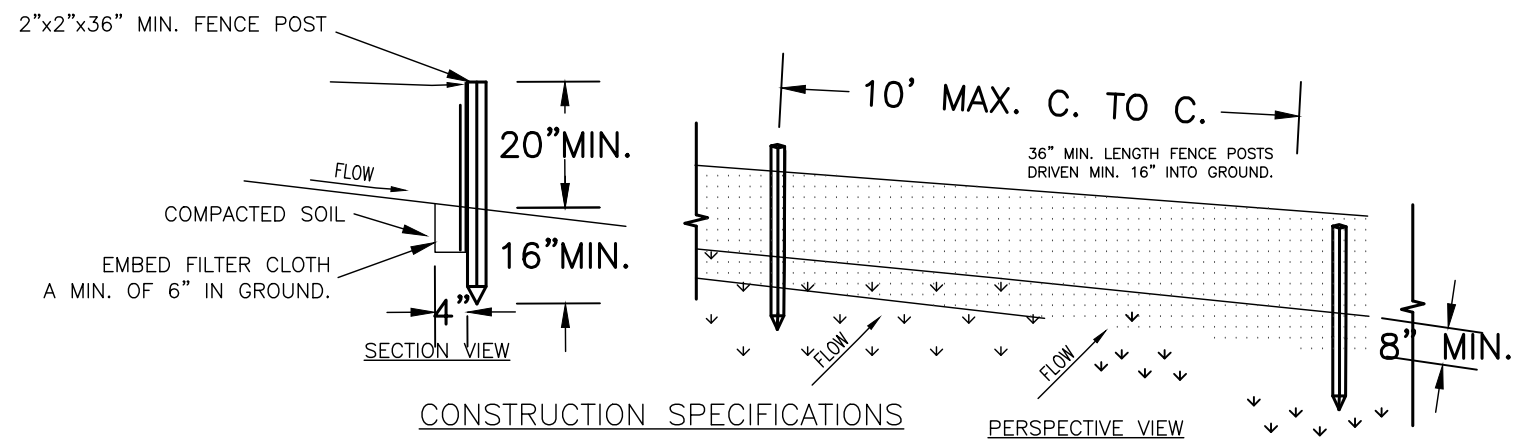

2 TYPICAL SILT FENCE DETAIL
NTS

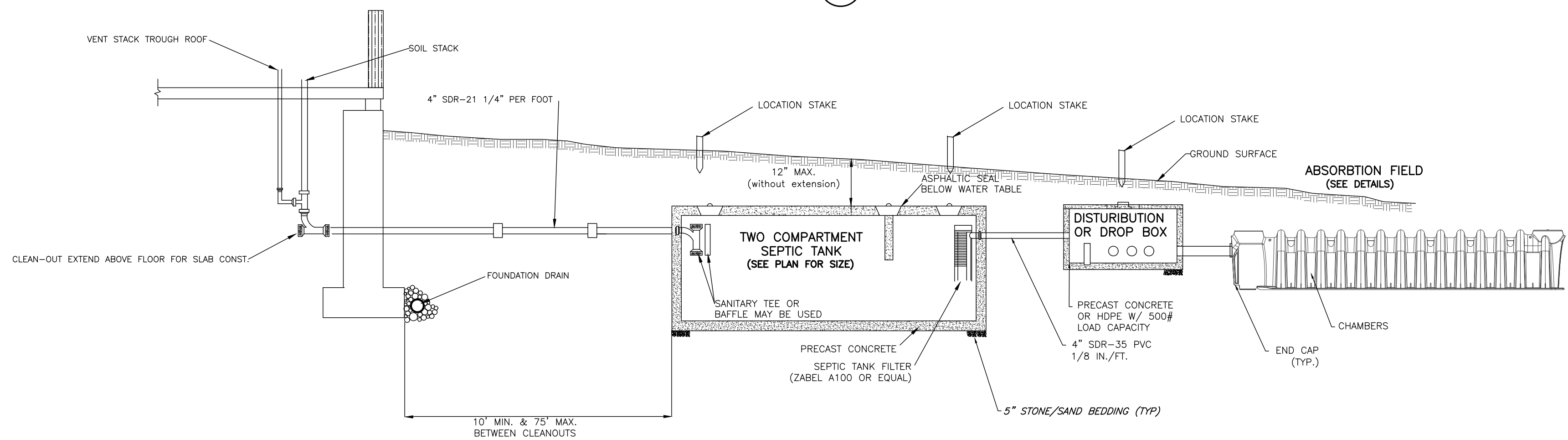

4 TYPICAL HOUSE/SEPTIC TANK DETAIL
NTS

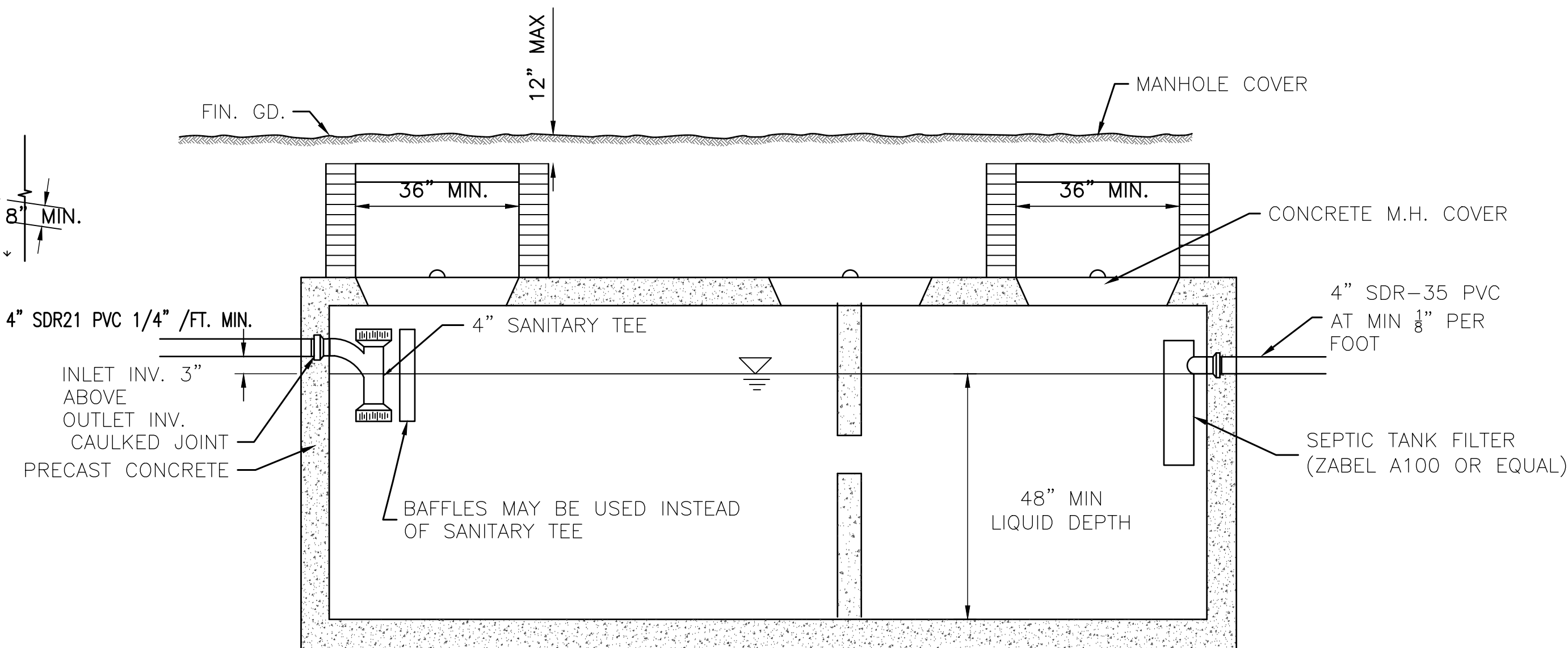

3 TYPICAL SEPTIC TANK DETAIL
NTS

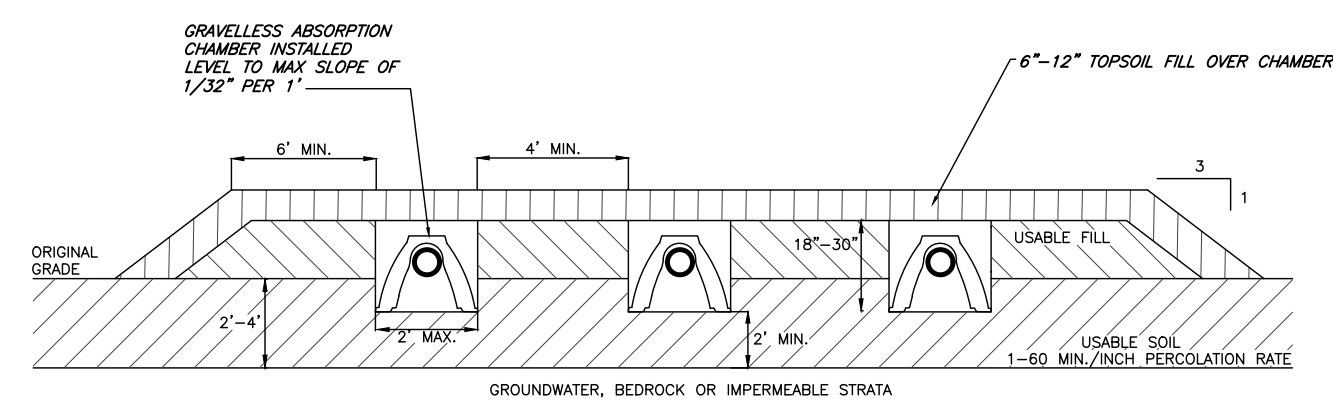

- DETAIL 3 NOTES
1. BOTTOM OF ALL TRENCHES SHALL BE KEYED INTO ORIGINAL USABLE SOIL A MINIMUM OF 6" AND TRENCHES SHOULD PREFERABLY BE AT LEAST 18-24" BELOW ORIGINAL GRADE.
 2. USABLE FILL SHOULD HAVE A PERCOLATION RATE SIMILAR TO BUT NOT FASTER THAN THE USABLE SOIL PERCOLATION RATE.
 3. MAXIMUM DEPTH OF USABLE FILL PLUS SIX INCHES OF TOPSOIL SHALL NOT EXCEED 30".
 4. TRENCH BOTTOMS SHALL BE LEVEL. TRENCHES SHALL BE PARALLEL TO GROUND CONTOURS.
 5. ON SLOPED SITES, A DIVERSION DITCH SHALL BE CONSTRUCTED UPHILL FROM THE FILL TO PREVENT SURFACE RUNOFF FROM ENTERING THE FILL.
 6. FILL SHALL EXTEND AT LEAST SIX FEET BEYOND ENDS OF TRENCHES BEFORE STARTING 1 ON 3 EDGES OF FILL.

5 TYPICAL GRAVELLESS SHALLOW ABSORPTION TRENCH DETAIL
NTS

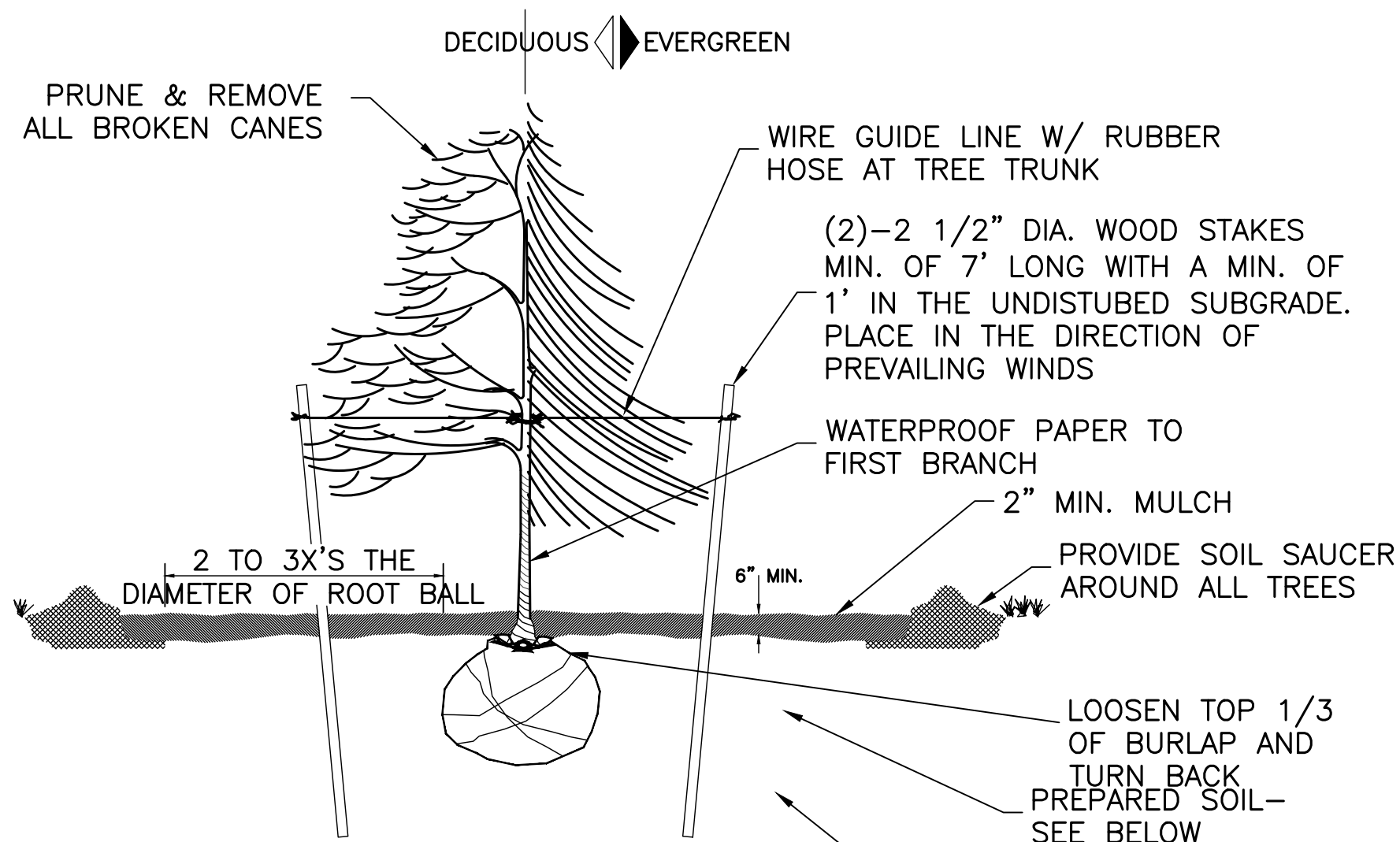

NOTE:
WHEN BACKFILLING AROUND ALL ROOT BALLS WITH ON-SITE SOILS, ADD 1-2 CU.FT. OF 'AL-GRO' OR EQUAL (COMPOSTED SOIL AMENDMENT) AND 'GELScape' WATER ABSORBANT GRANULES IN QUANTITY AS RECOMMENDED BY THE MANUFACTURER FOR TREES AND SHRUBS.

6 DECIDUOUS & EVERGREEN TREE PLANTING
NOT TO SCALE

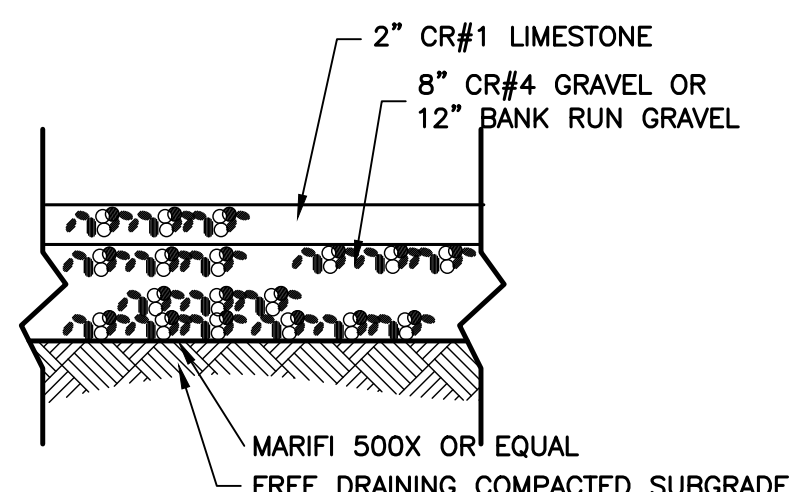

7 TYPICAL GRAVEL DRIVE SECTION
NTS

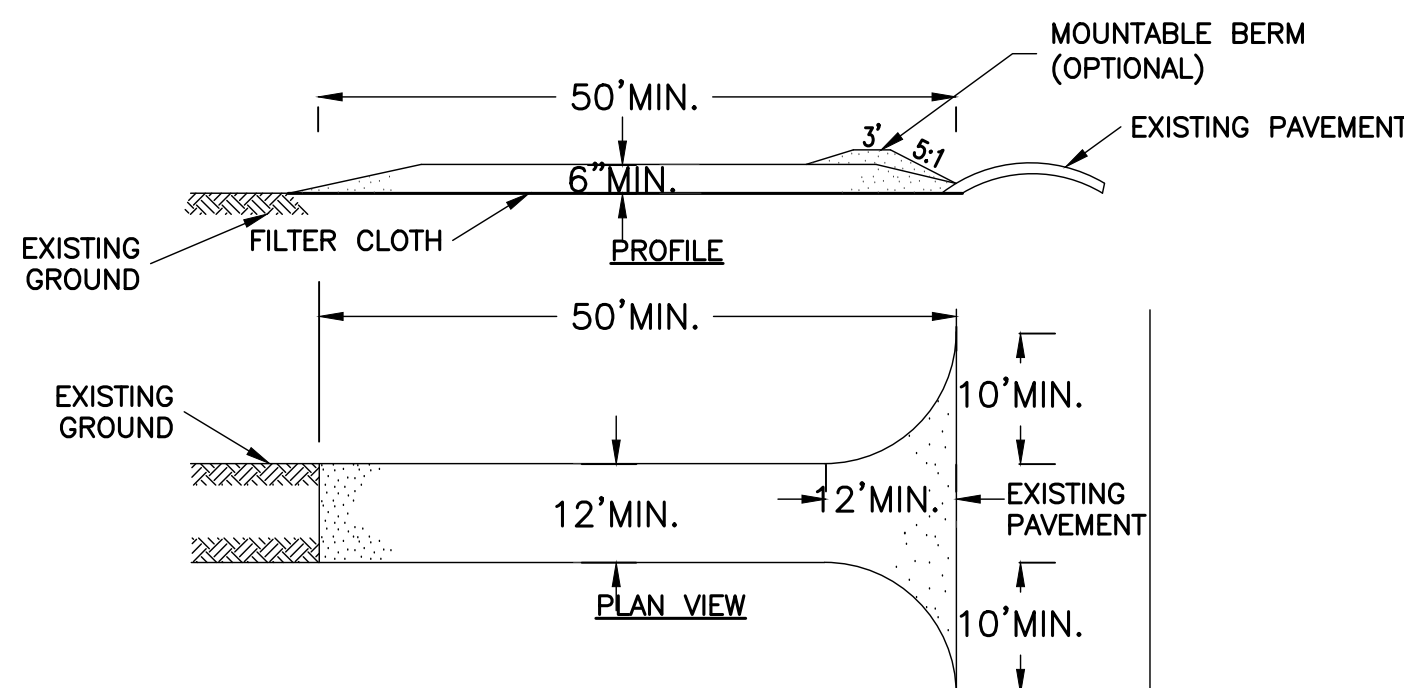

CONSTRUCTION SPECIFICATIONS

1. STONE SIZE - USE 2" STONE, OR RECLAIMED OR RECYCLED CONCRETE EQUIVALENT.
2. LENGTH - NOT LESS THAN 50 FEET (EXCEPT ON A SINGLE GARAGE LOT WHERE A 30 FOOT MINIMUM LENGTH WOULD APPLY).
3. THICKNESS - NOT LESS THAN SIX (6) INCHES.
4. WIDTH - TWELVE (12) FOOT MINIMUM, BUT NOT LESS THAN THE FULL WIDTH AT POINTS WHERE INGRESS OR EGRESS OCCURS. TWENTY-FOUR (24) FOOT IF SINGLE ENTRANCE TO SITE.
5. FILTER CLOTH - WILL BE PLACED OVER THE ENTIRE AREA PRIOR TO PLACING OF STONE.
6. SURFACE WATER - ALL SURFACE WATER FLOWING OR DIVERTED TOWARD CONSTRUCTION ENTRANCES SHALL BE PIPED ACROSS THE ENTRANCE. IF PIPING IS IMPRACTICAL, A MOUNTABLE BERM WITH 5:1 SLOPES WILL BE PERMITTED.
7. MAINTENANCE - THE ENTRANCE SHALL BE MAINTAINED IN A CONDITION WHICH WILL PREVENT TRACKING OR FLOWING OF SEDIMENT ONTO PUBLIC RIGHTS-OF-WAY, ALL SEDIMENT SPILLED, DROPPED, WASHED OR TRACTED ONTO PUBLIC RIGHTS-OF-WAY MUST BE REMOVED IMMEDIATELY.
8. WHEN WASHING IS REQUIRED, IT SHALL BE DONE ON A AREA STABILIZED WITH STONE AND WHICH DRAINS INTO AN APPROVED SEDIMENT TRAPPING DEVICE.
9. PERIODIC INSPECTION AND NEEDED MAINTENANCE SHALL BE PROVIDED AFTER EACH RAIN.

7 STABILIZED CONSTRUCTION ENTRANCE
NTS

The Quick4[®] Plus
Equalizer 36 Low Profile (LP) Chamber

Quick4 Plus[™] Series

The Quick4 Plus Equalizer 36 Low Profile (LP) offers maximum strength through its two center structural columns. This chamber can be installed in a 24-inch-wide trench. It is 4 inches shorter in height than other Equalizer 36 model chambers, allowing for shallower installation. Like the original line of Quick4 chambers, it offers advanced contouring capability with its Contour Swivel Connection[™], which permits turns up to 15°, right or left. The Quick4 Plus All-in-One 8 and Quick4 Plus Endcaps provide increased flexibility in system design and configurations.

Maximum Strength

Quick4 Plus Equalizer 36 LP Chamber Specifications

Size	22"W x 53"L x 8"H (559 mm x 1346 mm x 203 mm)
Effective Length	48" (1219 mm)
Lower Height	6.3" (160 mm)
Storage Capacity	20 gal (76 L)
Invert Height	3.3" (84 mm), 9.6" (244 mm)

Quick4 Plus All-in-One 8 Endcap Benefits:

- May be used at the end of chamber row for an inlet/outlet or can be installed mid-trench
- Mid-trench connection feature allows center feed inletting of chamber rows
- Center-feed connection allows for easy installation of serial distribution systems
- Variable pipe connection options allow for side, end or top inletting
- Piping drill points are set for gravity or pressure pipe

Quick4 Plus Endcap Benefits:

- Simple, flat design
- Allows installation of a pipe from the end only
- Piping drill points are set for gravity or pressure pipe

Quick4 Plus All-in-One Periscope Benefits:

- Allows for raised invert installations
- 180° directional inletting
- 12" raised invert is ideal for serial applications

APPROVED in _____

Certified by the International Association of Plumbing and Mechanical Officials (IAPMO)

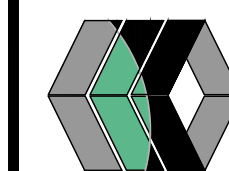

STAMP

REVIEWS AND APPROVALS		NO.	DATE	DESCRIPTION OF REVISION OR APPROVAL	BY
1	8/8/19				KEP

NEW GARAGE SITE PLAN
MARC LAJEUNESSE
SHOWING LAND IN:
MIDDLE CHESHIRE ROAD
TOWN OF CANANDAIGUA

STATE OF NEW YORK

COUNTY OF ONTARIO

DRAWING TITLE: DETAILS	
DRAWN BY:	BAM
DESIGNED BY:	BAM
CHECKED BY:	BAM
SCALE:	1"=30'
JOB NO.:	19-126
DATE:	08/09/2019
TAX MAP#:	126.00-1-23.112