

DRAWING NO.	TITLE
C-0.0	COVER
C-1.0	EXISTING SITE PLAN
C-1.1	PROPOSED SITE PLAN
C-1.2	GRADING PLAN
C-2.0	MISCELLANEOUS SITE DETAILS
C-2.1	MISCELLANEOUS SITE DETAILS
C-3.0	ON-SITE WASTEWATER TREATMENT (SEPTIC) SYSTEM DETAILS 1 OF 2
C-3.1	ON-SITE WASTEWATER TREATMENT (SEPTIC) SYSTEM DETAILS 2 OF 2
C-4.0	STORMWATER MANAGEMENT DETAILS
C-5.0	DRIVEWAY DETAILS
L-1.0	LANDSCAPE PLAN
E-1.0	PHOTOMETRIC PLAN
A-2.0	FLOOR PLAN
A-2.01	STORAGE BUILDING FLOOR PLAN
A-2.1	ELEVATION VIEWS
A-2.2	ELEVATION VIEWS
A-2.3	STORAGE BUILDING ELEVATION VIEWS
A-2.4	STORAGE BUILDING ELEVATION VIEWS

SWPPP
THIS PROJECT WILL DISTURB MORE THAN 1 ACRE, THEREFORE A SWPPP IS REQUIRED.
LEES THAN 2.5 ACRES WILL BE DISTURBED – REFER TO GRADING PLAN ON DRAWING C-1.2

STORMWATER RUNOFF WILL BE COLLECTED AND CONVEYED TO INFILTRATION BASINS WHERE IT WILL ALLOWED TO INFILTRATE INTO THE GROUND. ALL STORMWATER RUNOFF RESULTING FROM THE CONSTRUCTION OF THIS PROJECT WILL BE DISPOSED OF ON THE SITE. NO ADDITIONAL STORMWATER RUNOFF WILL LEAVE THE SITE.

FLOODPLAIN
THE PROJECT SITE IS NOT LOCATED WITHIN A FLOODPLAIN PER FIRM COMMUNITY PANEL

VERTICAL DATUM **HORIZONTAL DATUM**
NAVD88 NAVD29

GRADING
SLOPES SHALL NOT EXCEED 1’ VERTICAL TO 3’ HORIZONTAL

SITE PLAN
SITE PLAN WAS PREPARED BASED ON A TAX MAP INFORMATION, NYS AERIAL DATA AND A SURVEY PREPARED BY VENEZIA LAND SURVEYING AND CIVIL ENGINEERS DATED FEBRUARY 8, 2022.

THIS IS NOT A SUBDIVISION MAP AND SHALL NOT BE FILED AS SUCH.

DISTRICT INFORMATION
ACCORDING TO THE TOWN DISTRICT MAPS, THE PROJECT SITE IS LOCATED IN THE FOLLOWING DISTRICTS:
CANANDAIGUA FIRE PROTECTION
CANANDAIGUA – FARMINGTON WATER DISTRICT #2
ONTARIO COUNTY AGRICULTURAL DISTRICT ONTO1

CRITICAL ENVIRONMENTAL AREA
THERE ARE NO CRITICAL ENVIRONMENTAL AREAS ON THE PROJECT SITE OR ON ADJACENT PARCELS TO THE PROJECT SITE.

ARCHAEOLOGICAL SIGNIFICANCE
THE PROJECT SITE DOES NOT CONTAIN AND IS NOT SUBSTANTIALLY CONTIGUOUS TO A BUILDING, ARCHEOLOGICAL SITE OR DISTRICT LISTED ON THE NATIONAL OR STATE REGISTER OF HISTORIC PLACES OR THAT HAS BEEN DETERMINED BY THE COMMISSIONER OF THE NYS OFFICE OF PARKS, RECREATION AND HISTORIC PRESERVATION TO BE ELIGIBLE FOR LISTING ON THE STATE REGISTER OF HISTORIC PLACES. .

THE PROJECT SITE IS LOCATED IN OR ADJACENT TO AN AREA DESIGNATED AS SENSITIVE FOR ARCHEOLOGICAL SITES ON THE NYSHPO ARCHEOLOGICAL SITE INVENTORY.

WETLANDS
THE SITE HAS A FRESHWATER POND AND IS ADJACENT TO STATE REGULATED WETLAND CG-11 (REFER TO WETLAND MAP ON THIS DRAWING).
THE PROPOSED PROJECT WILL NOT PHYSICALLY ALTER THE WETLANDS OR POND.

SIGNIFICANT NATURAL COMMUNITIES
ACCORDING TO DATA IN THE NYSDEC ENVIRONMENTAL RESOURCE MAPPER, THERE ARE NO SIGNIFICANT NATURAL COMMUNITIES LOCATED ON THE PROJECT SITE OR ON ADJACENT PARCELS TO THE PROJECT SITE.

RARE PLANTS AND ANIMALS
ACCORDING TO DATA IN THE NYSDEC ENVIRONMENTAL RESOURCE MAPPER, THERE ARE NO RARE PLANTS OR ANIMALS LOCATED ON THE PROJECT SITE OR ON ADJACENT PARCELS TO THE PROJECT SITE.

UNIQUE GEOLOGICAL FEATURES
ACCORDING TO DATA IN THE NYSDEC ENVIRONMENTAL RESOURCE MAPPER, THERE ARE NO UNIQUE GEOLOGICAL FEATURES LOCATED ON THE PROJECT SITE OR ON ADJACENT PARCELS TO THE PROJECT SITE.

HAZARDOUS WASTE REMEDIATION SITE
THE PROJECT SITE AND ADJOINING PROPERTIES HAVE NOT BEEN THE SUBJECT OF REMEDIATION OF HAZARDOUS WASTE

PHOSPHOROUS NOTES:
NO PHOSPHOROUS SHALL BE USED AT PLANTING TIME UNLESS SOIL TESTING HAS BEEN COMPLETED AND TESTED BY A HORTICULTURAL TESTING LAB AND SOIL TESTS SPECIFICALLY INDICATE A PHOSPHOROUS DEFICIENCY THAT IS HARMFUL, OR WILL PREVENT NEW LAWNS AND PLANTINGS FROM ESTABLISHING PROPERLY.
IF SOIL TESTS INDICATE A PHOSPHOROUS DEFICIENCY THAT WILL IMPACT PLANT AND LAWN ESTABLISHMENT, PHOSPHOROUS SHALL BE APPLIED AT THE MINIMUM RECOMMENDED LEVEL PRESCRIBED IN THE SOIL TEST FOLLOWING ALL NYS DEC RECOMMENDATIONS.

RIGHT-TO-FARM
THE SUBJECT PARCEL IS LOCATED IN ONTARIO COUNTY AGRICULTURAL DISTRICT ONTO1 AND IS SUBJECT TO ALL OF THE PROVISIONS OF THE TOWN OF CANANDAIGUA'S RIGHT-TO-FARM LAW

REQUIRED APPROVALS	
SITE PLAN APPROVE	TOWN OF CANANDAIGUA
BUILDING PERMIT	TOWN OF CANANDAIGUA
SEPTIC SYSTEM APPROVAL	NYSDOH
DRIVEWAY PERMIT	NYSDOT



STATE WETLANDS INVENTORY
FRESHWATER WETLAND
CG-11/ CLASS: 2
SIZE: 57.8ACRES

STATE WETLAND CHECK ZONE

NATIONAL WETLANDS INVENTORY
FRESHWATER POND
ID: PUBHh
SIZE: 0.335 ACRES

PROJECT SITE

NATIONAL WETLANDS INVENTORY
RIVERINE
ID: R5UBH
SIZE: 1.80 ACRES

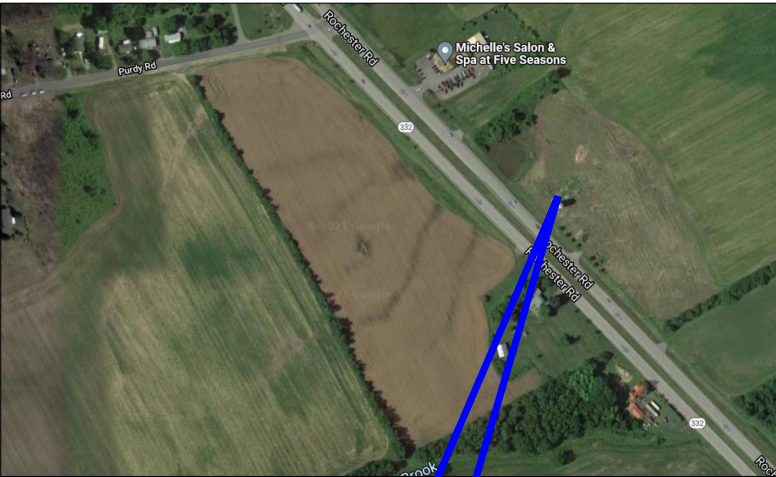

PROJECT SITE

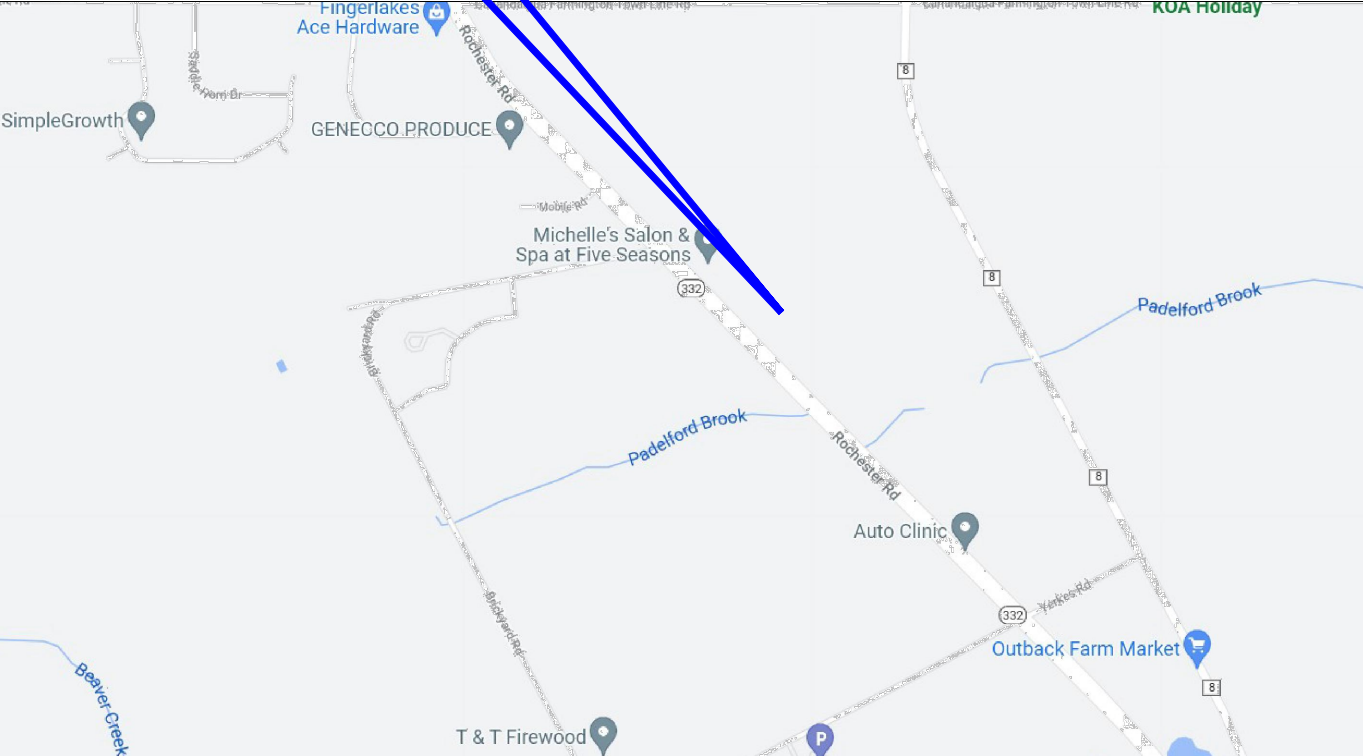

NYSDEC ENVIRONMENTAL RESOURCE (WETLAND) MAP

SCALE: 1" = 200'-0"

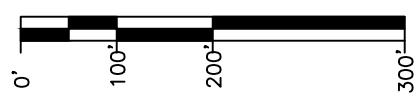

SEQUENCE OF CONSTRUCTION

1. ESTABLISH THE LIMIT OF DISTURBANCE FOR THE PROPOSED SITE CLEARING AND GRADING – CONTRACTOR TO LIMIT AREA TO LESS THAN 2.5 ACRES AS SHOWN ON THE GRAINDING PLAN C-1.2
2. DELINEATE AND PROTECT EXISTING TREES TO BE PRESERVED AND TREES TO BE REMOVED
3. ESTABLISH THE LOCATION FOR THE EROSION AND SEDIMENTATION CONTROL MEASURES – PREPARE AREA FOR THERE INSTALLATION.
4. INSTALL SILT FENCE AS REQUIRED IN THE EROSION CONTROL PLAN
5. CONSTRUCT STABILIZED CONSTRUCTION ENTRANCE
6. BEGIN CLEARING AND GRADING FOR THE CONSTRUCTION AT THE SITE
7. STOCKPILE TOPSOIL IN ACCORDANCE WITH THE EROSION CONTROL PLAN
8. PLACE STONE BASE FOR NEW BUILDING, DRIVEWAY AND PARKING AREAS
9. INSTALL POSTS FOR NEW BUILDING
10. INSTALL ALL NEW UNDERGROUND UTILITIES
11. SET NEW TANKS FOR ON-SITE WASTEWATER TREATMENT (SEPTIC) SYSTEM
12. POUR CONCRETE SLAB FOR BUILDING
13. FRAME AND BUILD BUILDING
14. PAVE DRIVEWAY
15. PLACE TOPSOIL AND COMPLETE FINAL GRADING
16. PLACE SEED AND MULCH IN DISTURBED AREAS
17. WHEN ALL DISTURBED AREAS ARE STABLE AND UPON APPROVAL FROM THE TOWN, REMOVE ALL TEMPORARY EROSION AND SEDIMENTATION CONTROL MEASURES

ANTICIPATED CONSTRUCTION DURATION: 4 MONTHS

	REQUIRED	PROPOSED
ZONING	CC- COMMUNITY COMMERCIAL	
PERMITTED USE	YES	LAWN AND GARDEN EQUIPMENT SHOP
LOT SIZE (ACRES) DEPTH WIDTH (FRONTAGE)	1.0 ACRE NA 175'	7.488 ACRES (326,177 SF) 404'± 847'±
SETBACK FRONT REAR SIDE	150' (ST RTE 332) 40' 20'/100' (ADJACENT TO RESIDENTIAL)	PRINCIPAL USE BUILDING 151.28'± 113.25'± 211.19'±/510.41'±
LOT COVERAGE MAXIMUM	35%	BUILDING/PORCH 7,112 SF STORAGE BUILDING 4,000 SF GRAVEL/PAVEMENT 24,600 SF TOTAL COVERAGE 35,712 SF = 12%
HEIGHT	2-1/2 STORIES/35' MAXIMUM	1 STORY/31.25'±

STATEMENT OF OPERATIONS

REFER TO STATEMENT OF OPERATION DOCUMENT ATTACHED TO THIS APPLICATION

DEVELOPER CONTACT INFORMATION

DEVELOPER: DIVERSIFIED EQUIPMENT,LLC

CONTACT: BRIAN CAFALONE
PHONE: (315) 573-2255
EMAIL: BRIAN.CAFALONE@HOTMAIL.COM

PROPERTY OWNER INFORMATION:

SIMMONS-ROCKWELL REALTY ASSOC., LLC
1160 CO RTE 66
HORNELL, NY 14843
PHONE: (607) 968-2090

ENGINEER

MCCORMICK ENGINEERING PC
JASON T. MCCORMICK, PE
294 SKUSE ROAD
GENEVA, NY 14456
PHONE: 585-721-7219
EMAIL: MCCORMICKPE@AOL.COM

PLANNING BOARD CHAIRPERSON

ENGINEER

CANANDAIGUA-FARMINGTON WATER DISTRICT

WARNING
IT IS A VIOLATION OF SECTION 7209, SUBDIVISION 2, OF THE NEW YORK STATE EDUCATION LAW FOR ANY PERSON, OTHER THAN WHOSE SEAL APPEARS ON THIS DRAWING, TO ALTER IN ANY WAY AN ITEM ON THIS DRAWING. IF AN ITEM IS ALTERED, THE ALTERING ENGINEER SHALL AFFIX TO THE ITEM HIS SEAL AND THE NOTATION "ALTERED BY" FOLLOWED BY HIS SIGNATURE AND THE DATE OF SUCH ALTERATION, AND A SPECIFIC DESCRIPTION OF THE ALTERATION.

DRAWN BY: JTM	2	05/07/22	REVISED PER MEETING WITH TOWN OF CANANDAIGUA
PROJ. ENGR.: JTM	1	03/30/22	REVISED PER TOWN CHECK LISTS
PROJ. MNGR.: JTM	0	02/19/22	FOR APPROVAL
CHECKED BY: JTM	NO	DATE	DESCRIPTION
REVISIONS			



McCormick Engineering P.C.

294 Skuse Road
Geneva, New York 14456

(585) 721-7219

JOB No. 21-328

DIVERSIFIED EQUIPMENT, LLC
1947 STATE RTE 332
Canandaigua, New York
(T) Canandaigua, Ontario County
TAX ID No. 56.00-1-13.210

COVER SHEET

Scale:
AS NOTED

Date: 05/22

DWG. C-0.0

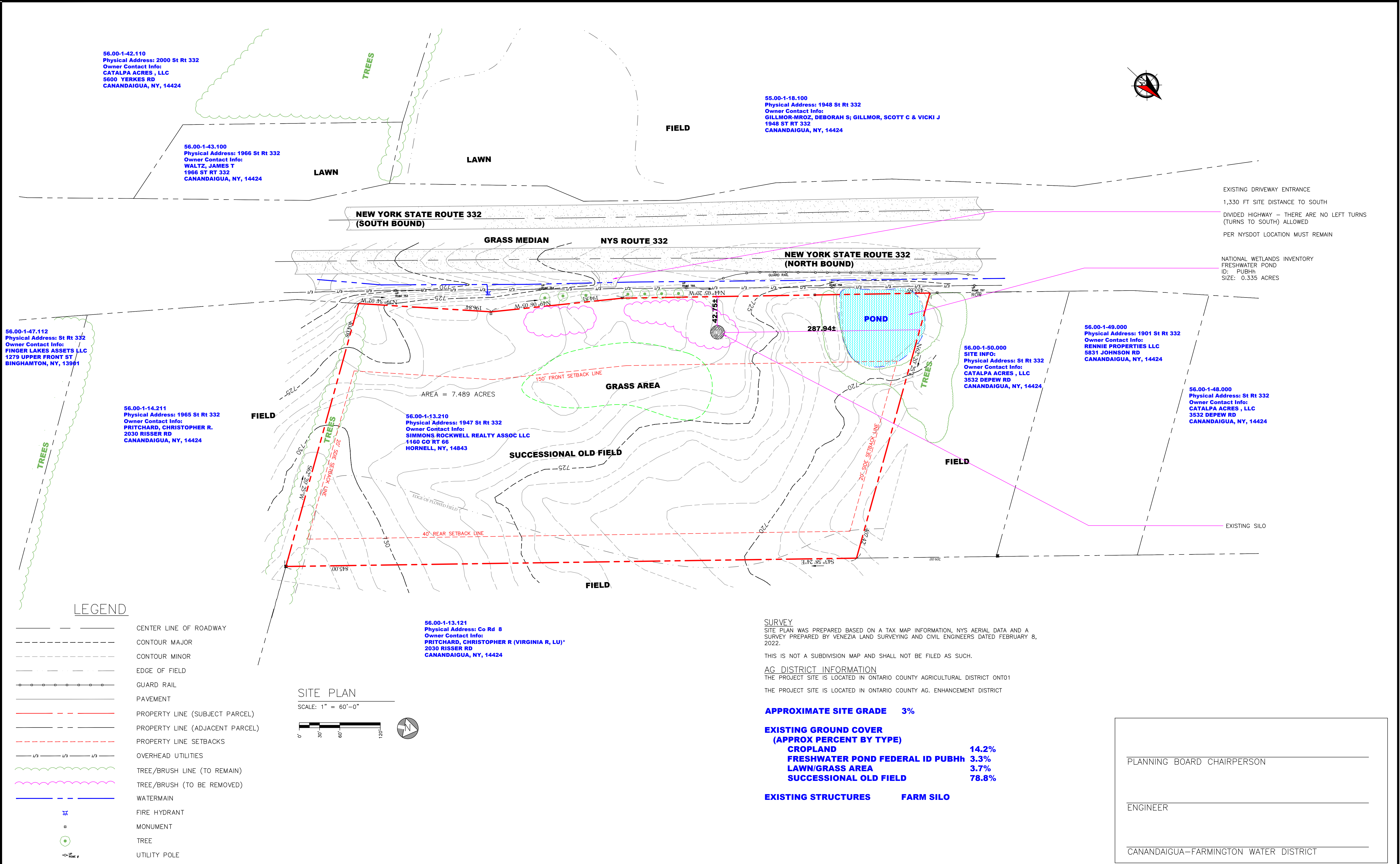

NEW YORK STATE ROUTE 332
(SOUTH BOUND)

GRASS MEDIAN

NEW YORK STATE ROUTE 332
(NORTH BOUND)

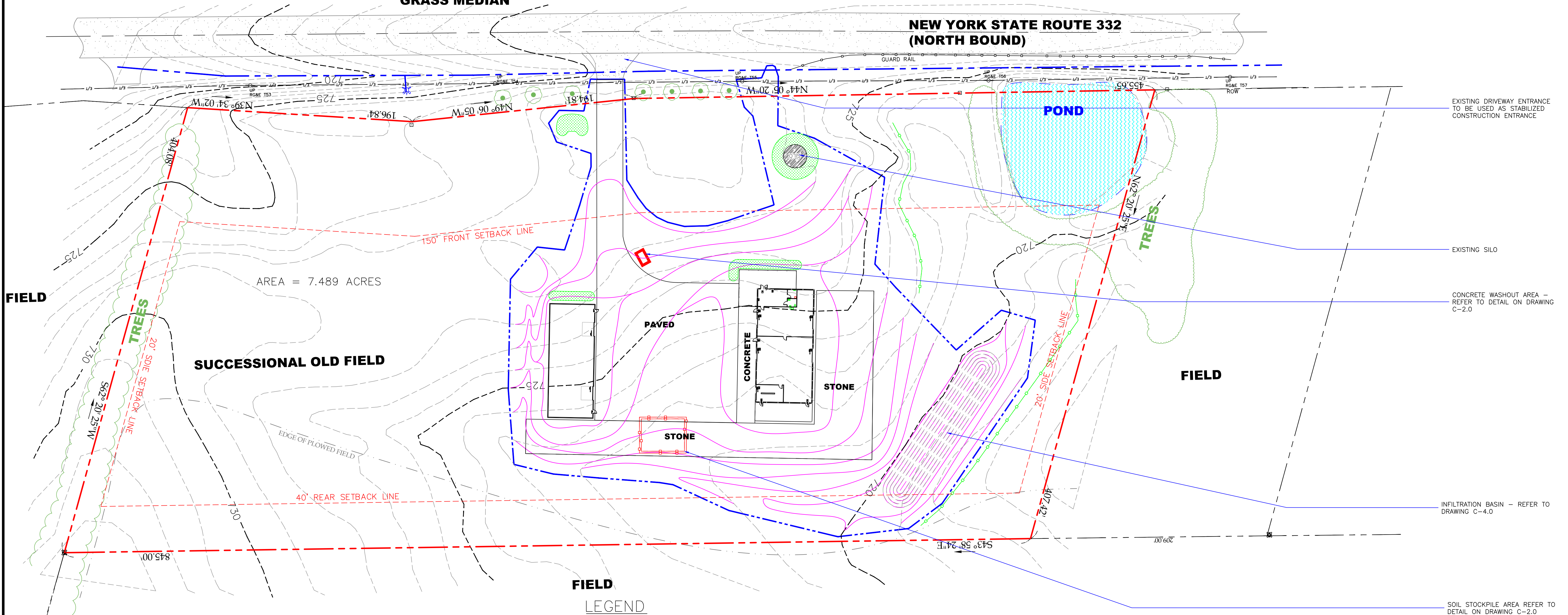

FIELD
LEGEND

EXISTING FEATURES	PROPOSED FEATURES
CENTER LINE OF ROADWAY	CONTOUR
CONTOUR MAJOR	LIMIT OF DISTURBANCE (TO BE DELINEATED BY SURVEYOR PRIOR TO THE START OF EARTHWORK)
CONTOUR MINOR	LIMIT OF PAVED/STONE AREAS
EDGE OF FIELD	SILT FENCE - REFER TO DETAIL ON DRAWING C-2.0
GUARD RAIL	LANDSCAPED AREA REFER TO DRAWING L-1.0
PAVEMENT	
PROPERTY LINE (SUBJECT PARCEL)	
PROPERTY LINE (ADJACENT PARCEL)	
PROPERTY LINE SETBACKS	
OVERHEAD UTILITIES	
TREE/BRUSH LINE (TO REMAIN)	
WATERMAIN	
FIRE HYDRANT	
MONUMENT	
TREE	
UTILITY POLE	

SITE PLAN

SCALE: 1" = 40'-0"

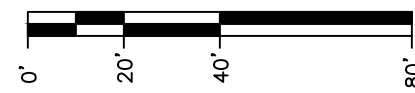

APPROXIMATE SITE GRADE 3%

LIMITS OF DISTURBANCE 108,100SF ± 2.48 ACRES

VEGETATIVE COVER REMOVED 35,750 SF ± (DRIVEWAY, GRAVEL/PAVED YARD/BUILDING)

REMAIN DISTURBED AREAS SEEDED AND MAINTAINED AS LAWN

PLANNING BOARD CHAIRPERSON _____

ENGINEER _____

CANANDAIGUA-FARMINGTON WATER DISTRICT _____

WARNING

IT IS A VIOLATION OF SECTION 7209, SUBDIVISION 2, OF THE NEW YORK STATE EDUCATION LAW FOR ANY PERSON, OTHER THAN WHOSE SEAL APPEARS ON THIS DRAWING, TO ALTER IN ANY WAY AN ITEM ON THIS DRAWING. IF AN ITEM IS ALTERED, THE ALTERING ENGINEER SHALL AFFIX TO THE ITEM HIS SEAL AND THE NOTATION "ALTERED BY" FOLLOWED BY HIS SIGNATURE AND THE DATE OF SUCH ALTERATION, AND A SPECIFIC DESCRIPTION OF THE ALTERATION.

DRAWN BY: JTM

PROJ. ENGR.: JTM

PROJ. MNGR.: JTM

CHECKED BY: JTM

NO.	DATE	REVISIONS
2	05/07/22	REVISED PER MEETING WITH TOWN OF CANANDAIGUA
1	03/30/22	REVISED PER TOWN CHECK LISTS
0	02/19/22	FOR APPROVAL
NO.	DATE	DESCRIPTION

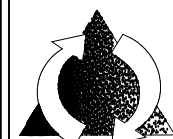
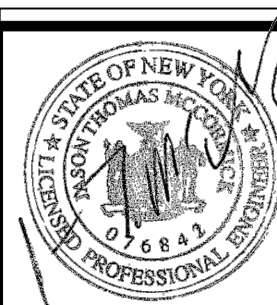

McCormick Engineering P.C.

294 Skuse Road
Geneva, New York 14456

(585) 721-7219

JOB No. 21-328

DIVERSIFIED EQUIPMENT, LLC
1947 STATE RTE 332
Canandaigua, New York
(T) Canandaigua, Ontario County
TAX ID No. 56.00-1-13.210

GRADING PLAN

Scale:
AS NOTED

Date: 05/22

DWG. C-1.2

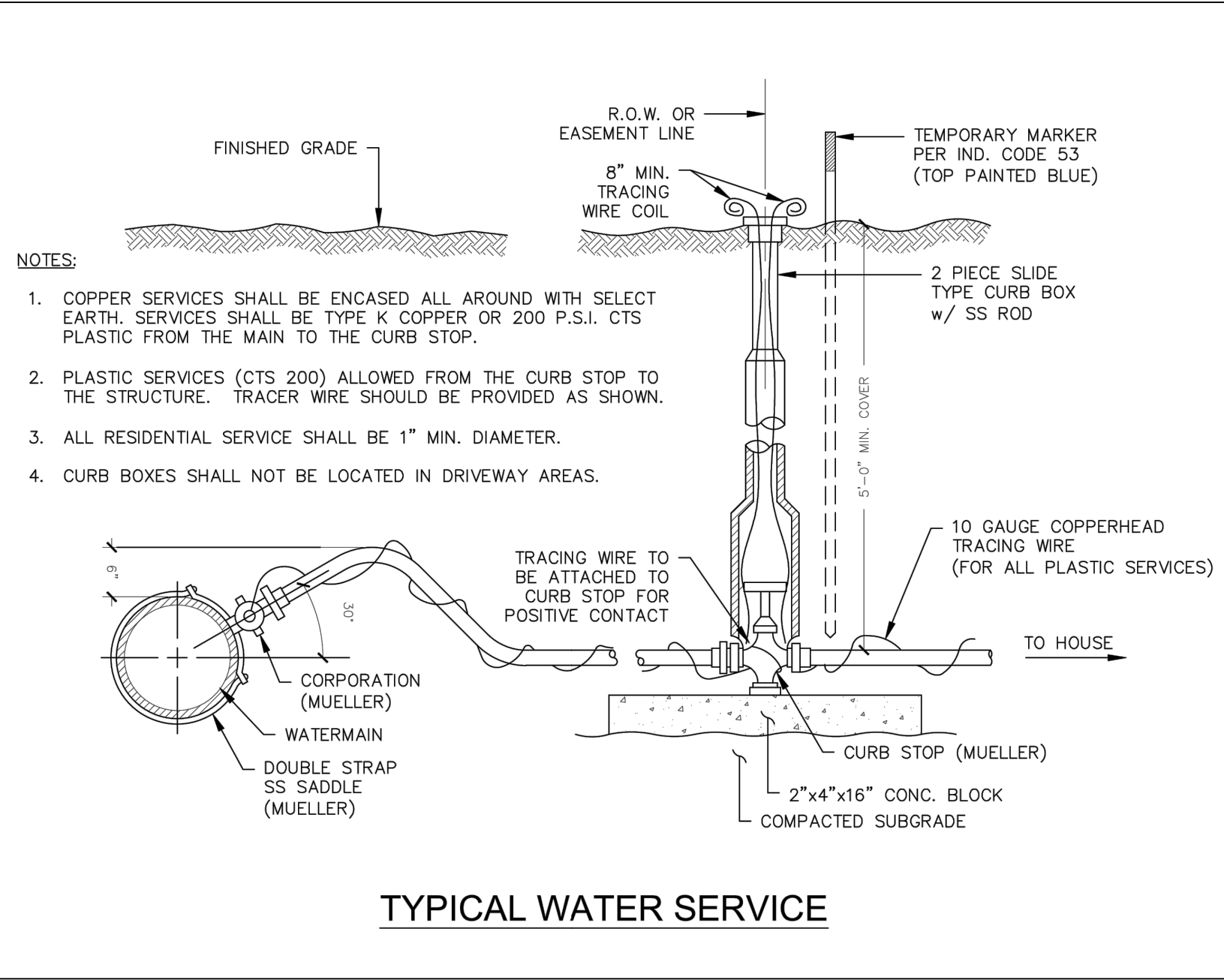
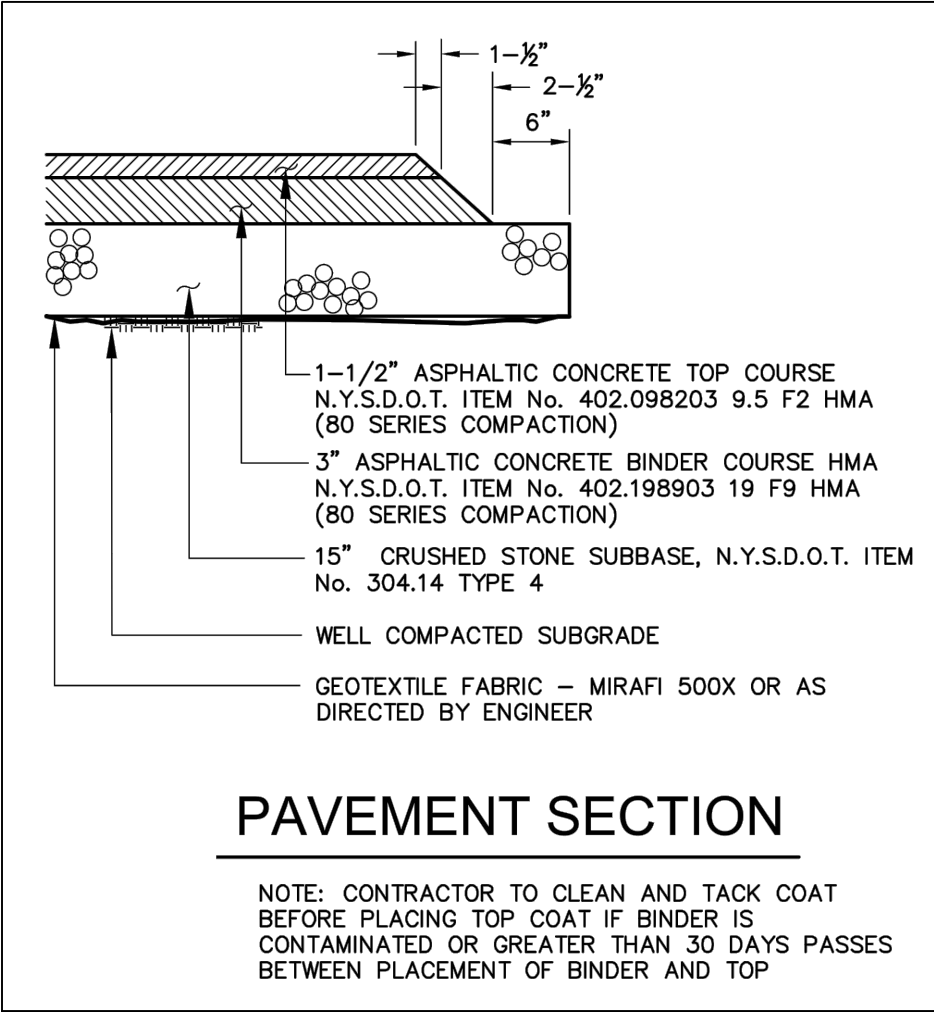
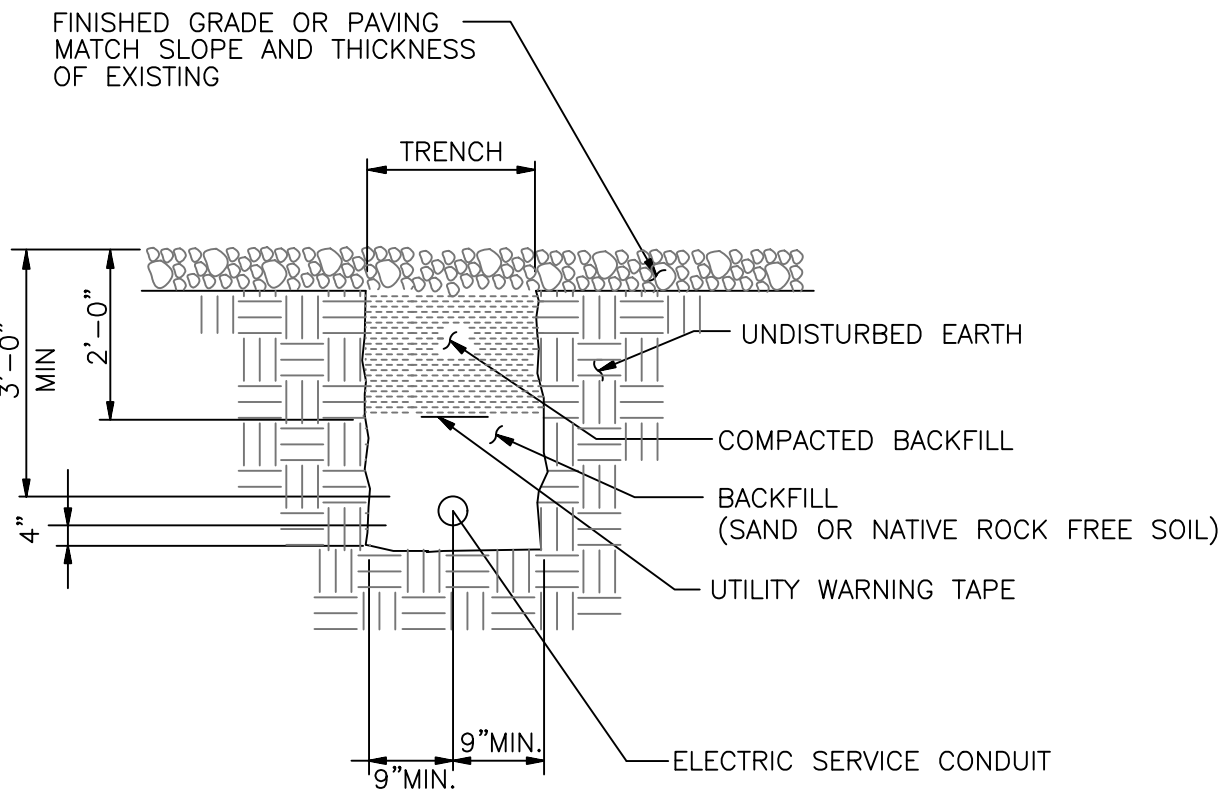
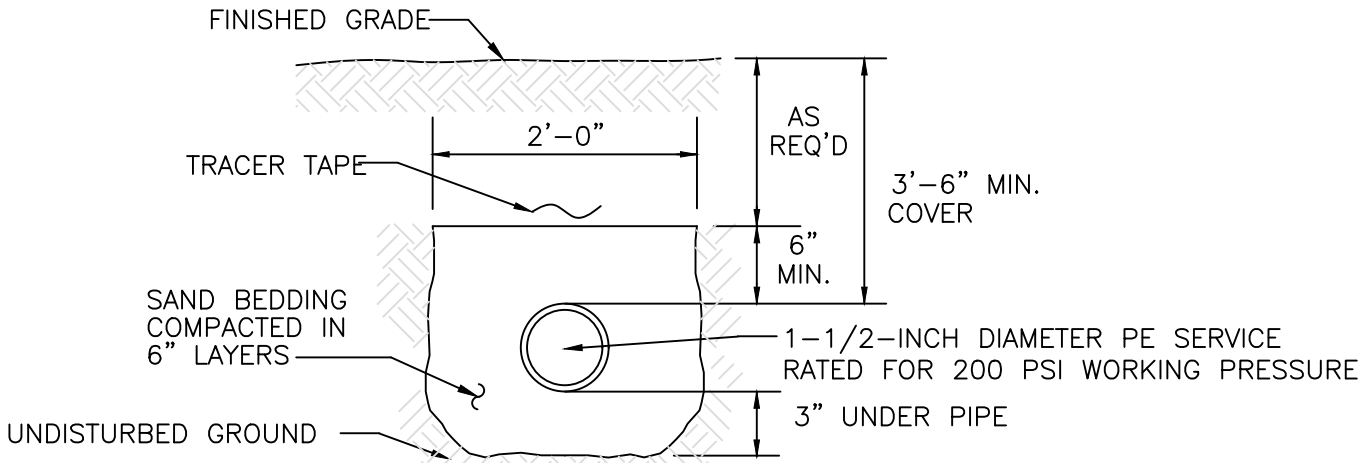
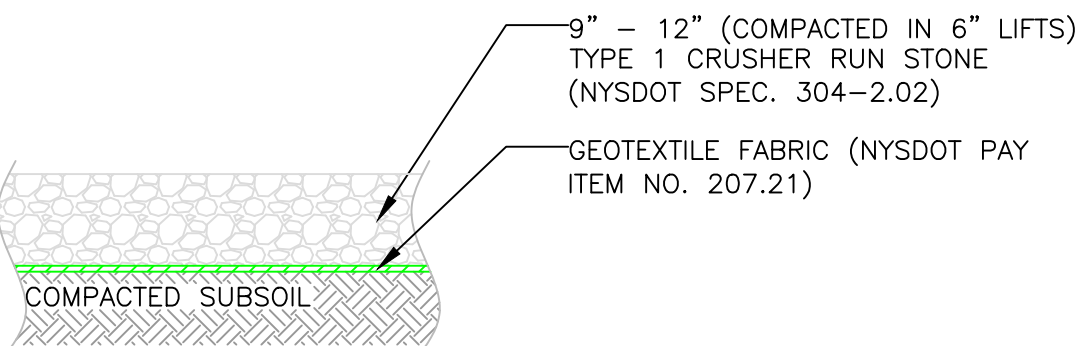
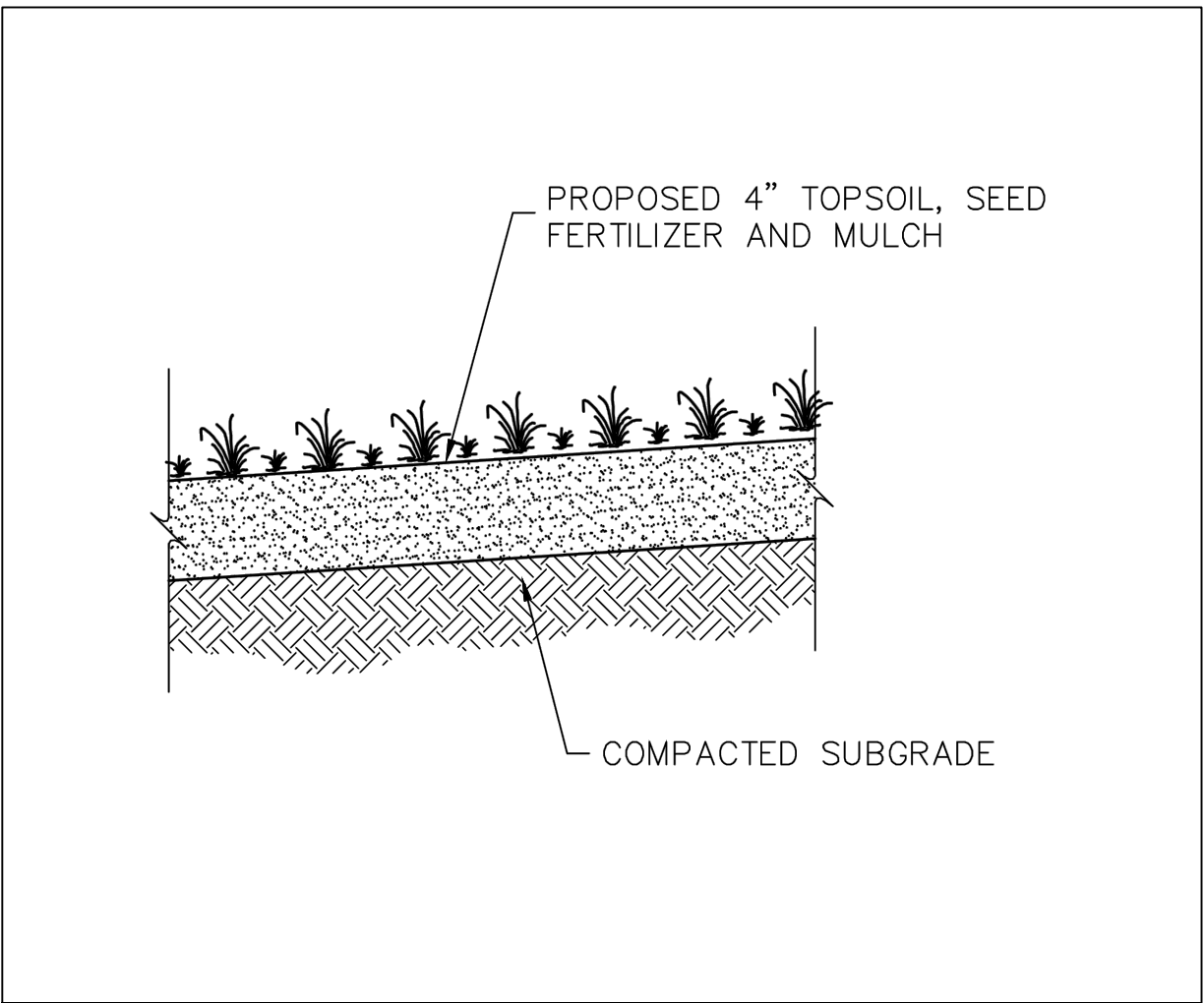
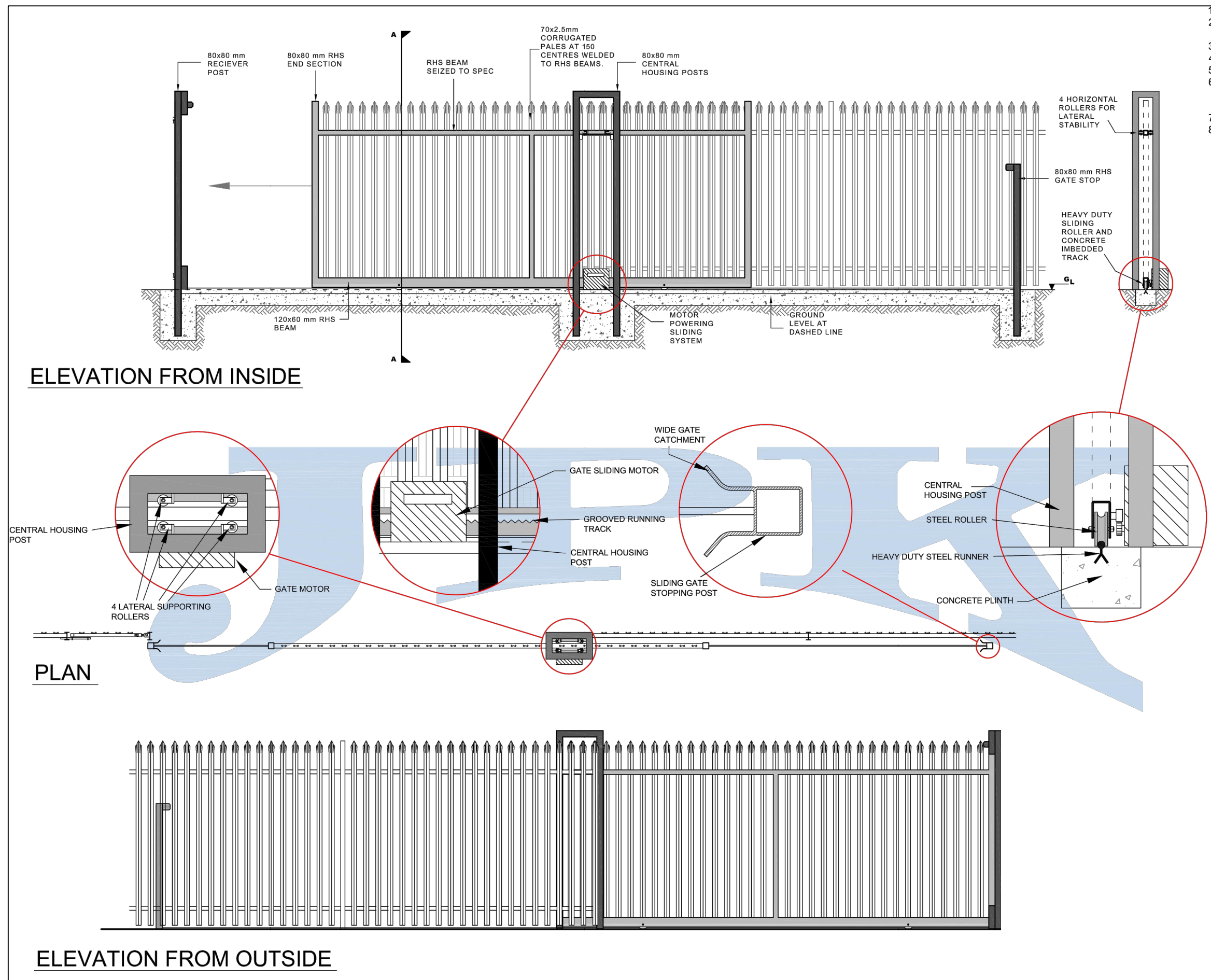

WARNING
IT IS A VIOLATION OF SECTION 7209, SUBDIVISION 2, OF THE NEW YORK STATE EDUCATION LAW FOR ANY PERSON, OTHER THAN WHOSE SEAL APPEARS ON THIS DRAWING, TO ALTER IN ANY WAY AN ITEM ON THIS DRAWING. IF AN ITEM IS ALTERED, THE ALTERING ENGINEER SHALL AFFIX TO THE ITEM HIS SEAL AND THE NOTATION "ALTERED BY" FOLLOWED BY HIS SIGNATURE AND THE DATE OF SUCH ALTERATION, AND A SPECIFIC DESCRIPTION OF THE ALTERATION.

DRAWN BY: JTM		
PROJ. ENGR.: JTM	2 05/07/22	REVISED PER MEETING WITH TOWN OF CANANDAIGUA
PROJ. MNGR.: JTM	1 03/30/22	REVISED PER TOWN CHECK LISTS
CHECKED BY: JTM	0 02/19/22	FOR APPROVAL
	NO. DATE	DESCRIPTION
		REVISIONS

Call 811
before you dig

CALL DIG SAFELY
NEW YORK
48 HOURS BEFORE
DIGGING OR
DRIVING POSTS
@ 811

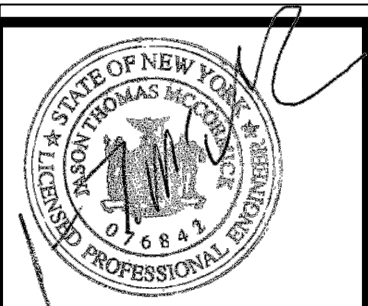

McCormick Engineering P.C.

294 Skuse Road
Geneva, New York 14456

(585) 721-7219

JOB No. 21-328

DIVERSIFIED EQUIPMENT, LLC
1947 STATE RTE 332
Canandaigua, New York
(T) Canandaigua, Ontario County
TAX ID No. 56.00-1-13.210

MISCELLANEOUS SITE DETAILS		
Scale: AS NOTED	Date: 05/22	DWG. C-2.1

BASIS OF DESIGN (NEW SYSTEM)

THE ON-SITE WASTEWATER TREATMENT (SEPTIC) SYSTEM HAS BEEN DESIGNED IN ACCORDANCE WITH THE NEW YORK STATE DEC DESIGN STANDARDS FOR INTERMEDIATE SIZED WASTEWATER TREATMENT SYSTEMS, MARCH 2014. THE FOLLOWING PRESENTS THE BASIS OF DESIGN FOR THE ON SITE WASTEWATER TREATMENT SYSTEM.

AREA TO BE SERVED:	EQUIPMENT RENTAL/REPAIR		
DESIGN FLOW:	10 OCCUPANTS X 15 GPD/SEAT	=	150 GPD
	"DOMESTIC" WASTEWATER ONLY – NO PROCESS WASTEWATER		
SITE CHARACTERISTICS:	SITE SLOPE LESS THAN 5% POTABLE WATER FROM A CONNECTION TO A MUNICIPAL WATER SYSTEM		

ON-SITE TESTS
PERCOLATION TESTS AND DEEP HOLE TEST COMPLETED BY JASON MCCORMICK, PE, MCCORMICK ENGINEERING PC.

PERC TEST ON FEBRUARY 16 AND 17, 2022					
HOLE	DEPTH OF HOLE (INCH)	PERCOLATION RATE (MIN/INCH)			
		RUN 1	RUN 2	RUN 3	RUN 4
PT-1	24	38	43	48	48
PT-2	24	37	44	47	48
PT-3	24	39	44	48	49
DESIGN PERC RATE OF 46-60 MIN/INCH (APPLICATION RATE – 0.45 GAL/DAY/SF)					

DEEP HOLE WAS DUG ON FEBRUARY 16, 2022 BY AUGER METHOD

DEPTH	SOIL CONDITION
0"-3"	TOPSOIL
3"-54"	SILTY LOAM WITH FEW ROOTS
54"-64"	CLAYEY SILTY LOAM WITH NO ROOTS
DEPTH TO IMPERMEABLE LAYER/BEDROCK – CLAYEY SILTY LOAM BOUNDARY LAYER	
DEPTH TO GROUNDWATER OR MOTTLING – GROUNDWATER NOTED AT 55"	

DURING CONSTRUCTION, CONTRACTOR SHALL CONFIRM SOILS ARE CONSISTENT WITH THE PERC AND DEEP HOLE TESTS. MCCORMICK ENGINEERING PC SHALL BE NOTIFIED IMMEDIATELY OF ANY DIFFERENCES.

GREASE TRAP
1. A GREASE TRAP IS NOT PROPOSED FOR THIS SYSTEM SINCE WASTEWATER FLOWS ARE "DOMESTIC" IN NATURE AND ARE SIMILAR IN CHARACTERISTICS TO A SINGLE FAMILY HOME. NO FOOD PREPARATION AT THIS LOCATION.

SEPTIC TANK
SIZE = 1.5 X DESIGN FLOW = 1.5 X 150 = 225 GALLONS USE 1,000 GALLON TANK (MINIMUM ALLOWABLE SIZE)
1. A 1,000 GALLON DUAL CHAMBER, PRE-CAST CONCRETE SEPTIC TANK SHALL BE INSTALLED SUCH THAT IT WILL RECEIVE THE DISCHARGE FROM THE BUILDING.
2. CONTRACTOR SHALL CONFIRM DIMENSIONS OF SEPTIC TANK PRIOR TO EXCAVATION.
3. SEPTIC TANKS SHOULD BE PUMPED OUT EVERY TWO TO THREE YEARS.
4. SEPTIC TANK ADDITIVES (BIOLOGICAL OR CHEMICAL) SHOULD NOT BE USED.
5. RISERS ARE REQUIRED IF DEPTH TO TOP OF TANK IS GREATER THAN 12'

EFFLUENT FILTER
A ZABEL FILTER (MODEL A300 12X20) SHALL BE INSTALLED ON THE EFFLUENT PIPE OF THE SEPTIC TANK.

ABSORPTION SYSTEM
TRENCH LENGTH
APPLICATION RATE: 0.45 GPD PER SQ FT (TABLE E-1)
REQUIRED AREA = 150 GPD / 0.45 GPD PER SQ FT = 334 SQ FT
REQUIRED LENGTH OF 2' WIDE TRENCH: 167 FEET (MINIMUM)

DUE TO CONFINING LAYER/HIGH GROUNDWATER AN ELJEN GEOTEXTILE SAND FILTER TYPE B (6SF/FT) ARE PROPOSED
REQUIRED LENGTH OF ELJEN TRENCH: 56 FEET (MINIMUM)

PROPOSED CONFIGURATION – (2) 60' LONG TRENCHES (TOTAL OF 120')

REPLACEMENT/EXPANSION AREA
THE SITE HAS ADEQUATE ROOM FOR 100% SYSTEM EXPANSION/REPLACEMENT.

DOSING SYSTEM
DOSING IS NOT REQUIRED SINCE ABSORPTION FIELD IS LESS THAN 500 LF

DISTRIBUTION
GRAVITY FLOW FROM BUILDING TO SEPTIC TANK
GRAVITY FLOW FROM SEPTIC TANK TO DISTRIBUTION BOX THEN
GRAVITY FLOW FROM DISTRIBUTION BOX TO ABSORPTION TRENCHES

SEPARATION REQUIREMENTS
MINIMUM SEPARATION DISTANCES FROM THE ABSORPTION FIELD.
1. 100 FEET FROM ALL GROUNDWATER WELLS LOCATED UPHILL OF THE SYSTEM
2. 200 FEET FROM ALL GROUNDWATER WELLS LOCATED DOWNHILL OF THE SYSTEM
3. 20 FEET FROM ALL HOUSES\BUILDINGS
4. 10 FEET FROM ALL PROPERTY LINES
5. 20 FEET FROM DRAINAGE DITCHES
6. 100 FEET FROM ANY SURFACE WATER (PONDS, STREAMS, ETC.)
7. ANY DRAINAGE TILE FOUND WITHIN 30' OF THE ON-SITE WASTEWATER TREATMENT SYSTEM SHALL BE REROUTED.
MINIMUM SEPARATION DISTANCES FROM THE SEPTIC TANK.
1. 50 FEET FROM ALL GROUNDWATER WELLS
2. 10 FEET FROM ALL HOUSES\BUILDINGS
3. 10 FEET FROM ALL PROPERTY LINES
4. 10 FEET FROM DRAINAGE DITCHES
5. 50 FEET FROM ANY SURFACE WATER (PONDS, STREAMS, ETC.)
ALL SEPARATION REQUIREMENTS SHALL BE CONFIRMED BY THE CONTRACTOR PRIOR TO CONSTRUCTION. IF SEPARATION REQUIREMENTS CAN NOT BE MET, CONTRACTOR SHALL NOTIFY MCCORMICK ENGINEERING PC AT (585) 721-7219 PRIOR TO CONSTRUCTION.

NOTES:
1. REFER TO PIPE SCHEDULE ON THIS DRAWING FOR DETAILS ON SIZE, TYPE AND SLOPE OF PROPOSED PIPING.
2. CONTRACTOR SHALL CONFIRM ALL REQUIRED SETBACKS ARE MET PRIOR TO START OF CONSTRUCTION. ANY CONFLICTS SHALL BE REPORTED TO MCCORMICK ENGINEERING PC FOR RESOLUTION.
3. THE LOCATIONS OF THE SEPTIC TANK AND DISTRIBUTION DROP BOXES SHALL BE FIELD ADJUSTED AS REQUIRED TO MAINTAIN GRAVITY. MINIMUM SEPARATION REQUIREMENTS SHALL BE MAINTAINED.
4. NO HEAVY EQUIPMENT USE IN THE DESIGNATED ABSORPTION SYSTEM AREA IS ALLOWED TO PREVENT SOIL PERMEABILITY REDUCTION DUE TO COMPACTION AND POSSIBLE TRENCH CAVE-IN AND PIPE BREAKAGE.
5. DO NOT INSTALL GARBAGE GRINDERS ON WASTE LINES.
6. NON-WASTEWATER FLOWS (SUMPS, ROOF DRAINS, ETC) SHALL NOT BE ADDED TO THE SYSTEM.
7. ABSORPTION FIELD SHALL BE SEEDED AN MAINTAINED AS LAWN

INSPECTIONS
ALL INSTALLATIONS MUST BE INSPECTED AND APPROVED BY MCCORMICK ENGINEERING PC PRIOR TO USE. A MINIMUM OF 48 HOUR NOTICE IS REQUIRED TO SCHEDULE INSPECTIONS.

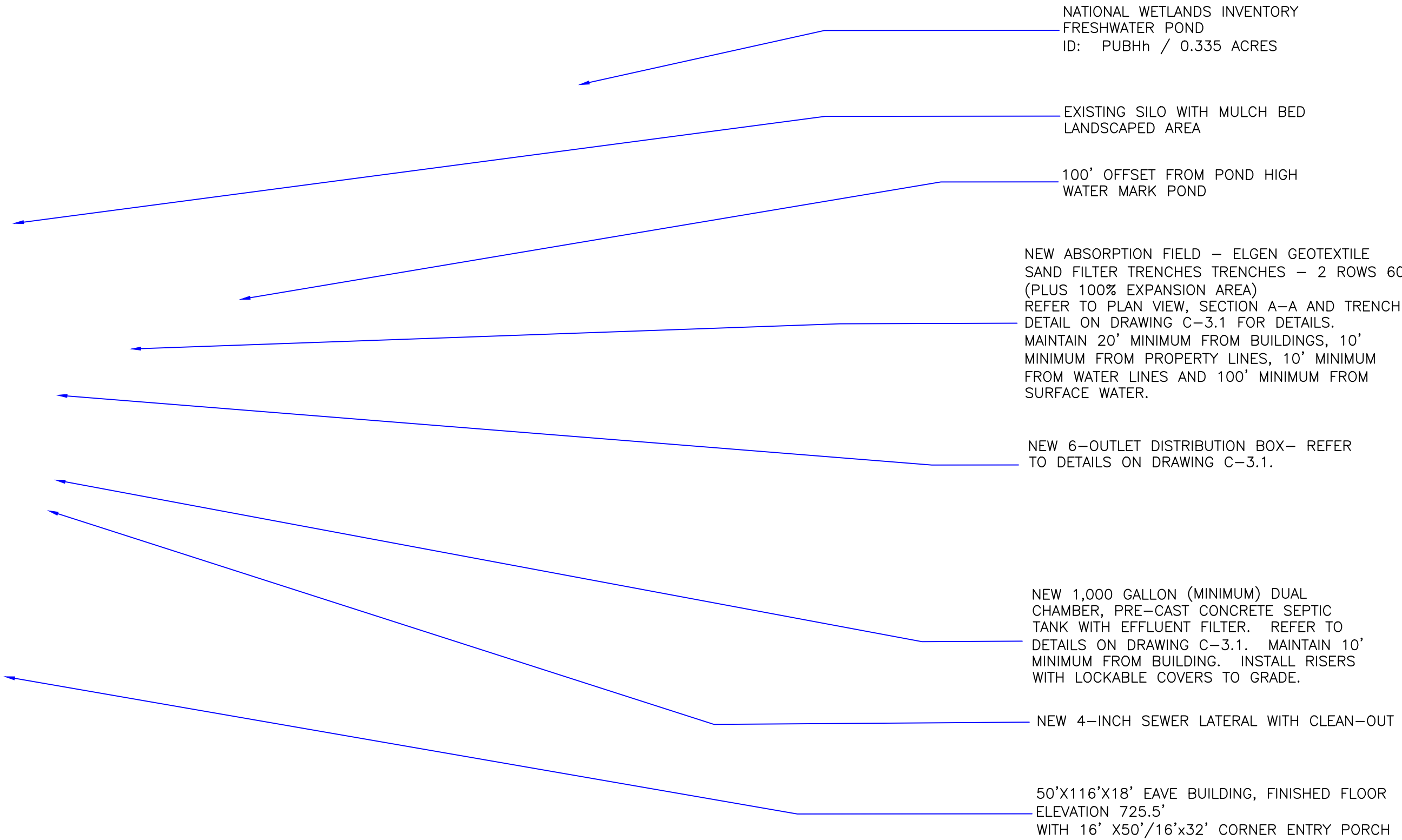

SITE PLAN

SCALE: 1" = 40'-0"

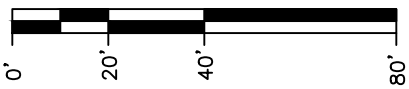

- NOTES:**
1. REFER TO PIPE SCHEDULE ON THIS DRAWING FOR DETAILS ON SIZE, TYPE AND SLOPE OF PROPOSED PIPING.
2. CONTRACTOR SHALL CONFIRM ALL REQUIRED SETBACKS ARE MET PRIOR TO START OF CONSTRUCTION.
ANY
CONFLICTS SHALL BE REPORTED TO MCCORMICK ENGINEERING PC FOR RESOLUTION.
3. NO HEAVY EQUIPMENT USE IN THE DESIGNATED ABSORPTION SYSTEM AREA IS ALLOWED TO PREVENT SOIL PERMEABILITY REDUCTION DUE TO COMPACTION AND POSSIBLE TRENCH CAVE-IN AND PIPE BREAKAGE.
4. DO NOT INSTALL GARBAGE GRINDERS ON WASTE LINES.
5. NON-WASTEWATER FLOWS (SUMPS, ROOF DRAINS, ETC) SHALL NOT BE ADDED TO THE SYSTEM.
6. ABSORPTION FIELD SHALL BE SEEDED AN MAINTAINED AS LAWN

WARNING
IT IS A VIOLATION OF SECTION 7209, SUBDIVISION 2, OF THE NEW YORK STATE EDUCATION LAW FOR ANY PERSON, OTHER THAN WHOSE SEAL APPEARS ON THIS DRAWING, TO ALTER IN ANY WAY AN ITEM ON THIS DRAWING. IF AN ITEM IS ALTERED, THE ALTERING ENGINEER SHALL AFFIX TO THE ITEM HIS SEAL AND THE NOTATION "ALTERED BY" FOLLOWED BY HIS SIGNATURE AND THE DATE OF SUCH ALTERATION, AND A SPECIFIC DESCRIPTION OF THE ALTERATION.

DRAWN BY: JTM

PROJ. ENGR.: JTM

PROJ. MNGR.: JTM

CHECKED BY: JTM

2 05/07/22

1 03/30/22

0 02/19/22

NO. DATE

REVISED PER MEETING WITH TOWN OF CANANDAIGUA

REVISED PER TOWN CHECK LISTS

FOR APPROVAL

DESCRIPTION

REVISIONS



CALL DIG SAFELY
NEW YORK
48 HOURS BEFORE
DIGGING OR
DRIVING POSTS
@ 811

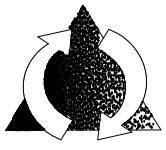
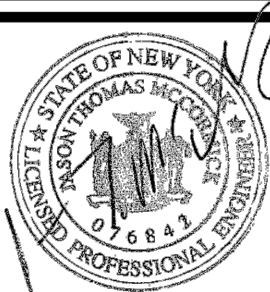

McCormick Engineering P.C.

294 Skuse Road
Geneva, New York 14456

(585) 721-7219

JOB No. 21-328

DIVERSIFIED EQUIPMENT, LLC
1947 STATE RTE 332
Canandaigua, New York
(T) Canandaigua, Ontario County
TAX ID No. 56.00-1-13.210

ON-SITE WASTEWATER TREATMENT
(SEPTIC) SYSTEM DETAILS
1 OF 2

Scale:
AS NOTED

Date: 05/22

DWG. C-3.0

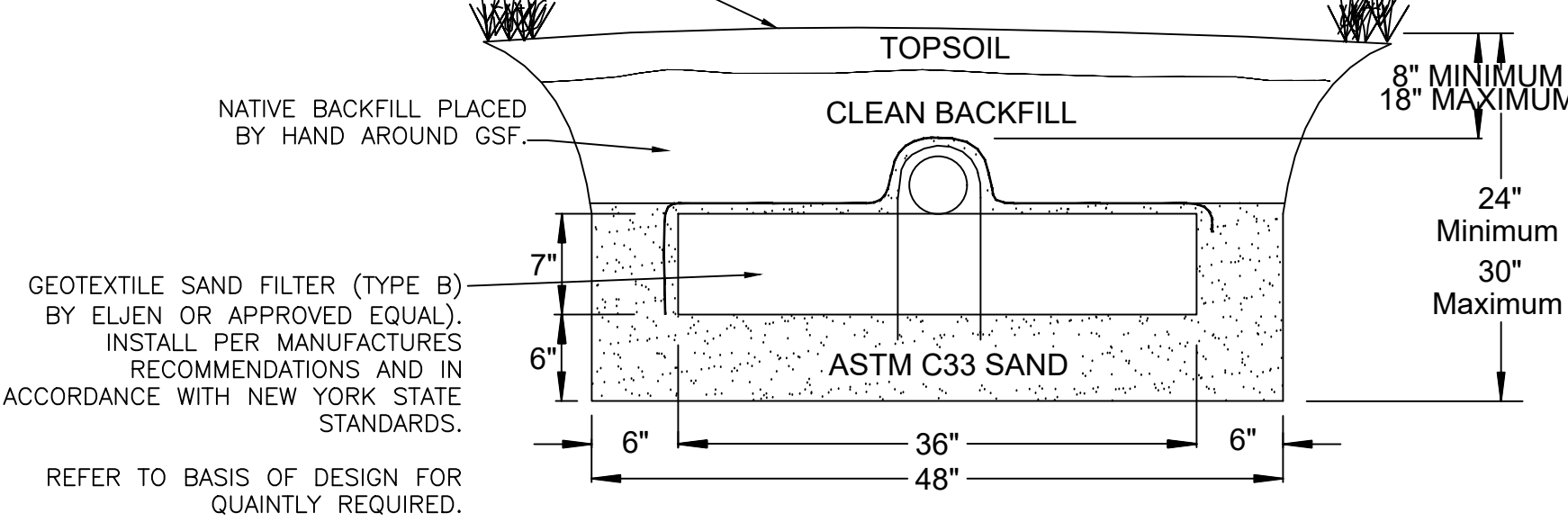
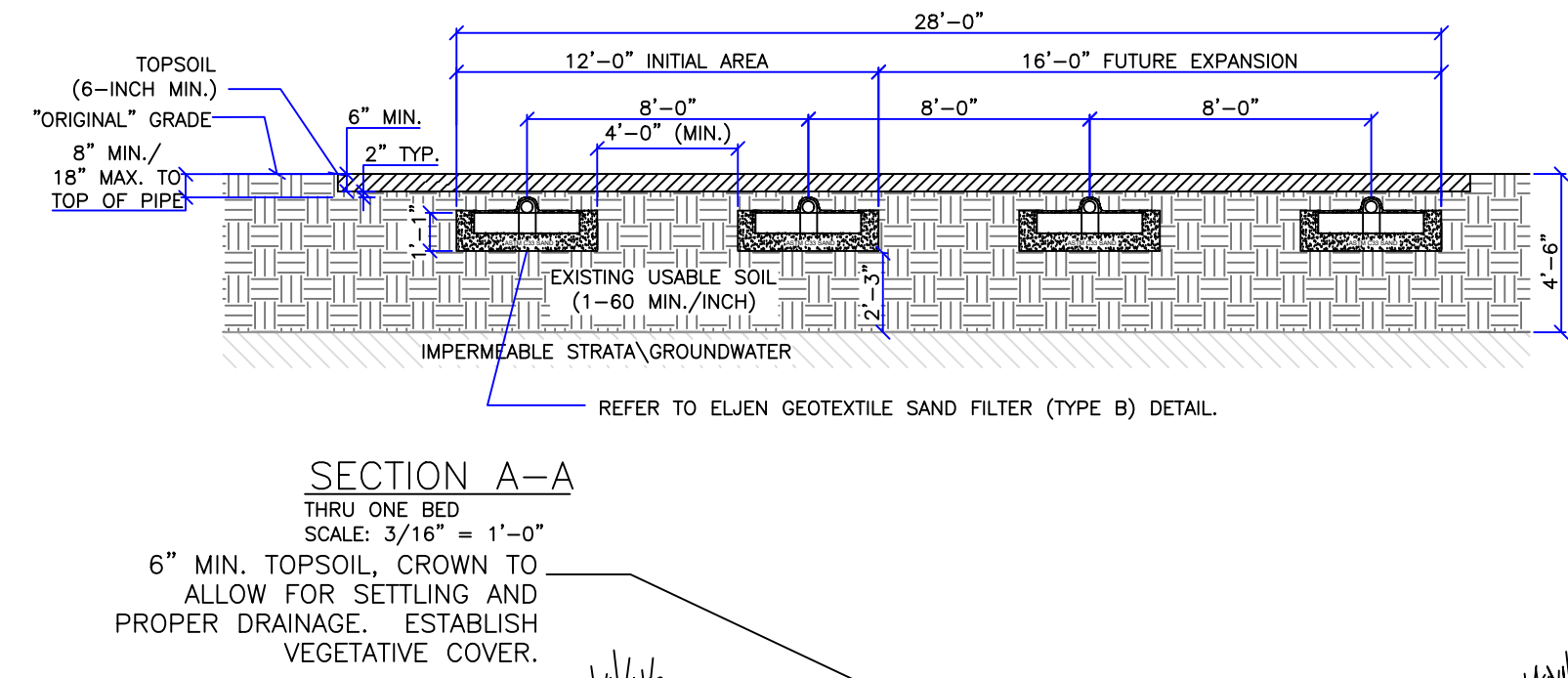
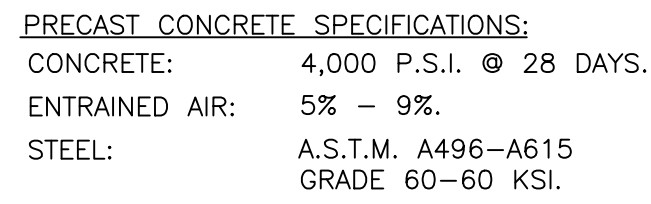
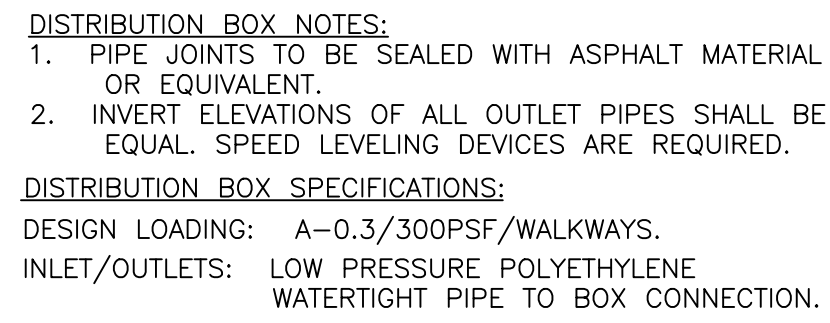
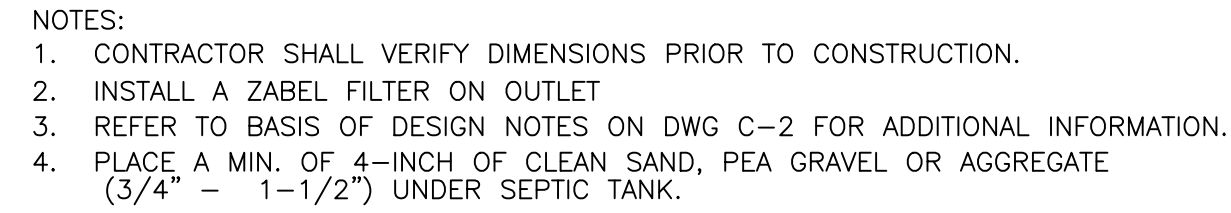
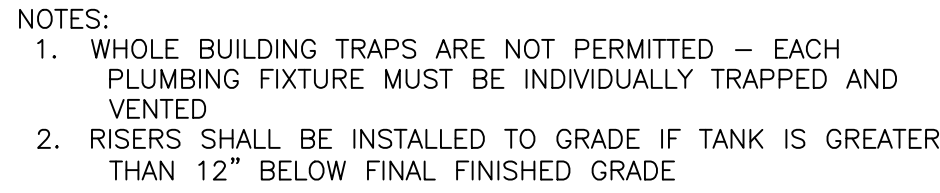
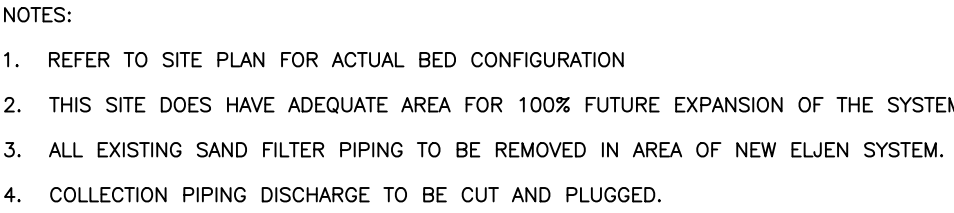
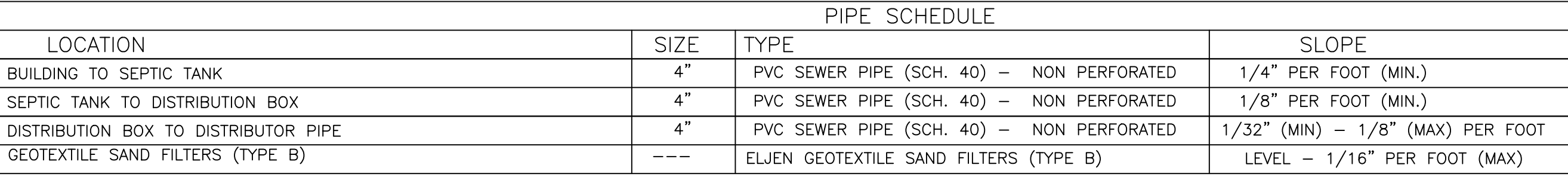

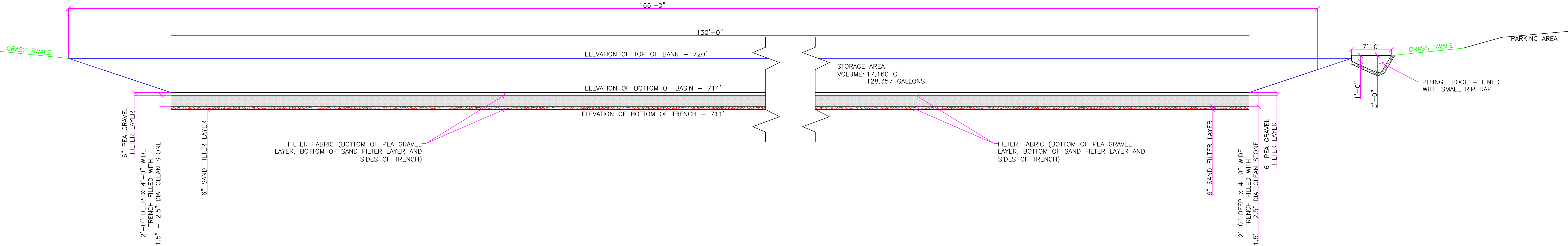

INFILTRATION TRENCH
SCALE: 1/8" = 1'-0"

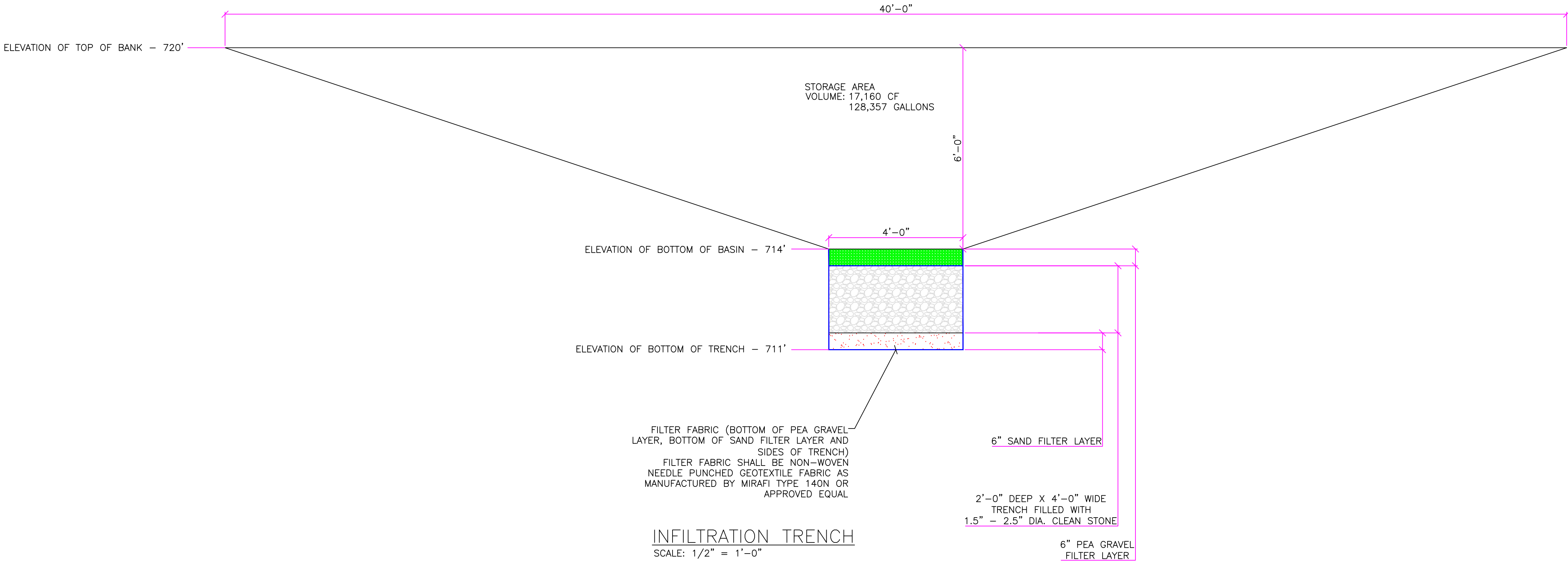

INFILTRATION TRENCH
SCALE: 1/2" = 1'-0"

WARNING
IT IS A VIOLATION OF SECTION 7209, SUBDIVISION 2, OF THE NEW YORK STATE EDUCATION LAW FOR ANY PERSON, OTHER THAN WHOSE SEAL APPEARS ON THIS DRAWING, TO ALTER IN ANY WAY AN ITEM ON THIS DRAWING. IF AN ITEM IS ALTERED, THE ALTERING ENGINEER SHALL AFFIX TO THE ITEM HIS SEAL AND THE NOTATION "ALTERED BY" FOLLOWED BY HIS SIGNATURE AND THE DATE OF SUCH ALTERATION, AND A SPECIFIC DESCRIPTION OF THE ALTERATION.

DRAWN BY:	JTM			
PROJ. ENGR.:	JTM	2	05/07/22	REVISED PER MEETING WITH TOWN OF CANANDAIGUA
PROJ. MNGR.:	JTM	1	03/30/22	REVISED PER TOWN CHECK LISTS
CHECKED BY:	JTM	0	02/19/22	FOR APPROVAL
		NO.	DATE	DESCRIPTION
				REVISIONS



CALL 811
before you dig

CALL DIG SAFELY
NEW YORK
48 HOURS BEFORE
DIGGING OR
DRIVING POSTS
@ 811

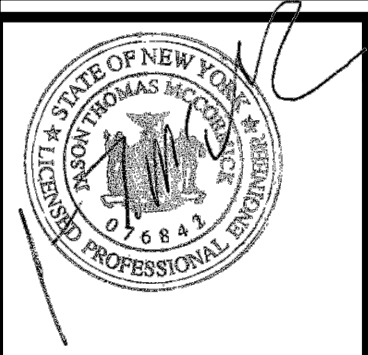



McCormick Engineering P.C.

294 Skuse Road
Geneva, New York 14456

(585) 721-7219

JOB No. 21-328

DIVERSIFIED EQUIPMENT, LLC
1947 STATE RTE 332
Canandaigua, New York
(T) Canandaigua, Ontario County
TAX ID No. 56.00-1-13.210

STORMWATER MANAGEMENT DETAILS

Scale:	Date: 05/22	DWG. C-4.0
AS NOTED		

MINOR COMMERCIAL DRIVEWAY

NYSDOT STANDARD GENERAL PLAN NOTES

- Road to be kept clean of mud and debris at all times.
- Road side drainage to be maintained at all times.
- Materials, equipment and vehicles are not to be stored or parked within the New York State Right-of-Way.
- Maintenance and Protection of Traffic must comply with the NYS Department of Transportation Manual of Uniform Traffic Control Devices (MUTCD), Section 619 of the current NYSDOT Standard Specifications, these plans and as ordered by the Resident Engineer. On a NYSDOT Construction Project, Maintenance and protection of Traffic must comply with these plans and be in accordance with the NYSDOT Contract Documents as deemed necessary by the NYS Engineer-in-Charge.
- Notify the NYS Department of Transportation Resident Engineer three (3) working days prior to commencement of work in the NYS right-of-way.
- Notify DIG SAFELY NEW YORK (UFPO) two (2) working days prior to digging, drilling or blasting at 811 for a utility stake-out.
- All materials used within the NYS Right-of-Way must comply with the current NYS Department of Transportation Specifications Book along with any appropriate current NYS Department of Transportation Standard Sheets.
- Quality control of asphalt concrete shall meet the requirements of Section 401 of the Standard Specifications. All asphalt produced as part of Section 401 will be paid at the final quality adjustment factor of 1.0. Asphalt course depths shown on the plans are compacted depths.
- No night work shall be allowed unless approved prior to the start of the project. Additional Maintenance and Protection of Traffic may be required including the addition of reflective materials and lighting.
- Hazardous Waste Notification – The Permittee accepts the Right-of-Way of the State Highway in its "AS-IS" condition. The Department of Transportation makes no representation as to the absence of Underground tanks, structures, features or similar impediments to the completion of the work permitted hereunder. Should the Permittee find some previously unknown underground impediments to its work, the Department of Transportation shall have no obligation to cure, remove, remedy or otherwise deal with such previously unknown underground impediments. The Department will permit the Permittee to remove, modify or otherwise deal with such underground tanks, structures, features or similar impediment if such is done in a manner which meets acceptable engineering practice and is pre-approved by the Department of Transportation. Should the Permittee determine that such unforeseen underground impediment renders Permittee's work as authorized by this permit unfeasible, Permittee shall have the option of restoring the highway to its original condition and not performing such work.

NYSDOT REGION 4 WORK ZONE TRAFFIC CONTROL NOTES

- REFER TO THE NYSDOT REGION4 TRAFFIC CONTROL NOTES ON PAGES 1 –10 ATTACHED AFTER DESIGN DRAWINGS.

Work shall be in compliance with the following NYSDOT Standard Sheets & Specifications:

NYSDOT Standard Sheet 619–10 Work Zone Traffic Control General Notes
NYSDOT Standard Sheet 619–11 Work Zone Traffic Control Legends and Notes
NYSDOT Standard Sheet 619–12 Sign Table (Total of 2 Sheets)
NYSDOT Standard Sheet 619–20 Shoulder Closure, 2–Lane 2–Way Roadway
NYSDOT Standard Sheet 619–60 Flagging Operation, 2–Lane 2–Way Roadway
NYSDOT Specification 610.10000015 Landscape Development
NYSDOT Specification 619 Pavement Edge Drop–Off Protection

NOTES:

- THESE DRAWINGS ARE FOR AN ENTRANCE PERMIT, ANY ASSOCIATED UTILITY WORK WITHIN THE NYS ROW WILL REQUIRE A SEPARATE SUBMISSION WITH RELEVANT DETAILS AND SEPARATE UTILITY PERMITS.
- ANY DAMAGE CAUSED DIRECTLY OR INDIRECTLY BY CONTRACTOR'S OPERATIONS WITHIN THE NYS ROW SHALL BE REPAIRED TO MEET NYSDOT STANDARDS AT THE CONTRACTOR'S EXPENSE.
- NYSDOT OPERATIONS TAKE PRECEDENCE OVER HIGHWAY WORK PERMIT OPERATIONS. CONTRACTOR SHALL NOT HAVE WORK OPERATIONS IN PAVEMENT DURING INCLEMENT WEATHER CONDITIONS OR DURING SNOW AND ICE REMOVAL OPERATIONS ON STATE HIGHWAYS.

DESIGN DATA	
DESIGN SPEED	55 MPH
CORNER ANGLE (DRIVEWAY)	90°
DRIVEWAY WIDTH	25'
CORNER RADIUS	33'
SITE DISTANCE	1,330' SOUTH (RIGHT TURN)
	SITE DISTANCE TO NORTH NOT REQUIRED NO LEFT (SOUTH) TURNS FROM SITE ALLOWED DIVIDED HIGHWAY

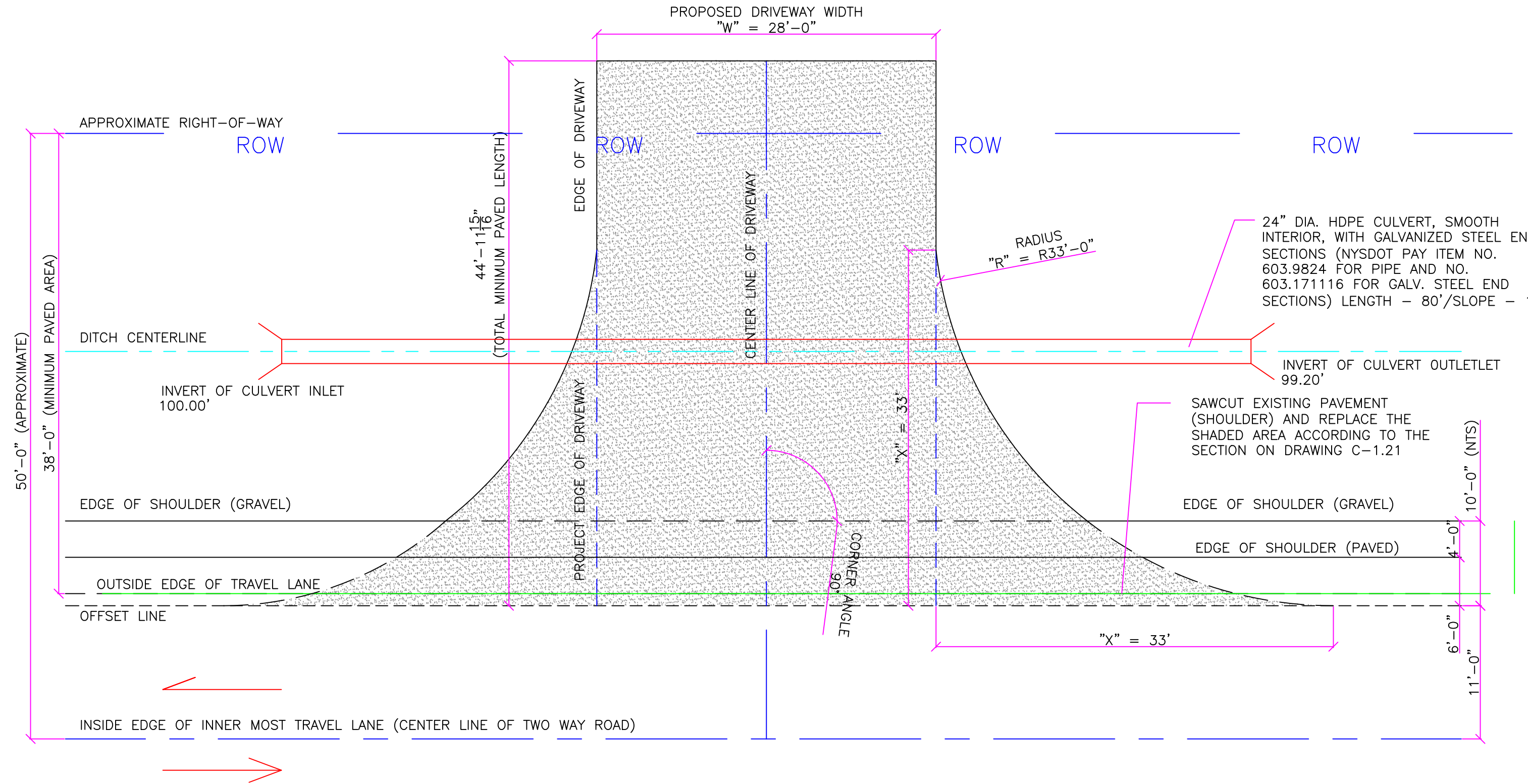
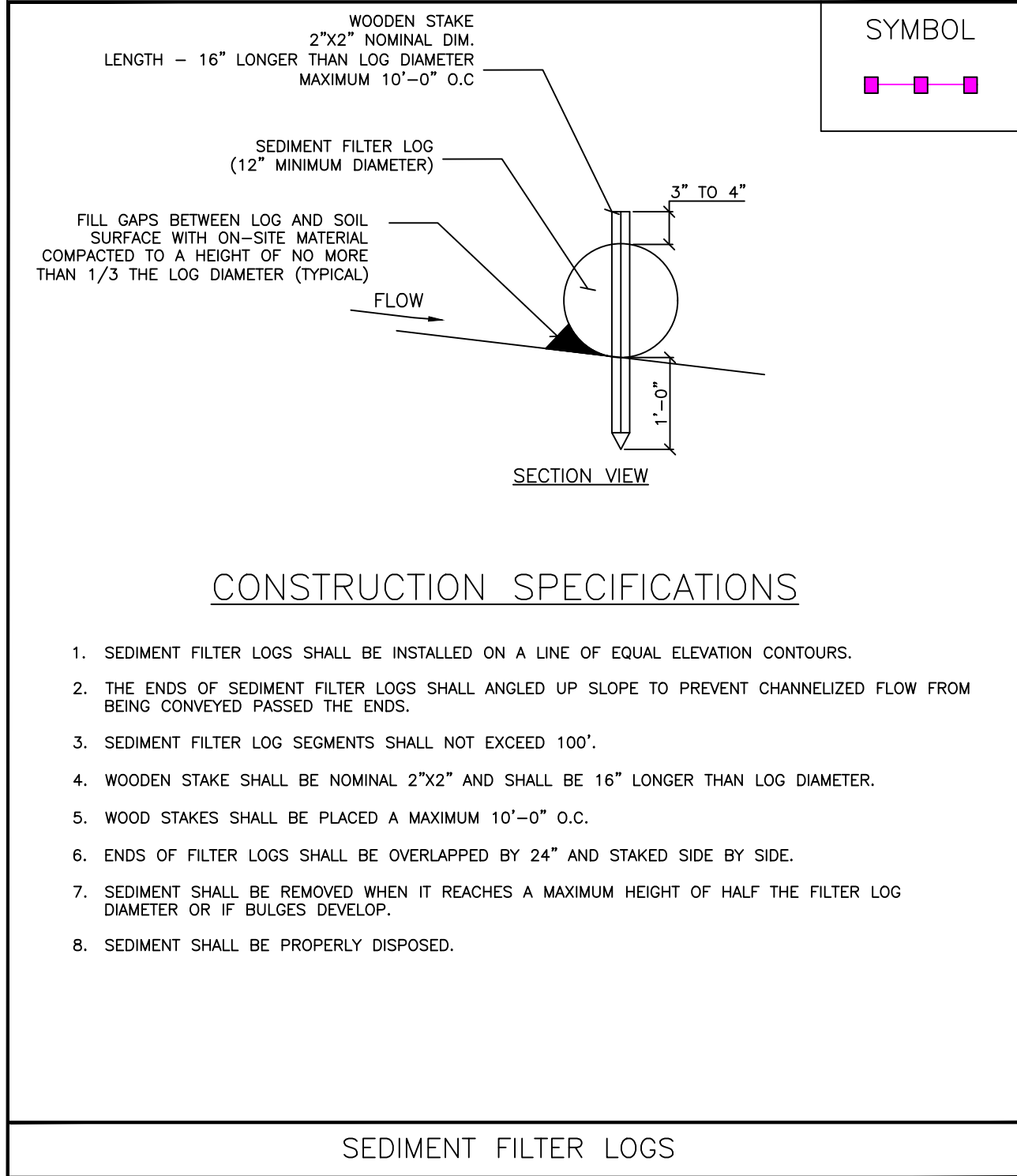

PROPOSED DRIVEWAY DETAIL

SCALE: 1/8" = 1'-0"

EROSION & SEDIMENTATION CONTROL SEQUENCING SCHEDULE

- ESTABLISH THE LIMIT OF DISTURBANCE FOR THE PROPOSED SITE CLEARING AND GRADING.
- DELINEATE AND PROTECT EXISTING TREES AND VEGETATION TO BE PRESERVED.
- INSTALL THE STABILIZED CONSTRUCTION ENTRANCE.
- ESTABLISH THE LOCATION FOR THE EROSION AND SEDIMENTATION CONTROL MEASURES – PREPARE AREA FOR THERE INSTALLATION.
- INSTALL SILT FENCE AS REQUIRED IN THE EROSION CONTROL PLAN (SITE PLAN DRAWING).
- BEGIN CLEARING AND GRADING FOR CONSTRUCTION AT THE SITE.
- STOCKPILE TOPSOIL IN ACCORDANCE WITH THE EROSION CONTROL PLAN.
- COMPLETE FINAL PAVING (DRIVEWAY/PARKING) AS REQUIRED.
- INSTALL PROPOSED PLANTINGS (GRASS ONLY)
- WHEN ALL DISTURBED AREAS ARE STABLE AND UPON APPROVAL FROM THE TOWN, REMOVE ALL TEMPORARY EROSION AND SEDIMENTATION CONTROL MEASURES.

NOTE: LESS THAN 1/2 ACRE WILL BE DISTURBED FOR THIS PROJECT

Vegetative Requirements

- Site Preparation
 - Install needed water & erosion control measures and bring area to be seeded to desired grades using a min. of 4" topsoil.
 - Prepare seedbed by loosening soil to depth of 4–6 inches.
 - Lime to a pH of 6.5
 - Fertilize as per soil test or, if fertilizer must be applied before soil test results are received, apply 850 pounds of 5–10–10 or equivalent per acre (20 lbs/1,000 sq. ft.)
 - Incorporate lime and fertilizer in top 2–4 inches of topsoil.
 - Smooth. Remove all stones over 1 inch in diameter, sticks, and foreign matter from the surface. Firm the seedbed.
- Planting–Sunny Location
Use a cultipacker type seeder if possible. Seed to a depth of 1/8 to 1/4 inch. If seed is to be broadcast, cultipack or roll after seeding. If hydroseeded, lime and fertilizer may be applied through the seeder and rolling is not practical. Seed using the following mix and rates:

Species (% by weight)	lbs/1,000sq ft	lbs/acre
65% Kentucky bluegrass blend	2.0–2.6	85–114
20% perennial ryegrass	0.6–0.8	26–35
15% fine fescue	0.4–0.6	19–26
Total	3.0–4.0	130–175

Or

100% Tall fescue, Turf–type, fine leaf	3.4–4.6	150–200
--	---------	---------
- When using the cultipacker or broadcast seed method, mulch using small grain straw, applied at a rate of 2 tons per acre; and anchor with a netting or tackifier. Hydroseed applications should include mulch, fertilizer and seed.
Common white clover can be added to mixtures at the rate of 1–2 lbs/acre to help maintain green color during the dry summer period, however, they will not withstand heavy traffic. Fertilizing – First year, (spring seedlings) three to four weeks after germination apply 1 pound nitrogen/1,000 square feet using a complete fertilizer with a 2–1–1 or 4–1–3 ratio or as recommended by soil test results. For summer and early fall seedlings, apply as above unless air temperatures are above 85 degrees for extended period. Wait until heat wave is over to fertilize. For late fall/ winter seedlings, fertilize in spring. Restrict use – new seedlings should be protected from use for one full year to allow development of a dense sod with good root structure.

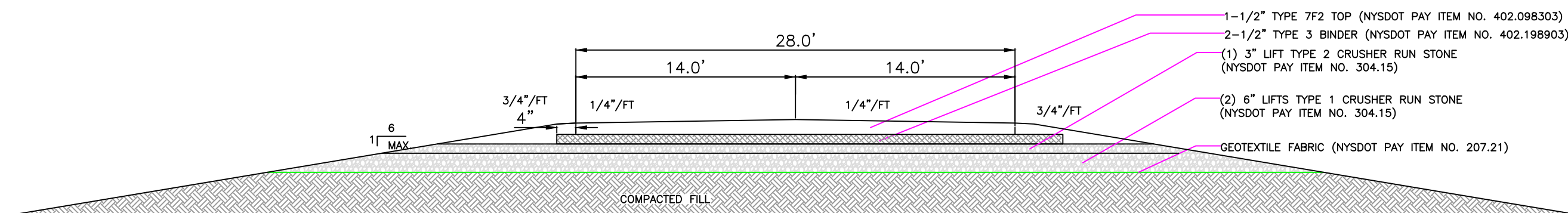

PROPOSED CROSS SECTION

NOT TO SCALE

SAW CUT EXISTING SHOULDER ALONG PROPOSED DRIVEWAY OPENING (NYSDOT PAY ITEM NO. 520.09000010)
CONSTRUCT DRIVEWAY IN ACCORDANCE WITH THE PROPOSED SECTION WITH NYSDOT PAY ITEMS LISTED
REGRADE OR PLACE ALL DISTURBED TOPSOIL IN RIGHT-OF-WAY (NYSDOT PAY ITEM NO. 610.1403)
ESTABLISH TURF WITHIN RIGHT-OF-WAY (NYSDOT PAY ITEM NO. 610.1601)
SIDEWALKS, CURBING AND ROAD STRIPPING ARE NOT PROPOSED FOR THIS PROJECT.

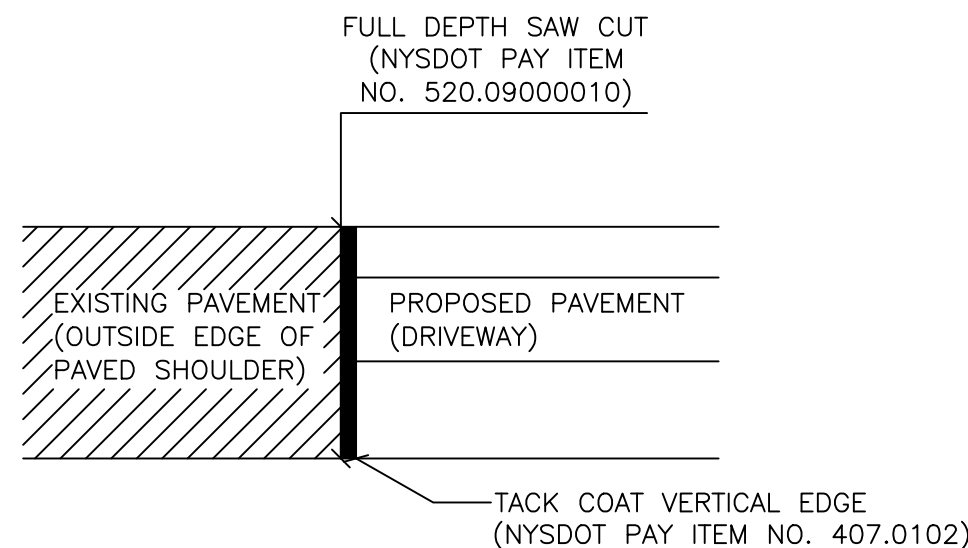

NOT TO SCALE

DESIGN RESPONSIBILITY NOTE:

MCCORMICK ENGINEERING PC IS RESPONSIBLE FOR THE DESIGN OF THIS PROJECT. JASON T. MCCORMICK, PE IS THE DESIGNER AND IS FAMILIAR WITH NEW YORK STATE DEPARTMENT OF TRANSPORTATION (NYSDOT) STANDARDS AND REQUIREMENTS AND SHALL BE CONTACTED AT (585) 721–7219 TO RESOLVE ANY ISSUES OR PROBLEMS DURING CONSTRUCTION. ALL REVISIONS, INCLUDING REVISIONS NECESSARY DUE TO FIELD CONDITIONS, SHALL BE APPROVED BY THE NYSDOT.

WARNING
IT IS A VIOLATION OF SECTION 7209, SUBDIVISION 2, OF THE NEW YORK STATE EDUCATION LAW FOR ANY PERSON, OTHER THAN WHOSE SEAL APPEARS ON THIS DRAWING, TO ALTER IN ANY WAY AN ITEM ON THIS DRAWING. IF AN ITEM IS ALTERED, THE ALTERING ENGINEER SHALL AFFIX TO THE ITEM HIS SEAL AND THE NOTATION "ALTERED BY" FOLLOWED BY HIS SIGNATURE AND THE DATE OF SUCH ALTERATION, AND A SPECIFIC DESCRIPTION OF THE ALTERATION.

DRAWN BY: JTM
PROJ. ENGR.: JTM
PROJ. MNGR.: JTM
CHECKED BY: JTM

NO.	DATE	REVISIONS
2	05/07/22	REVISED PER MEETING WITH TOWN OF CANANDAIGUA
1	03/30/22	REVISED PER TOWN CHECK LISTS
0	02/19/22	FOR APPROVAL
NO.	DATE	DESCRIPTION

Call 811
before you dig

CALL DIG SAFELY
NEW YORK
48 HOURS BEFORE
DIGGING OR
DRIVING POSTS
@ 811

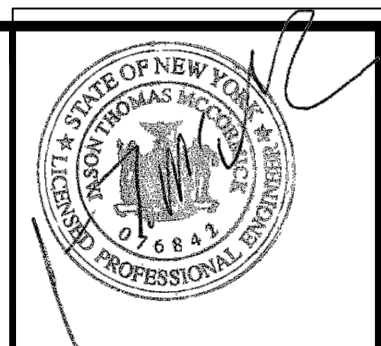

McCormick Engineering P.C.
294 Skuse Road
Geneva, New York 14456
(585) 721–7219

JOB No. 21–328

DIVERSIFIED EQUIPMENT, LLC
1947 STATE RTE 332
Canandaigua, New York
(T) Canandaigua, Ontario County
TAX ID No. 56.00-1-13.210

DRIVEWAY DETAILS

Scale: AS NOTED
Date: 05/22
DWG. C–5.0

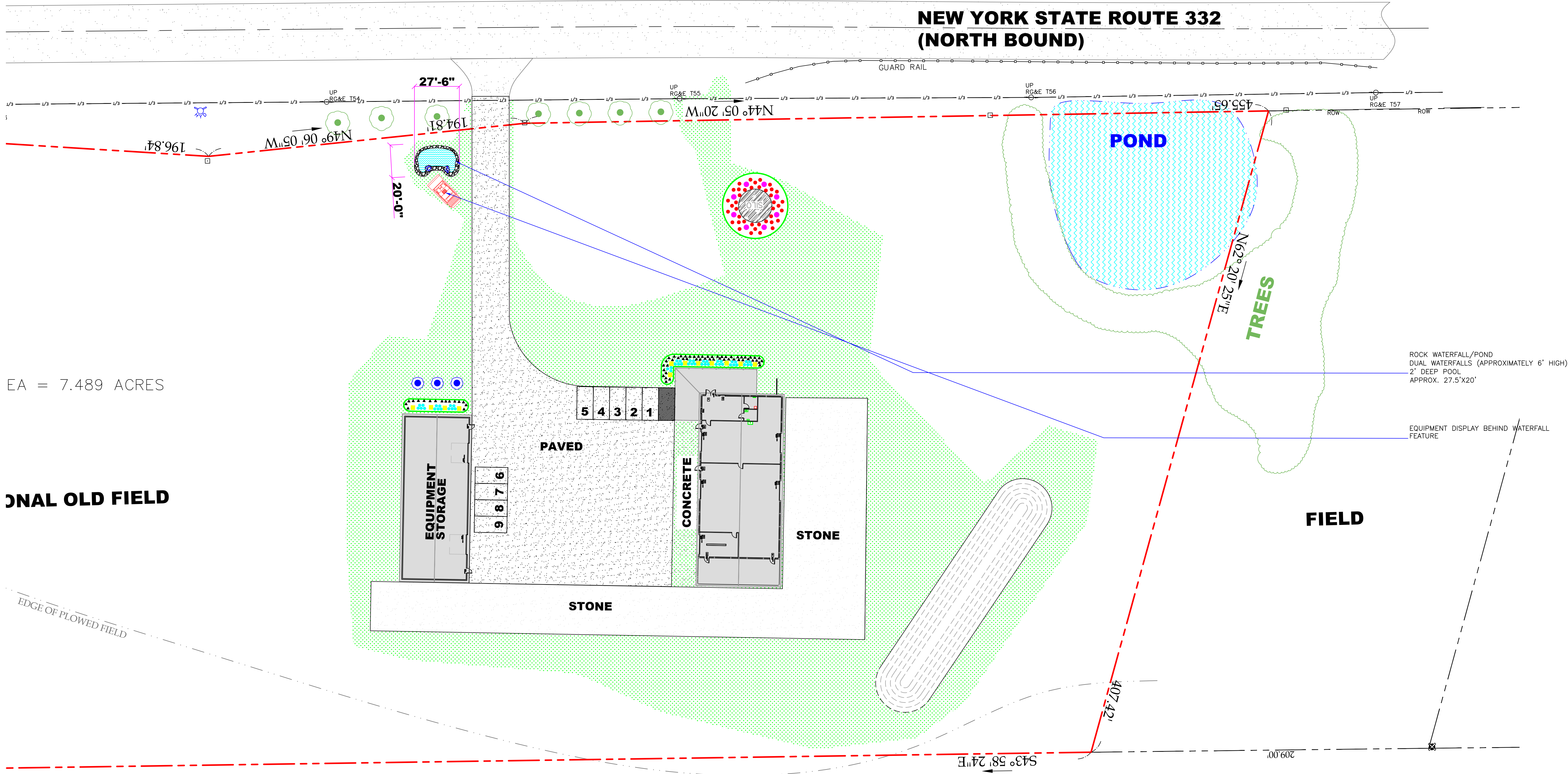

EA = 7.489 ACRES

DUAL OLD FIELD

SITE PLAN

SCALE: 1" = 30'-0"

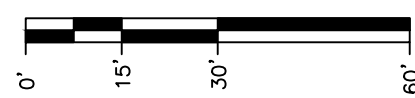

LEGEND

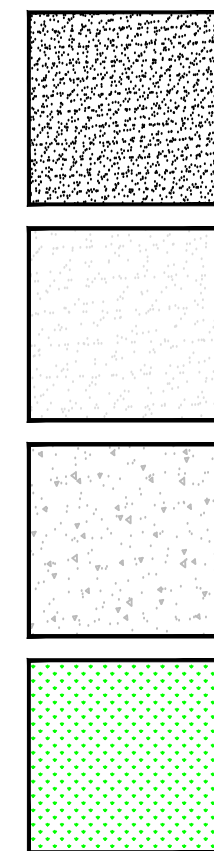

PROPOSED ASPHALT PAVEMENT
PROPOSED GRAVEL YARD/DRIVE
PROPOSED CONCRETE APRON
PROPOSED LAWN AREA

DESCRIPTION	ESTIMATED QTY
DAYLILLY STELLO D'OVO, #1 CONT	66
WALKER'S LA CATMINT, #1 CONT	48
SUMMER SAVANNAH VIBURNUM, 24"	12
SUNFLOWERS	
ROSE OF SHARON, 4'-5'	8
SHADBLOW SERVICEBERRY TREE 2.5" DIA	3
EXISTING MAPLE TREES (IN DOT ROW)	7

WARNING

IT IS A VIOLATION OF SECTION 7209, SUBDIVISION 2, OF THE NEW YORK STATE EDUCATION LAW FOR ANY PERSON, OTHER THAN WHOSE SEAL APPEARS ON THIS DRAWING, TO ALTER IN ANY WAY AN ITEM ON THIS DRAWING. IF AN ITEM IS ALTERED, THE ALTERING ENGINEER SHALL AFFIX TO THE ITEM HIS SEAL AND THE NOTATION "ALTERED BY" FOLLOWED BY HIS SIGNATURE AND THE DATE OF SUCH ALTERATION, AND A SPECIFIC DESCRIPTION OF THE ALTERATION.

DRAWN BY: JTM

PROJ. ENGR.: JTM

PROJ. MNGR.: JTM

CHECKED BY: JTM

2 05/07/22 REVISED PER MEETING WITH TOWN OF CANANDAIGUA

1 03/30/22 REVISED PER TOWN CHECK LISTS

0 02/19/22 FOR APPROVAL

NO. DATE DESCRIPTION

REVISIONS

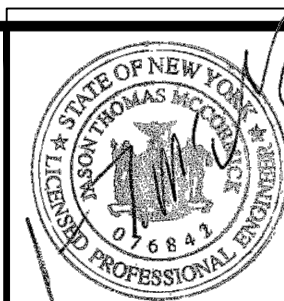

McCormick Engineering P.C.

294 Skuse Road
Geneva, New York 14456

(585) 721-7219

JOB No. 21-328

DIVERSIFIED EQUIPMENT, LLC
1947 STATE RTE 332
Canandaigua, New York
(T) Canandaigua, Ontario County
TAX ID No. 56.00-1-13.210

LANDSCAPE PLAN

Scale:
AS NOTED

Date: 05/22

DWG. L-1.0

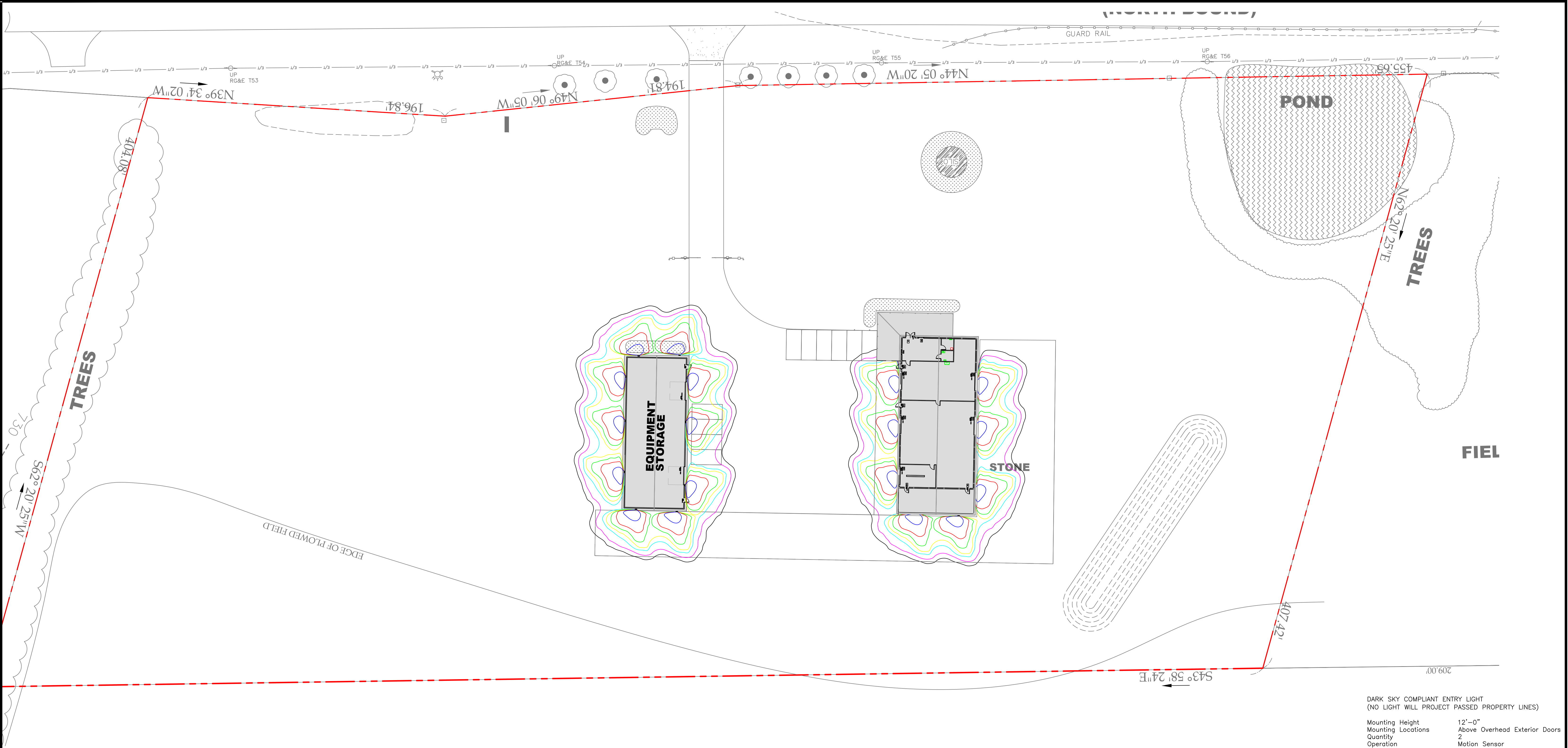

LEDGEND

PROPERTY LINE

0.31 FOOTCANDLES

1.62 FOOTCANDLES

2.24 FOOTCANDLES

2.85 FOOTCANDLES

4.08 FOOTCANDLES

7.15 FOOTCANDLES

9.78 FOOTCANDLES

DARK SKY COMPLIANT ENTRY LIGHT
(NO LIGHT WILL PROJECT PASSED PROPERTY LINES)

Mounting Height 12'-0"
Mounting Locations Above Overhead Exterior Doors
Quantity 2
Operation Motion Sensor

Fixture dimensions
Height (Inches) 7.125
Width (Inches) 16.375
Depth (Inches) 9.312

Maximum Fixture Wattage (Watts) 33
Light Fixture Material Aluminum
UL Safety Listing Yes
ENERGY STAR Qualified Yes
Light Bulb Base Type LED
Bulb Type LED
Number of Light Heads 1
Voltage (Volts) 120
Fixture Color Family Gray
Power Source Hardwired
Solar Powered No

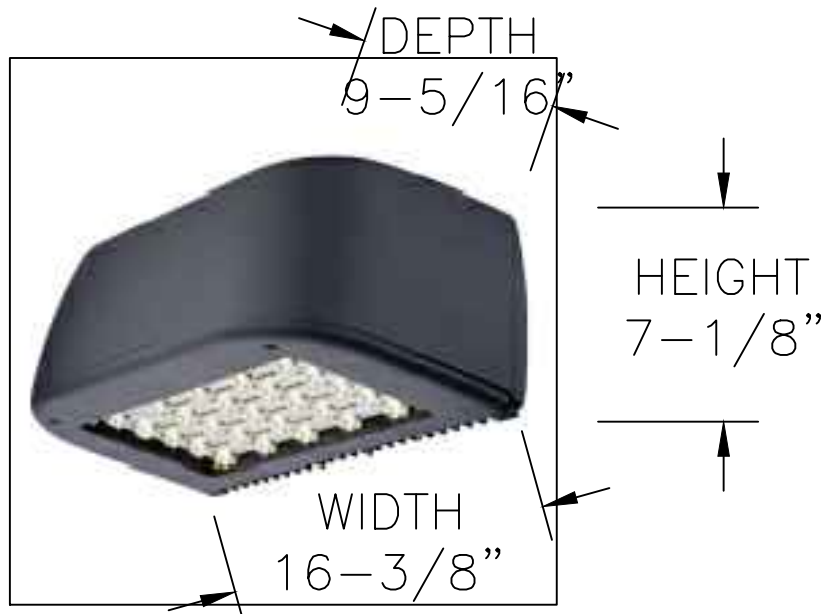

LIGHT DETAIL

NOT TO SCALE

SITE PLAN

SCALE: 1" = 30'-0"



WARNING
IT IS A VIOLATION OF SECTION 7209, SUBDIVISION 2, OF THE NEW YORK STATE EDUCATION LAW FOR ANY PERSON, OTHER THAN WHOSE SEAL APPEARS ON THIS DRAWING, TO ALTER IN ANY WAY AN ITEM ON THIS DRAWING. IF AN ITEM IS ALTERED, THE ALTERING ENGINEER SHALL AFFIX TO THE ITEM HIS SEAL AND THE NOTATION "ALTERED BY" FOLLOWED BY HIS SIGNATURE AND THE DATE OF SUCH ALTERATION, AND A SPECIFIC DESCRIPTION OF THE ALTERATION.

DRAWN BY: JTM

PROJ. ENGR.: JTM

PROJ. MNGR.: JTM

CHECKED BY: JTM

NO.	DATE	DESCRIPTION
2	05/07/22	REVISED PER MEETING WITH TOWN OF CANANDAIGUA
1	03/30/22	REVISED PER TOWN CHECK LISTS
0	02/19/22	FOR APPROVAL
REVISIONS		

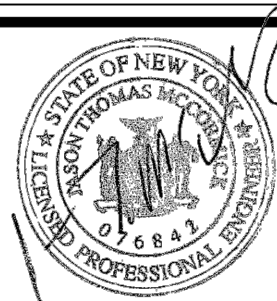

McCormick Engineering P.C.

294 Skuse Road
Geneva, New York 14456

(585) 721-7219

JOB No. 21-328

DIVERSIFIED EQUIPMENT, LLC
1947 STATE RTE 332
Canandaigua, New York
(T) Canandaigua, Ontario County
TAX ID No. 56.00-1-13.210

PHOTOMETRICS

Scale:
AS NOTED

Date: 05/22

DWG. L-1.0