



DATE	REVISIONS	
------	-----------	--



DRAWING ALTERATION

THE FOLLOWING IS AN EXCERPT FROM THE NEW YORK STATE EDUCATION LAW, ARTICLE 145, SECTION 7209 AND APPLIES TO THIS DRAWING

* IT IS A VIOLATION OF THIS LAW FOR ANY PERSON UNLESS HE IS ACTING UNDER THE DIRECTION OF A LICENSED ENGINEER OR LAND SURVEYOR TO ALTER AN ITEM IN ANY WAY. IF AN ITEM BEARING THE SEAL OF A LICENSED ENGINEER OR LAND SURVEYOR IS ALTERED, THE ALTERING ENGINEER OR LAND SURVEYOR SHALL AFFIX TO THE ITEM HIS SEAL AND THE NOTATION "ALTERED BY FOLLOWED BY HIS SIGNATURE AND THE DATE OF SUCH ALTERATION AND A SPECIFIC DESCRIPTION OF THE ALTERATION."

McMahon LaRue
Associates, P. C.

Engineers & Surveyors

822 Holt Road
Webster, NY 14580
(585) 436-1080

www.McMahon-LaRue.com

CLIENT:

MORGAN MANAGEMENT
1170 PITTSFORD-VICTOR RD.
SUITE 100
PITTSFORD, NY 14534

PROJECT:

CENTERPOINTE TOWNHOUSES

BRICKYARD AND THOMAS ROADS

DRAWING:

FINAL SUPPLEMENTAL WALK

PART OF TOWN LOT 103
TOWN OF CANANDAIGUA
ONTARIO COUNTY
STATE OF NEW YORK

DESIGNED BY:	GWM
DRAWN BY:	GWM
CHECKED BY:	AIL
S.B.L. #	56.00-01-29.111
PROJ. NO:	1279-00
DATE:	JULY 2016
SCALE:	1"=30'

1 SHEET OF 3

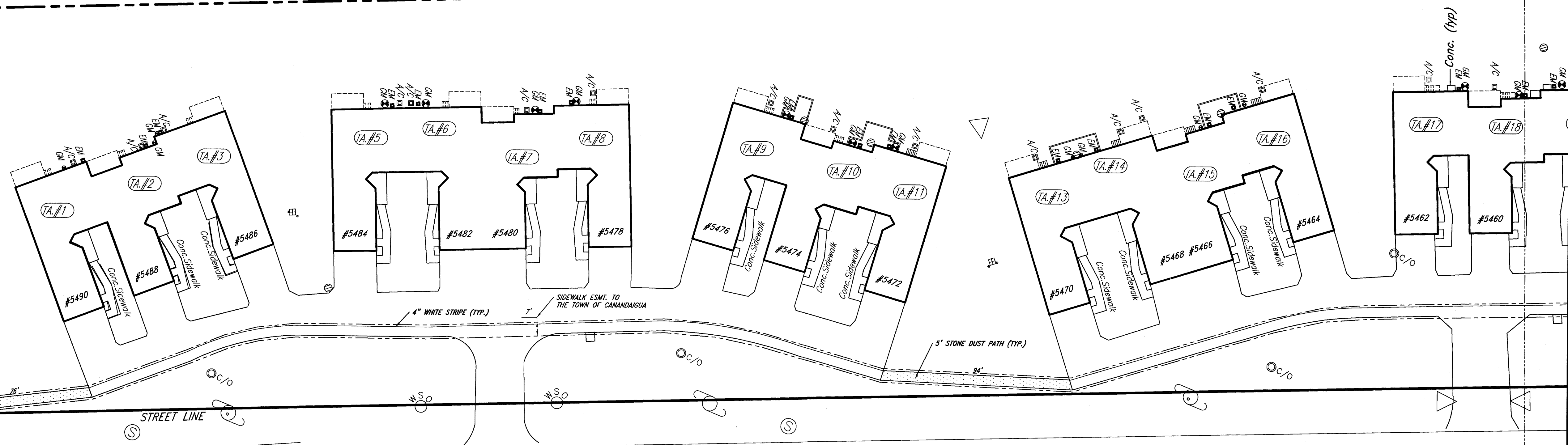

~~THOMAS (66' R.O.W) ROAD~~

PLANNING BOARD CHAIRMAN _____ DATE _____

TOWN ENGINEER _____ DATE _____

CANANDAIGUA FARMINGTON WATER DISTRICT DATE

CANANDAIGUA HIGHWAY SUPERINTENDENT _____ DATE _____

